

# AERA 3" FLEX CYLINDER

SURFACE  
DIRECT



The Aera 3" Flex Cylinder is adjustable, tilting upwards to 90 degrees and rotating 355 degrees. Mountable as a recessed, surface, pendant, or wall fixture, it brings to the Aera family added flexibility and more options to customize lighting effects.

## Mounting Options

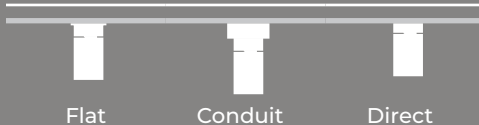

## Beam Angles



Low UGR < 10 in 15°, 25°, 35°, and 50° beams

## Performance

LUMEN OUTPUT <sup>1</sup>	WATTS	EFFICACY
1132 lm	10 W	113 lm/W
1545 lm	14 W	110 lm/W

<sup>1</sup>Lumen packages are assuming 3500K, 80+ CRI, 35° beam, bevel baffle, SDL lens option.

## Light Source

Static White  
Full Spectrum Static White  
SOLA - Dim-to-Warm  
DUO - Tunable White



## COB

2 Step Color Binning  
Up to 95+ CRI

## Driver

1%, 0.1% Dimming Available  
0-10V, TRIAC, ELV, Lutron EcoSystem, DALI, DMX  
Emergency Battery (optional)

## Aera Cylinder Family (Refer to other spec sheets) Cylinder



2" / 3" / 4" / 5"  
4" Seal  
Pendant  
Pendant Asymmetric  
Pendant Wall Wash



2" / 3" / 4" / 5"  
4" Seal  
Wall  
Wall Asymmetric



2" / 3" / 4" / 5"  
4" Seal  
Surface  
Surface Asymmetric  
Surface Wall Wash

## Inflex Cylinder



2" / 3" / 4"  
Pendant



2" / 3" / 4"  
Surface

## Flex Cylinder



3"  
Pendant



3"  
Recessed



3"  
Surface



3"  
Wall

# AERA 3" FLEX CYLINDER

SURFACE  
DIRECT



Project: \_\_\_\_\_

Type: \_\_\_\_\_

## Order Guide

LUMINAIRE ID <sup>1</sup>	DISTRIBUTION	CYLINDER HEIGHT <sup>2</sup>	CYLINDER FINISH	BAFFLE STYLE	BAFFLE FINISH
<b>AE3FXCYS</b>	<b>D</b>				
<b>AE3FXCYS</b> - Aera 3" Flex Cylinder Surface  <sup>1</sup> Pendant, Recessed, and Wall also available. Consult other spec sheets.	<b>D</b> - Direct	<b>4.5IN</b> - 4.5" <b>6IN</b> - 6"  <sup>2</sup> See page 3 for dimensions.	<b>FTMW</b> - Matte white <b>FTMB</b> - Matte black <b>FCHP</b> - Champagne <b>FDBZ</b> - Dark bronze <b>CF#</b> - Custom finish, specify RAL#	<b>BVL</b> - Bevel <b>PHL</b> - Pinhole <b>BVLD</b> - Decorative bevel	<b>FTMW</b> - Matte white <b>FTMB</b> - Matte black <b>FSPC</b> - Satin silver <b>FSSPC</b> - Matte silver <b>FCHP</b> - Champagne <b>FDBZ</b> - Dark bronze <b>CF#</b> - Custom finish, specify RAL#

LENS * See page 3 for details	LIGHT SOURCE	BEAM	COLOR QUALITY	CRI	COLOR TEMPERATURE	ACCESSORIES * See page 3 for details
<b>At baffle</b> (choose 1 option) Specify NOL for Pinhole	<b>SW</b> - Static white <b>FS</b> - Full spectrum static white	<b>15DEG</b> - 15° Narrow spot <b>25DEG</b> - 25° Spot <b>35DEG</b> - 35° Narrow flood <b>50DEG</b> - 50° Wide flood <b>80DEG</b> - 80° Very wide flood <b>90DEG</b> - 90° Open flood	<b>2STP</b> <sup>3</sup> - 2 Step MacAdam Ellipse <b>3STP</b> - 3 Step MacAdam Ellipse  <sup>3</sup> Not available with full spectrum.	<b>80CRI</b> <sup>4</sup> - 80+ CRI <b>90CRI</b> <sup>4</sup> - 90+ CRI <b>95CRI</b> - 95+ CRI	<b>24K</b> <sup>5</sup> - 2400K <b>27K</b> - 2700K <b>30K</b> - 3000K <b>35K</b> - 3500K <b>40K</b> - 4000K <b>50K</b> <sup>5</sup> - 5000K  <sup>5</sup> Not available with 95+ CRI.	<b>At light element</b> <sup>6,7</sup> (choose up to 2 options for SW/FS and 1 option for SOLA/DUO)  <b>LSDL</b> - Soft diffused lens, Solite <b>LFDL</b> - Frosted diffused lens <b>LS</b> - Linear spread <b>HEX</b> <sup>8</sup> - Hex louver <b>NA</b> - None  <sup>6</sup> Separate codes with a "+" if more than one is specified, e.g. LSDL+LS. <sup>7</sup> LSDL and LFDL cannot be combined. LS and HEX cannot be combined. <sup>8</sup> Not available with 80°/90° beam options.
<b>SDL</b> - Soft diffused lens, Solite <b>FDL</b> - Frosted diffused lens <b>CL</b> - Clear lens <b>NOL</b> - No lens	<b>SOLA</b> - Dim-to-warm single channel control <b>DUO</b> - Tunable white 2-channel control	<b>25DEG</b> - 25° Spot <b>35DEG</b> - 35° Narrow flood <b>60DEG</b> - 60° Wide flood <b>80DEG</b> - 80° Very wide flood <b>90DEG</b> - 90° Open flood	<b>3STP</b> - 3 Step MacAdam Ellipse	<b>90CRI</b> - 90+ CRI	<b>SOLA</b> <b>30K18K</b> - 3000K to 1800K <b>27K18K</b> - 2700K to 1800K  <b>DUO</b> <b>65K27K</b> - 6500K to 2700K <b>50K27K</b> - 5000K to 2700K	

\* LSDL or LFDL at light element cannot be combined with SDL, FDL, or CL at baffle.

VOLTAGE	WATTAGE <sup>10</sup>	DIMMING <sup>11</sup>	
<b>120V</b> - 120V <b>277V</b> - 277V <b>UNV</b> - 120V-277V <b>347V</b> <sup>9</sup> - 347V  <sup>9</sup> Available with RD1 driver only. Please consult factory.	<b>10W</b> - 10 W output, up to 1132 lm <b>14W</b> - 14 W output, up to 1545 lm  <sup>10</sup> Lumen outputs are reduced with full spectrum, consult factory.	<b>INTEGRAL</b> <sup>12</sup>  <b>D1</b> - 1% 0-10V <b>ELV</b> <sup>13</sup> - ELV 120V <b>TRI</b> <sup>13</sup> - TRIAC 120V	<b>REMOTE</b> <sup>14</sup>  <b>RD1</b> - 1% 0-10V <b>RELV</b> <sup>15</sup> - ELV 120V <b>RTRI</b> <sup>15</sup> - TRIAC 120V <b>RLDE1</b> <sup>15</sup> - Lutron Hi-lume 1% Eco  <b>RDA</b> <sup>15</sup> - DALI <b>RELD1</b> - eldoLED 1% ECOdrive 0-10V <b>RELDO</b> - eldoLED 0.1% SOLOdrive 0-10V <b>+EB</b> <sup>16</sup> - Emergency battery  <sup>11</sup> PoE (Power-over-Ethernet) compatible. Consult factory for details. <sup>12</sup> Not available with DMNC/DMRM canopy options. <sup>13</sup> Available with 120V only. <sup>14</sup> A remote driver box is provided. <sup>15</sup> On-site commissioning is required. <sup>16</sup> To specify, add +EB to the selected dimming option, e.g. RD1+EB.
	<b>SOLA</b> <b>14W</b> - 14 W output, up to 950 lm  <b>DUO</b> <b>10W</b> - 10 W output, up to 715 lm <b>14W</b> - 14 W output, up to 1005 lm	<b>SOLA</b> <b>SD1</b> - Single 0-10V input <b>SELV</b> <sup>13</sup> - ELV 120V <b>STRI</b> <sup>13</sup> - TRIAC 120V	<b>SOLA</b> <b>RSD1</b> - Single 0-10V input <b>RSELV</b> <sup>13</sup> - ELV 120V <b>RSTRI</b> <sup>13</sup> - TRIAC 120V  <b>DUO</b> <b>RDMX</b> <sup>15</sup> - DMX <b>RDDA</b> <sup>15</sup> - DALI DT6 <b>RDDA8</b> <sup>15</sup> - DALI DT8 <b>RDD1</b> - Dual 0-10V input for CCT/intensity <b>RLD2</b> <sup>15</sup> - Lutron DALI-2 digital <b>+EB</b> <sup>16</sup> - Emergency battery

CANOPY TYPE <sup>17</sup>	CANOPY FINISH Specify NA for DMNC and DMRM
<b>FLR</b> <sup>18</sup> - Flat round canopy, 4" octagonal junction box <b>CDR</b> <sup>19</sup> - Conduit feed, round canopy <b>DMNC</b> <sup>20</sup> - Direct mount, new construction <b>DMRM</b> <sup>20,21</sup> - Direct mount, remodel  <sup>17</sup> See page 4 for details. <sup>18</sup> Driver is housed in j-box when specified with integral drivers. <sup>19</sup> Driver is housed in canopy when specified with integral drivers. <sup>20</sup> Available with remote driver only. <sup>21</sup> Single wiring entry only. No daisy chain connections allowed.	<b>FTMW</b> - Matte white <b>FTMB</b> - Matte black <b>FCHP</b> - Champagne <b>FDBZ</b> - Dark bronze <b>CF#</b> - Custom finish, specify RAL# <b>NA</b> - Not applicable

# AERA 3" FLEX CYLINDER

SURFACE  
DIRECT



## Dimensions

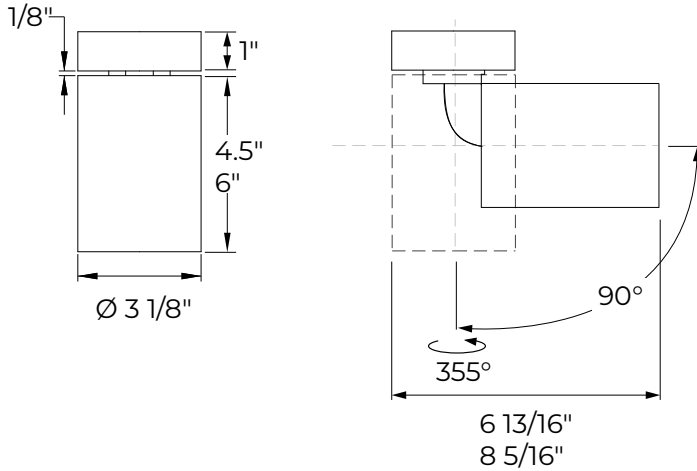

## Lens and Accessories

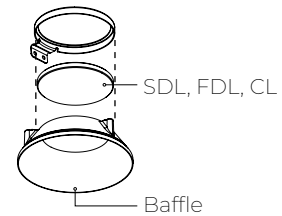
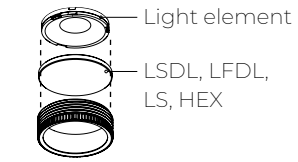

## BAFFLE

BVL Bevel	PHL Pinhole	BVLD Decorative bevel
<p>■ Baffle finish ■ Textured matte black</p>		
<p>20° Cut-off 56° Shielding</p>	<p>Optic 40° Cut-off</p>	<p>23° Cut-off 58° Shielding</p>

# AERA 3" FLEX CYLINDER

SURFACE  
DIRECT



## Mounting

### CANOPY

INTEGRAL DRIVER			REMOTE DRIVER			
Order code	<b>FLR</b> Flat round canopy, 4" octagonal junction box	<b>CDR</b> Conduit feed, round canopy	<b>FLR</b> Flat round canopy, 4" octagonal junction box	<b>CDR</b> Conduit feed, round canopy	<b>DMNC</b> Direct mount, new construction	<b>DMRM *</b> Direct mount, remodel
Canopy type						
Canopy size	Ø 4 1/2" Height 3/8"	Ø 5 1/2" Height 1 15/16"	Ø 4 1/2" Height 3/8"	Ø 5 1/2" Height 1 15/16"	NA	

\* Single wiring entry only. No daisy chain connections allowed.

# AERA 3" FLEX CYLINDER

SURFACE  
DIRECT



## Color Quality

COLOR QUALITY - 3500K	
TM-30 Rr	90
TM-30 Ra	100
CRI	90+
R9	> 50

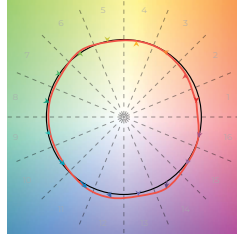

## Photometrics

Values calculated based on 3500K, bevel baffle, and SDL lens option.

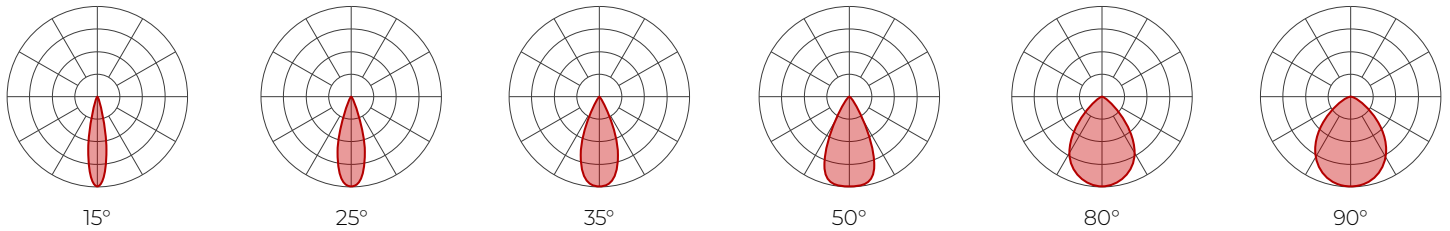

### Delivered lumens

CRI	90+ CRI						95+ CRI						80+ CRI					
	15°	25°	35°	50°	80°	90°	15°	25°	35°	50°	80°	90°	15°	25°	35°	50°	80°	90°
10 W	987	1053	1058	937	843	843	760	811	815	721	649	649	1056	1127	1132	1003	902	902
14 W	1347	1438	1444	1280	1152	1152	1037	1107	1112	986	887	887	1441	1539	1545	1370	1233	1233

### Efficacy

CRI	90+ CRI						95+ CRI						80+ CRI					
	15°	25°	35°	50°	80°	90°	15°	25°	35°	50°	80°	90°	15°	25°	35°	50°	80°	90°
10 W	99	105	106	94	84	84	76	81	81	72	65	65	106	113	113	100	90	90
14 W	96	103	103	91	82	82	74	79	79	70	63	63	103	110	110	98	88	88

### MULTIPLIERS

Please follow the multiplier tables to ensure correct lumen value. Beams, CCT, baffle styles, baffle colors, lensing and accessories will change the lumen value.

CCT		BAFFLE STYLE AND COLOR			LENS * (At baffle)		ACCESSORIES * (At light element)	
2400K	0.87	Bevel	White	1	SDL - Soft diffused lens, Solite	1	LSDL - Soft diffused lens, Solite	1
2700K	0.94		Black	1	FDL - Frosted diffused lens	0.8	LFDL - Frosted diffused lens	0.8
3000K	0.98	Pinhole	White	0.92	CL - Clear lens	1.1	LS - Linear spread	0.84
3500K	1		Black	0.92	NOL - No lens	1.1	HEX - Hex louver	0.86
4000K	1.05	Decorative bevel	White	1	* When more than one lens or accessory is specified, multiply together the value of each lens and/or accessory. e.g. NOL + LSDL + LS = 1.1 x 1 x 0.84 = 0.924			
5000K	1.05		Black	1				

For SOLA and DUO, please consult factory.

# AERA 3" FLEX CYLINDER

SURFACE  
DIRECT



## Technical Specifications

### OPTIC

XPoint™ Refraction Technology optics provide precise optical control in a remarkably compact form. Micro optical paths from the chip on board converge and then disperse in precise beam angles, resulting in a crisp and exacting light quality.

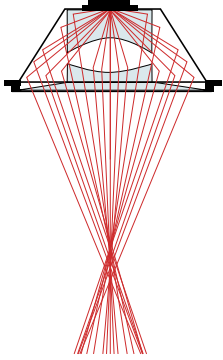

### LIGHT SOURCE

#### Static white

Compact COB (Chip-On-Board) LED module, available in 2400, 2700K, 3000K, 3500K, 4000K, and 5000K with a choice of 80+ CRI, 90+ CRI, or 95+ CRI, with elevated R9 value for 90+ CRI and above. Color consistency is maintained to within 2 SDCM. All LEDs have been tested in accordance with IESNA LM-80-08 and the results have shown L80 lumen maintenance greater than 60,000 hours. Absolute product photometry is measured and presented in accordance with IESNA LM-79, unless otherwise indicated.

#### Full spectrum static white

The full spectrum LED option offers improved color particularly in the cyan region that is beneficial in both healthcare and circadian lighting strategies. The cyan region in full spectrum LED is richer at the 480 nm range.

#### Chromawerx SOLA

Chromawerx SOLA is single-channel control that dims output while warming the color temperature in a pre-determined relationship. Two color temperature range options are offered: 3000K to 1800K, and 2700K to 1800K. A simple analog control adjusts a specially populated LED array to emulate the effect of dimming a filament source.

#### Chromawerx DUO

Chromawerx DUO offers a two-channel control system which uses analog or digital protocols for synchronous control of both cool to warm LED arrays - maintaining a CRI above 90. Two color temperature range options are offered: 6500K to 2700K, and 5000K to 2700K. The range of color DUO offers is useful for entraining circadian rhythms, stimulating alertness, and compensating for jet lag among other applications. The Chromawerx drivers are programmed to limit maximum light output and power usage across all color temperatures. When paired with DALI drivers (DDA/DDA8), color tuning follows a linear dimming curve.

### ELECTRICAL

Unless otherwise specified, dimming down to 1%. At maximum driver load: efficiency > 84%, PF > 0.9, THD < 20%. ELV and TRIAC dimming performance (including minimum dimming percentage) subject to dimmer selection.

**Integral:** 0-10V, ELV, TRIAC

**Remote:** 0-10V, ELV, TRIAC, Lutron Hi-Lume 1% EcoSystem, DALI, eldoLED 0.1% SOLOdrive 0-10V, eldoLED 1% ECOdrive 0-10V, DMX, Lutron DALI-2 digital

**Emergency battery option:** Remotely-installed, long-life, high-temperature, maintenance-free, Bodine Lithium-Ion battery pack with self-test functionality, test switch and charge indicator. IOTA and Fulham options available upon request. Minimum of 90 minutes operation, and recharge time of 24 hours. For fixtures less than 10 W, the battery provides 6 W of emergency light output. For fixtures 10 W and over, the battery provides 10 W.

### PoE

Depending on the PoE manufacturer selected, Lumenwerx will install the node in factory as either integral to the luminaire or as a remote module. Factory programming of the PoE node may or may not enable the following functionalities: lumen package, DUO (tunable white), QUADRO (RGBW), emergency battery backup, and sensor integration. These must be addressed and evaluated on a case-by-case basis.

### CONSTRUCTION

**Housing:** Die-cast and extruded aluminum

**Canopy:** Flat, conduit feed, and direct

**Finish:** Matte white, matte black, champagne, and dark bronze.

Custom colors also available (provide RAL #). Satin silver and matte silver finishes are also available for Baffle.

**Heat sink:** Die-cast aluminum

**Baffle:** Die-cast aluminum

**Baffle style:** Bevel, pinhole, and decorative bevel

# AERA 3" FLEX CYLINDER

## SURFACE

### DIRECT



#### WEIGHT

**4.5"**: 1.8 lbs - 0.82 kg

**6"**: 2.4 lbs - 1.09 kg

#### LENS AND ACCESSORIES



Soft diffused lens, Solite



Frosted diffused lens



Clear lens



Linear spread



Hex louver

#### ENVIRONMENT

Ambient temperature at fixture location shall be within 0°C/32°F - 25°C/77°F, indoor dry or damp as well as outdoor damp use (canopies or marquees).

#### CERTIFICATION

**ETL**: Rated for indoor dry/damp locations. Conforms to UL Standard 1598 and certified to CAN/CSA Standard C22.2 No. 250.0.

#### WARRANTY

Lumenwerx provides a five-year limited warranty on electrical and mechanical performance of the luminaires, including the LED boards, drivers, and auxiliary electronics. Lumenwerx will repair or replace defective luminaires or components at our discretion, provided they have been installed and operated in accordance with our specifications. Other limitations apply, please refer to the full warranty on our website.