

## INSTALLATION INSTRUCTIONS



This product must be installed in accordance with the National Electrical Code and all applicable local codes, by a person familiar with the construction and operation of the product, and the hazards involved. Proper grounding is required for safety.

Ce produit doit être installé suivant le code national de l'électricité, ainsi que tous les codes locaux applicables, par une personne familière avec la construction et le fonctionnement du produit, ainsi que tous les risques qui y sont associés. La mise à terre électrique est obligatoire pour la sécurité.



Disconnect power before installation or servicing.



Do not cover the light element lens or heatsink with any materials or adhesive tapes when the fixture is powered.



Handle the LED cartridge carefully during removal and installation. Tools must not touch the LED chips. Contact may result in damage and LED failure.



Wire dimming conductors as Class 1.



A luminaire with more than one power supply connection means shall be connected to only one branch circuit.



For luminaires specified as recessed, clearance between the sides of the luminaire and parts of the building must be 1/2" minimum; clearance to insulating materials to be 3" minimum, unless luminaire is IC rated.



Warranty claims will not be accepted if incorrect driver or light element is used.

## INSTALLATION INSTRUCTIONS

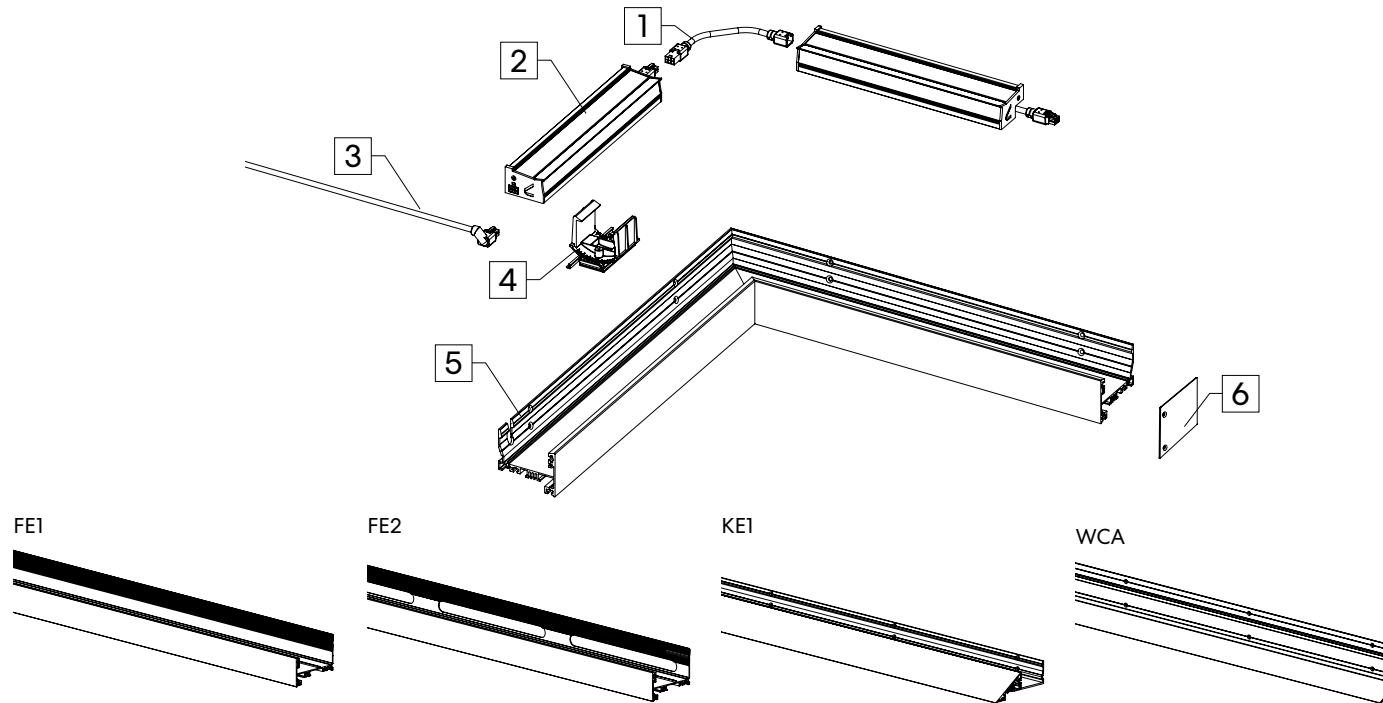

For electrical connections, please refer to the [wiring diagram guide](#).



For remote driver box installation instructions, please refer to the [remote driver installation sheet](#).



### INDEX

FE1, FE2, KE1 - Installation.....	<a href="#">P3</a>
WCA - Wall cove installation.....	<a href="#">P2</a>
WCA - Adjustable bracket installation.....	<a href="#">P9</a>

### ITEMS LIST

1	Jumper cable
2	Fixture
3	Leader cable
4	Adjustable bracket (WCA only)
5	Ramp
6	End cap (Optional)

### TOOLS REQUIRED

- Hand drill
- #10 drywall screws
- Drywall knife or cutter
- Paint brush
- Drywall tape
- Plastering tools
- 5/64" Allen key

## FE1 / FE2 / KE1 - INSTALLATION

### 1 INSTALL FIRST RAMP TO BEAMS.

Locate the support beams [A] and trace a reference line on the wall where to install the ramp [B].

Drill holes on the drywall all the way to the beams [A], where the ramp [B] will be located.

With the help of a level, anchor the ramp [B] onto the beams with #10 screws [C].

**Note:** Power cable hole -  $\varnothing$  1/2"

**Note:** For FE2 prepare the area with the air return per the shop drawings dimensions.

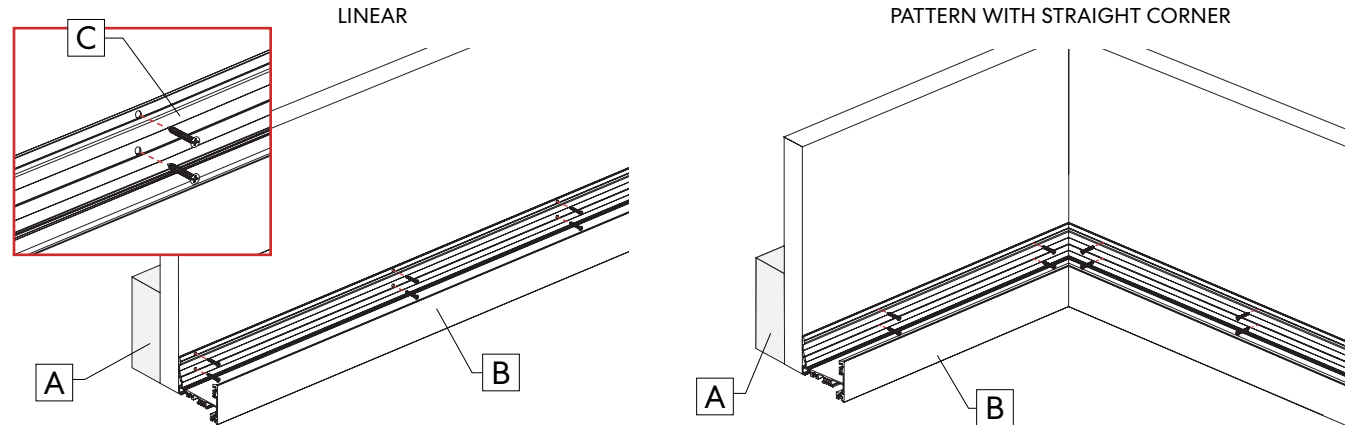

### 2 LOOSEN THE JOINER.

Loosen the set screws [D] on the joiners [E].

Slide the joiners [E] all the way into the ramp [B].

**Note:** There are three joiners for flat edge and flat edge with air return. There are two joiners for knife edge.

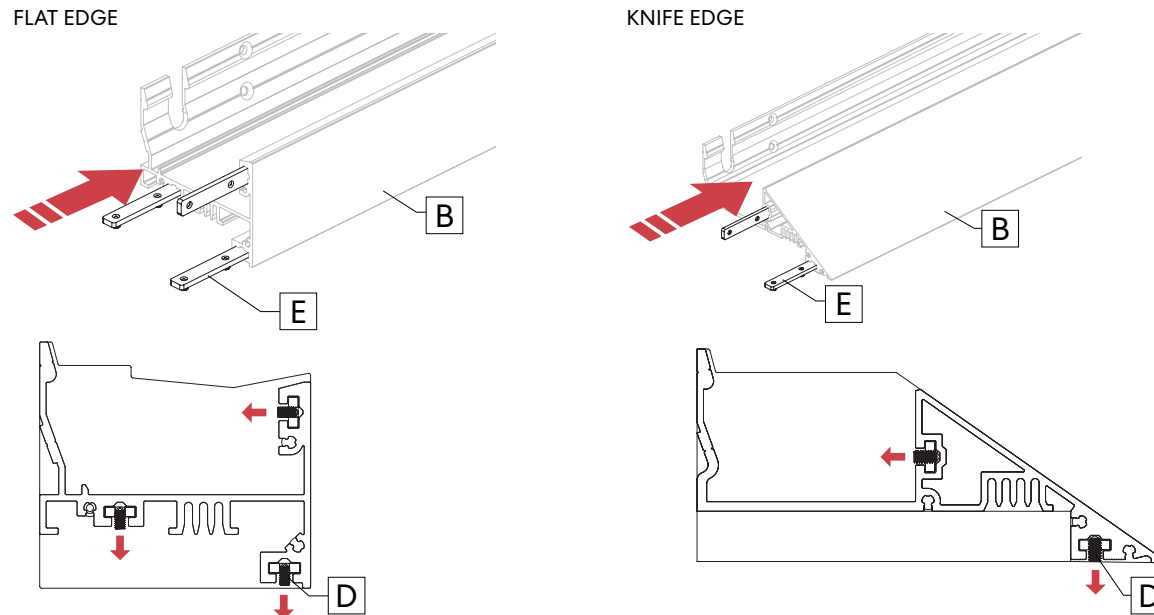

## FE1 / FE2 / KE1 - INSTALLATION

### 3 INSTALL RAMP TO BEAMS.

Align the next ramp [F] to the 1<sup>st</sup> ramp [B] using a level.

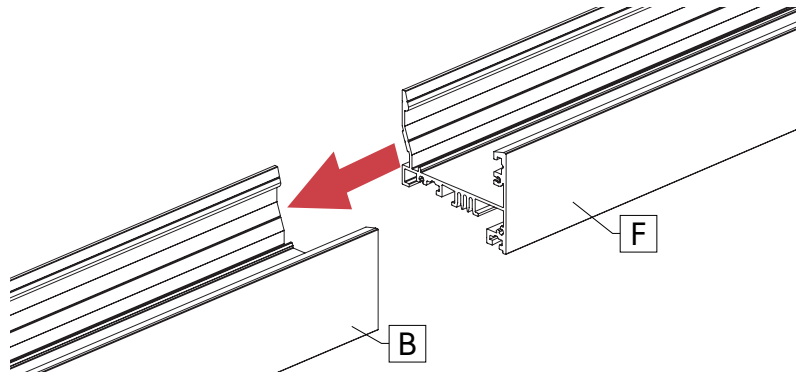

Drill holes on the drywall all the way to the beams, where the next ramp [F] will be located.

With the help of a level, anchor the next ramp [F] onto the beams with #10 screws [C].

**Note:** Power cable hole - Ø 1/2"

**Note:** For FE2 prepare the area with the air return per the shop drawings dimensions.

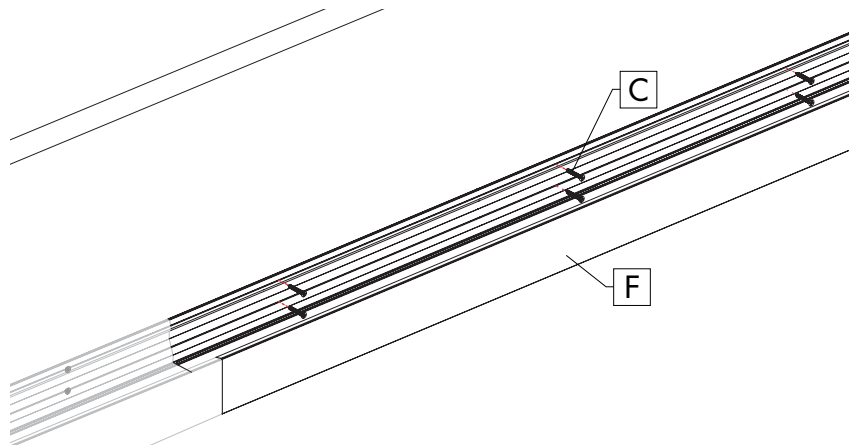

### 4 JOIN RAMP.

Slide the joiner [E] from one side to the middle of the two ramps.

Secure the joiner [E] by tightening the set screws [D].

**Note:** Repeat steps 2 to 4 for each ramp section.

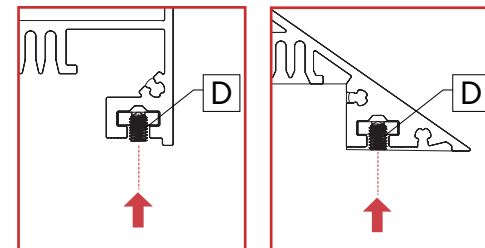
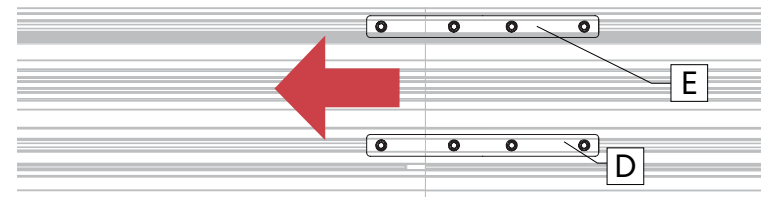

## FE1 / FE2 / KE1 - INSTALLATION

### 5 MARK DRYWALL.

To indicate where to cut the drywall piece **[G]**, mark a line according to the dimensions of the ramp **[B]**.

To indicate where to screw the drywall piece **[G]** to the ramp **[B]**, mark the location of the screws every 6 to 8 inches. See the section view for detailed dimensions.

**Note:** A shim might be necessary for a drywall thinner than 5/8".

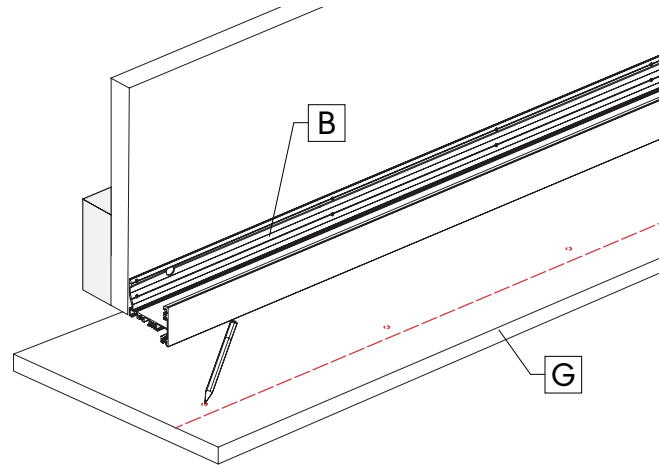

FLAT EDGE

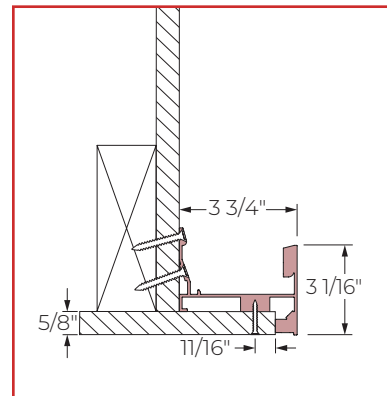

FLAT EDGE WITH AIR RETURN

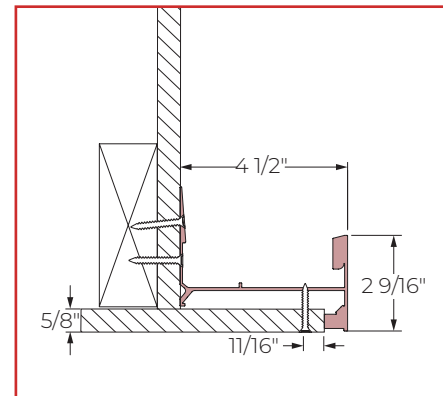

KNIFE EDGE

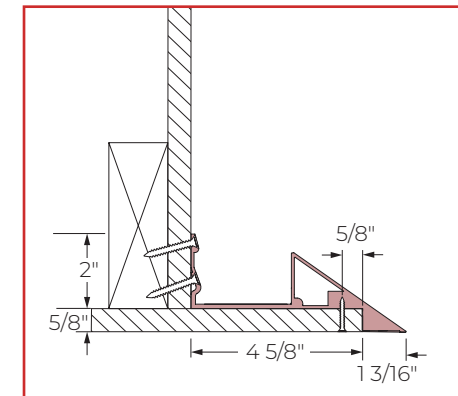

## FE1 / FE2 / KE1 - INSTALLATION

### 6 INSTALL DRYWALL.

Cut and install drywall piece [G] on ramp [B] with 1" long, #6 screws [C] (by others).

Follow the guide line.

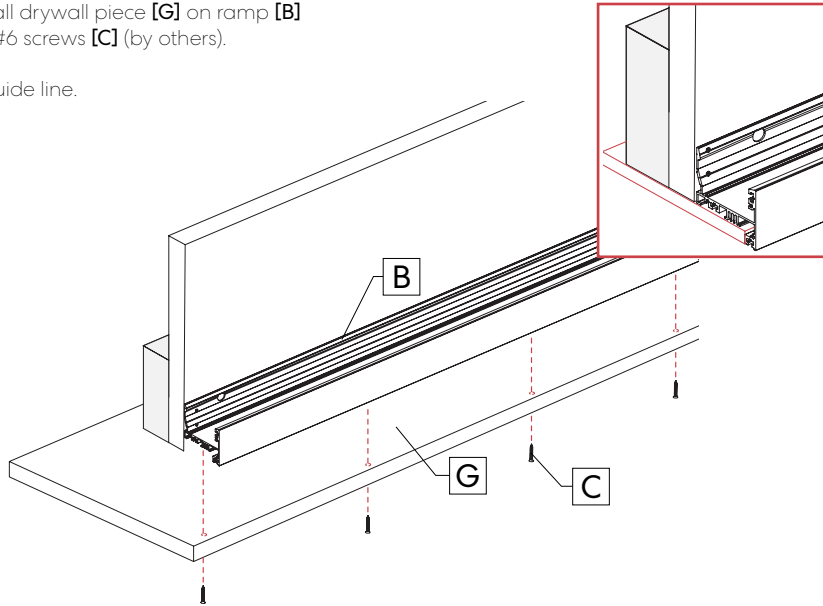

### 8 FINISH RAMP.

Finish the ramp installation [B] with primer paint.

Use drywall compound in front and under the ramp, sand until everything is even.

Paint the ramp the desired color.

**Note:** Applying primer paint before installing drywall compound will help it to stick to the surface.

Use drywall tape between joining sections for better results.

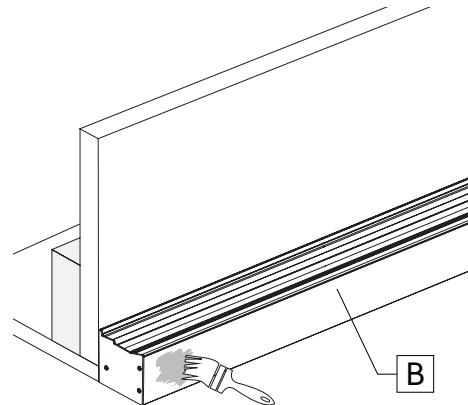

### 7 INSTALL END CAPS. OPTIONAL

Place end caps [H], if provided, at the extremities of the ramp [B] and secure them with screws [C].

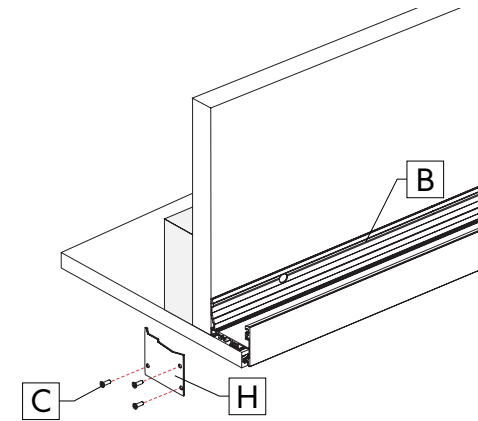

### 9 INSTALL EVOQ FIXTURE AND MAKE ELECTRICAL CONNECTIONS.



For fixture installation, please refer to the [Evoq fixture installation sheet](#) for more information.

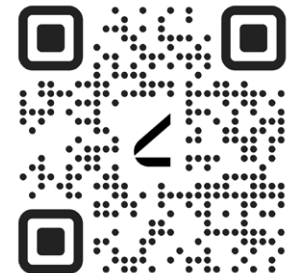

## WCA - WALL COVE INSTALLATION

### 1 INSTALL FIRST RAMP TO BEAMS.

Locate the support beams [A] and trace a reference line on the wall where to install the ramp [B].

Drill holes on the drywall all the way to the beams [A], where the ramp [B] will be located.

With the help of a level, anchor the ramp [B] onto the beams with #10 screws [C].

**Note:** Power cable hole -  $\varnothing 1/2"$

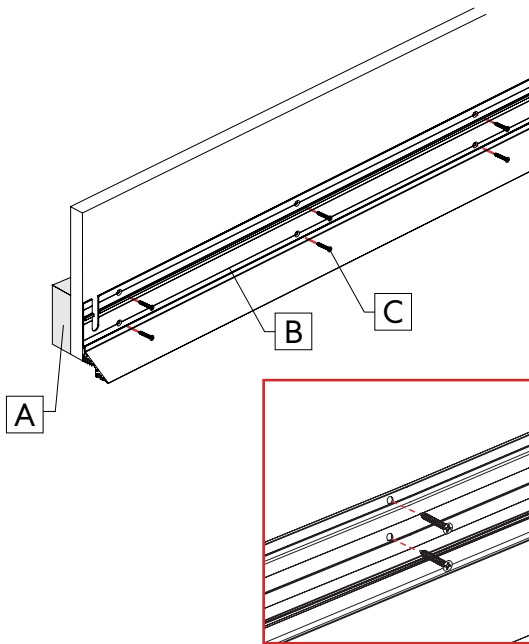

### 2 LOOSEN THE JOINER.

Loosen the set screws [D] on the joiner [E] underneath the ramp [B].

Slide the joiner [E] all the way into the ramp [B].

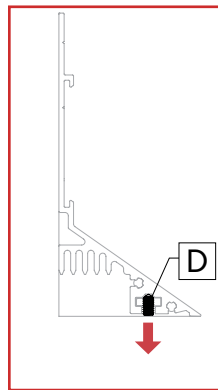
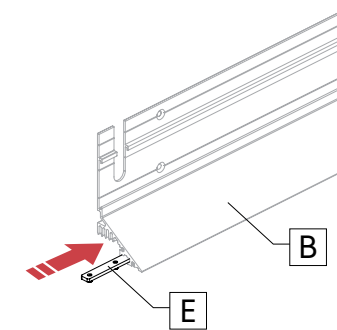

### 3 INSTALL RAMP.

Align the next ramp [F] to the 1<sup>st</sup> ramp [B] using a level.

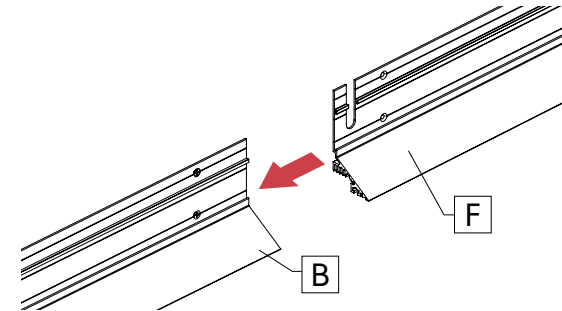

Drill holes on the drywall all the way to the beams, where the next ramp [F] will be located.

With the help of a level, anchor the next ramp [F] onto the beams with #10 screws [C].

**Note:** Power cable hole -  $\varnothing 1/2"$

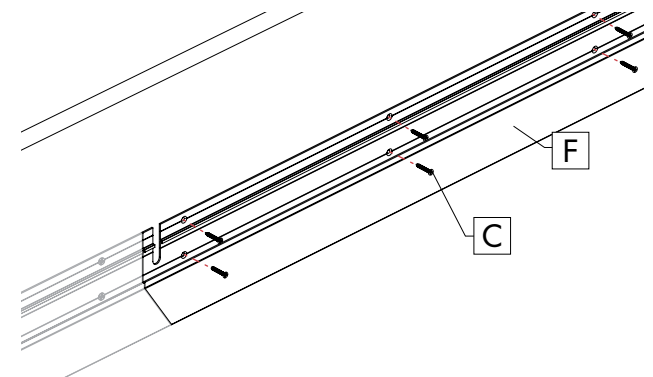

### WCA - WALL COVE INSTALLATION

#### 4 JOIN RAMPS.

Slide the joiner [E] from one side to the middle of the two ramps.

Secure the joiner [E] by tightening the set screws [D].

**Note:** Repeat steps 2 to 4 for each ramp section.

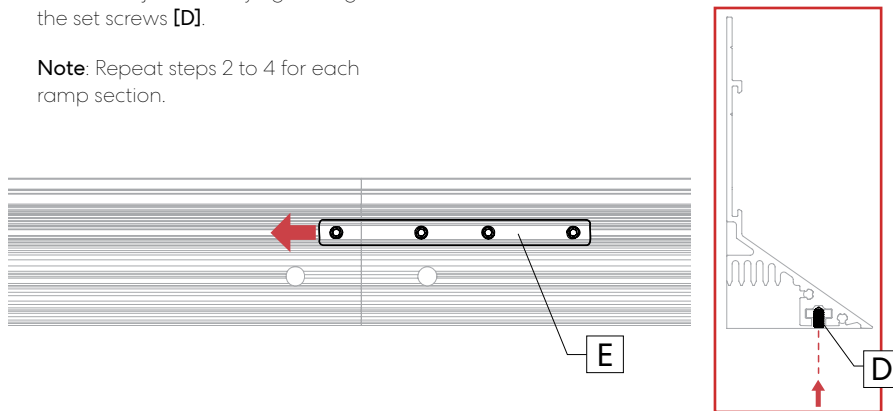

#### 5 MARK DRYWALL.

To indicate where to cut the drywall piece [G], mark a line according to the dimensions of the ramp [B].

To indicate where to screw the drywall piece [G] to the ramp [B], mark the location of the screws every 6 to 8 inches.

**Note:** See the section view for dimensions.

**Note:** A shim might be necessary for a drywall thinner than 5/8".

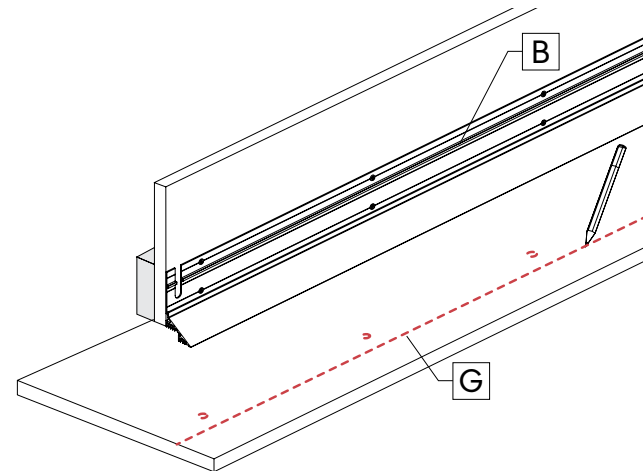
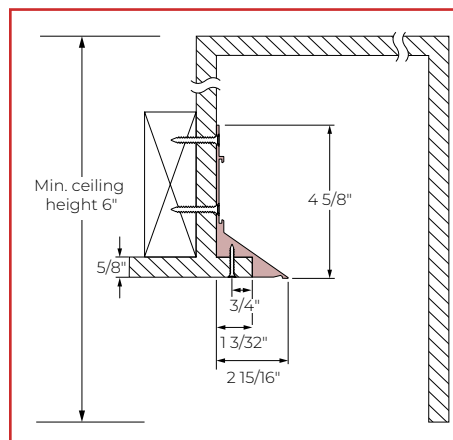

## WCA - ADJUSTABLE BRACKET INSTALLATION

### 1 PREPARE THE ADJUSTABLE BRACKET.

Remove the angle adjustment locks [AA] and flat head screws [BB] from the adjustable bracket assembly [CC].

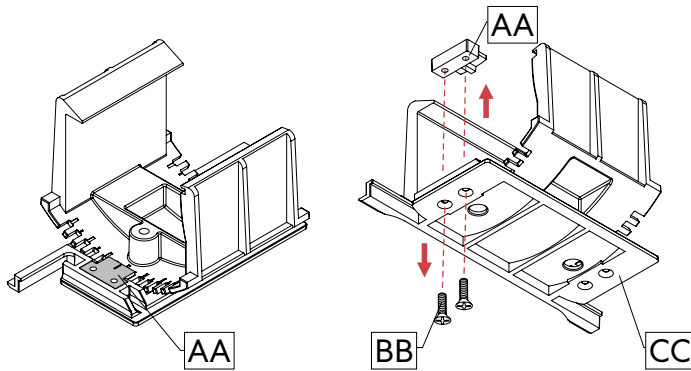

### 2 REMOVE FIXTURE HOLDER.

Tilt the fixture holder [DD] upward and remove it from the adjustable bracket [EE].

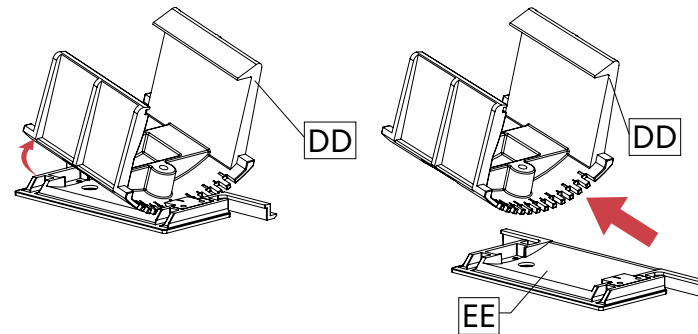

### 3 INSTALL THE FIXTURE.

Slide the fixture [FF] through the fixture holder [DD].

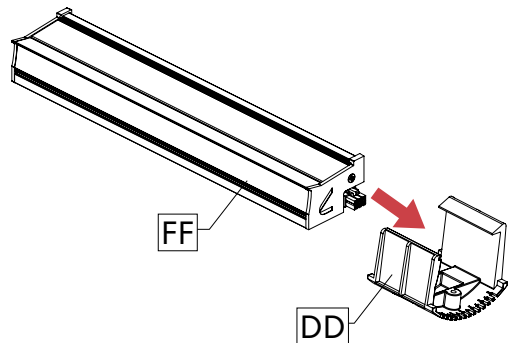

Secure the fixture [FF] into the fixture holder [DD] with set screws [GG] using 5/64" Allen key.

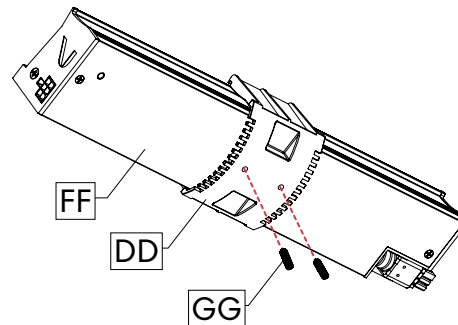

## WCA - ADJUSTABLE BRACKET INSTALLATION

### 4 INSTALL FIXTURE HOLDER.

Rotate the fixture holder [DD] to the right angle. Reinstall the fixture holder [DD] on the adjustable bracket [EE].

**Note:** A gradation system is found underneath the fixture holder.

Re-install the angle adjustment locks [AA] and secure it at the desired angle with the flat head screws [BB].

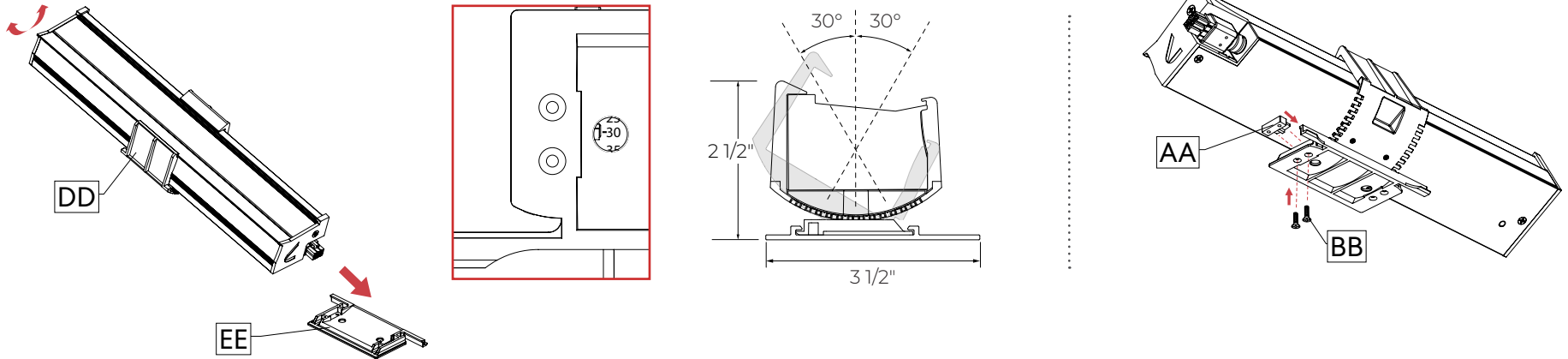

### 5 INSTALL THE ADJUSTABLE BRACKET.

Install the adjustable bracket assembly [CC] on the mounting rail [HH].

Slide the straight side of the bracket [II] in the mounting rail [HH] and then snap the two tabs into place [JJ].

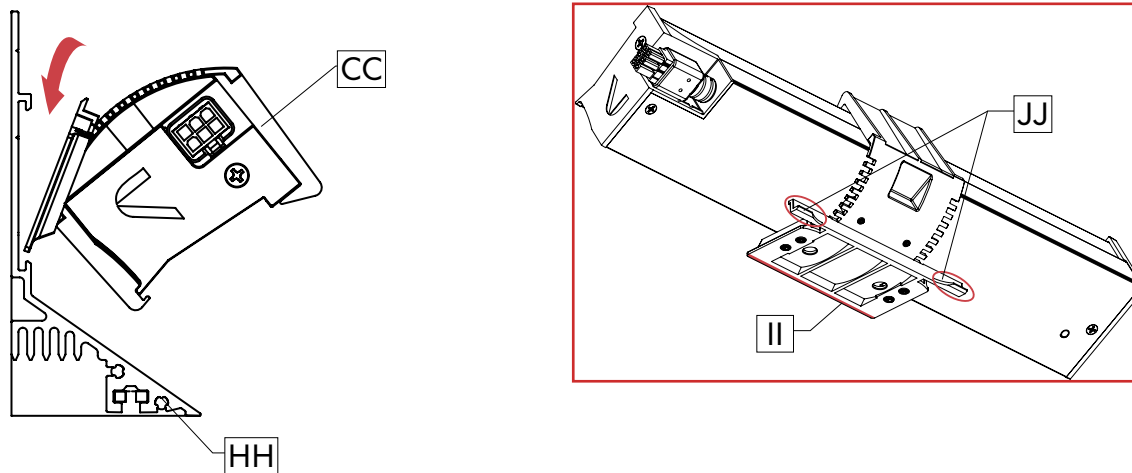

# EVOQ

Mud-in - FE1 / FE2 / KE1 / WCA



## WCA - ADJUSTABLE BRACKET INSTALLATION

---

**6** REPEAT STEPS **1 - 5** OF THE ADJUSTABLE BRACKET INSTALLATION SECTION FOR THE REST OF THE FIXTURES IN THE RUN.

**7** INSTALL EVOQ FIXTURES AND MAKE ELECTRICAL CONNECTIONS. ....



For fixture installation, please refer to the [Evoq fixture installation sheet](#) for more information.

