

STEPLIGHT

WALL - RECTANGULAR
SEAL SEMI-RECESSED



Project: _____

Type: _____



- Rectangular horizontal and vertical faceplates
- Multiple LED choices
- 90-degree cut-off obstructs light trespass
- Polycarbonate lens
- Shallow housing comply with ADA requirements
- 1.5 W output wattage, up to 40 lm
- Non-dimmable integral driver

SENSORS
For latest information on sensors, click [here](#).



Visual Comfort+



Shield-Control

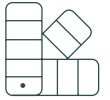

Silverwerx

Order Guide

LUMINAIRE ID	FACEPLATE ORIENTATION	COLOR TEMPERATURE	VOLTAGE	FINISH
STPL				
STPL - Healthwerx Steplight	RV - Rectangular vertical RH - Rectangular horizontal	27K - 2700K 30K - 3000K 35K - 3500K 40K - 4000K AMB - Amber light BLU - Blue light	120V - 120V 277V - 277V UNV - 120V-277V	FTMW - Matte white FTMB - Matte black WA - White antimicrobial Silverwerx CF# - Custom finish, specify RAL#

Dimensions

Rectangular vertical

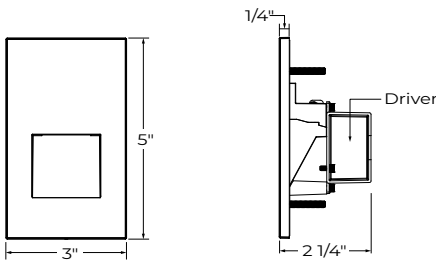

Rectangular horizontal

