

MINI PIVOT LINEAR

Surface - Drywall



! This product must be installed in accordance with the National Electrical Code and all applicable local codes, by a person familiar with the construction and operation of the product, and the hazards involved. Proper grounding is required for safety.

Ce produit doit être installé suivant le code national de l'électricité, ainsi que tous les codes locaux applicables, par une personne familière avec la construction et le fonctionnement du produit, ainsi que tous les risques qui y sont associés. La mise à terre électrique est obligatoire pour la sécurité.

! Wire dimming conductors as Class 1.

💡 For electrical connections, please refer to the [wiring diagram guide](#).



SINGLE FIXTURE

! For remote driver box, please refer to the [remote driver installation sheet](#) for more information.

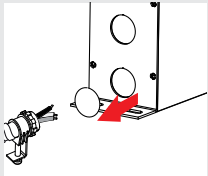

1 PREPARE CEILING.

Cut the opening, 3 1/4"x1" [A] in ceiling, according to the dimensions given in the client drawings.

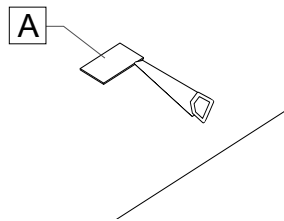

Bring the main power [B] from the ceiling opening.

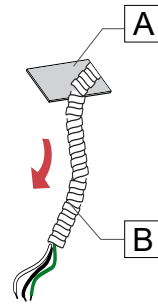

2 MAKE ELECTRICAL CONNECTIONS.

Make electrical connections between the main power [B] and track cables [C] with wire nuts [D].

Arrange the wires and insert them into the ceiling.

NOTE: Connect the green wire to your ground wire.

WARNING: A luminaire with more than one power supply connection means shall be connected to only one branch circuit.

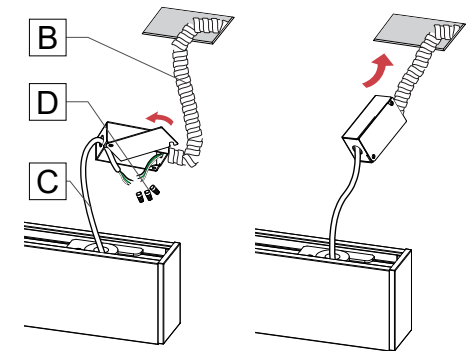

3 FIX FIXTURE TO CEILING.

Fasten screws [E] through the pre-cut holes of the fixture [F].

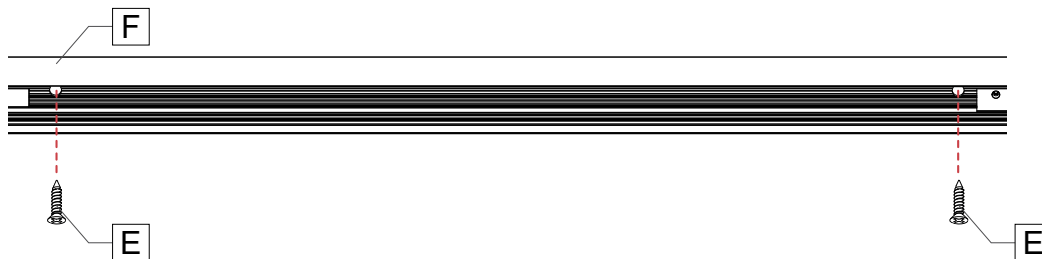

MINI PIVOT LINEAR

Surface - Drywall



CONTINUOUS RUN

1 FOR CONTINUOUS RUN, REPEAT STEPS **1** AND **3** FROM THE SINGLE UNIT SECTION FOR THE FIRST TRACK IN THE RUN.

2 MAKE ELECTRICAL CONNECTIONS BETWEEN FIXTURES. **3** JOIN THE FIXTURES.

Make the wire connections between the two fixtures [F] and [G] using wire nuts [D]. Push wires inside the fixture.

Note: Number of wires may vary.

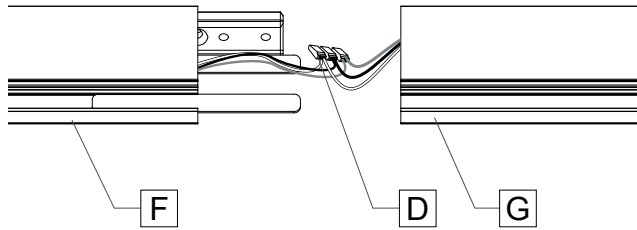

Slide the second fixture [G] to the first fixture [F] aligning the blades [H] and push the second fixture [G] until it clicks in.

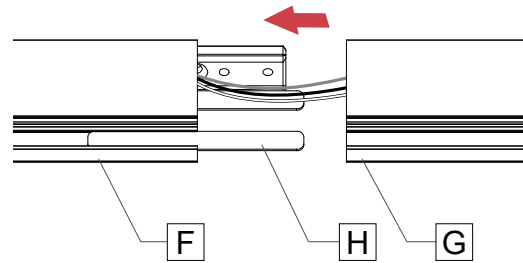

Secure the joiner using set screws [I]. Fasten screws [J] through the pre-cut holes of the second fixture [G].

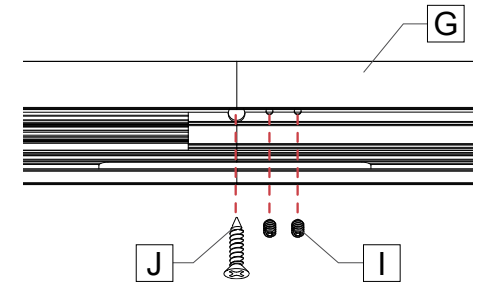

4 REPEAT STEPS **2-3** FOR ALL OTHER FIXTURES IN THE RUN.