

PIVOT

TRACK - PENDANT



DESCRIPTION

Pivot is an architectural 48V linear magnetic track lighting system for pendant mounting. The Pendant Track is low voltage and accommodates the Pivot Track Modules. It possesses infinite run capabilities in segments of up to 8' with smooth transitions at the joint. It can also be branched out to create a multitude of shapes, patterns, and effects for various architectural applications. The Track is offered in different circuit and control channel variations.



Project: _____

Type: _____

Track

Example: PIVPLIN-9FT6IN(2X3FT-1X3FT6IN)-WIO2(SW-80CRI-750LMF-35K)-2FT4IN-NA-120V-DI-USC-1CICCUDI-NA-ACS-FTMB-BK-NA

A drawing of your pattern is required - anything from a line drawing to an architectural drawing. You can also use the grid on page 3 to sketch your layout.

LUMINAIRE ID	LUMINAIRE LENGTH ⁴	INDIRECT OPTIC ⁵	CORNER TYPE ^{8,9}
PIVPLIN ¹ - Pivot Pendant Linear PIVPPAT ² - Pivot Pendant Pattern PIVPCURPAT ³ - Pivot Pendant Curved Pattern	##FT##IN (#X#FT#IN-#X#FT#IN-...) - ##FT##IN: total nominal length of continuous run or pattern in feet and/or inches (3' or longer) #X: quantity of each section #FT#IN: nominal length of each section in feet and/or inches, specify between 3' and 8' ⁴ Consult the Maximum Track Wattage table on page 3 to determine the maximum load allowed per section.	WIO2 ^{6,7} - Widespread Indirect Optic BLA - Blank cover NA - None ⁵ By default, the track comes with no cover. If either light and/or a blank cover is required for the indirect side, select WIO2 and/or BLA. Specify the total length for each required indirect optic, and provide a drawing detailing the length and positioning of each indirect optic section. Or else select NA when nothing is required on the indirect side. ⁶ Minimum 2', specify in 4" increments. ⁷ To specify see the indirect optic code and example below.	#LNH2 (A##) - 2-way horizontal Linx #LNH3(A##) - 3-way horizontal Linx #LNH4(A##) - 4-way horizontal Linx #CLEV(R##A90) ¹⁰ - Curved leveled corner #CLEV(R##A90BLA) ¹⁰ - Curved leveled corner with blank cover NA - None ⁸ Specify quantity (#) and angle (A##) for each required corner type. If more than one option is specified, separate codes with a "+", e.g. 1LNH2(A90)+2LNH4(A90). ⁹ Separate angles with a "+" if more than one type is required, e.g. 1LNH4(A60+A120) ¹⁰ Specify radius in inches (R##). The minimum radius is 7". Curved corner is fixed and unlit. Modules cannot be inserted in the corner. ¹¹ Minimum angle is 60°.

VOLTAGE	DIMMING	TRACK CHANNEL	CONTROL CHANNEL ¹⁵
120V - 120V 277V - 277V UNV - 120V-277V	ND - Non-dimming D1 - 1% 0-10V DA ¹² - DALI LECS ^{12,13,14} - Lutron EcoSystem ¹² On-site commissioning is required. See page 7 for details. ¹³ Only available with USC, 1 circuit, and 1 control channel options (1CICCU, 1CICCU, 1CICCU, 1CICCU). ¹⁴ Comes with a control box that must be installed remotely.	USC - Unified single channel DUC - Dual channel	DIRECT 1CICCU - 1 circuit, 1 control channel (USC) 1C2CCDD - 1 circuit, 2 control channels (DUC channel 1 - DUC channel 2) 2C2CCDD - 2 circuits, 2 control channels (DUC channel 1 - DUC channel 2) ¹⁵ For more details, please see page 5.

EMERGENCY SECTION	MOUNTING	OUTSIDE FINISH ^{21,22}	INSIDE FINISH	OPTIONS ²³
EC ¹⁶ - Emergency light section NA - None ¹⁶ Consult factory.	ACS ¹⁷ - Aircraft cable, standard ACC(I) ¹⁸ - Aircraft cable, custom THR#IN ^{19,20} - Threaded rod, specify length in inches ¹⁷ Standard canopies and power cord are black for black fixtures, and white for all other finishes. Ø 5" for power canopy, Ø 3" for non-power. Aircraft cable length is 36". ¹⁸ To specify a custom mounting, please refer to the mounting code on page 5 to see all available options. ¹⁹ Threaded rods provided by others. Specify length to determine power cord length. ²⁰ Not available with WIO2.	FTMB - Matte black FTMW - Matte white CF# - Custom finish, specify RAL# ²¹ Linx or corner finish will match outside finish. ²² See page 6 for more finish options.	BK - Black WH - White	FU120 - Fuse 120V FU277 - Fuse 277V CTB9 - T-bar caddy clip, 9/16" CTB15 - T-bar caddy clip, 15/16" CTC9 - Tegular caddy clip, 9/16" CTG15 - Tegular caddy clip, 15/16" CST - Screw slots caddy clip NA - None ²³ Separate codes with a "+" if more than one is specified.

Indirect optic

Example: WIO2(SW-80CRI-750LMF-35K)

INDIRECT OPTIC	INDIRECT LIGHT SOURCE	INDIRECT CRI	INDIRECT LUMEN PACKAGE	INDIRECT COLOR TEMPERATURE
WIO2 - Widespread Indirect Optic	SW - Static white FS - Full spectrum static white	80CRI ²⁴ - 80+ CRI 90CRI ²⁴ - 90+ CRI 95CRI - 95+ CRI ²⁴ Not available with full spectrum.	500LMF - Low output 500 lm/ft 750LMF - Medium output 750 lm/ft 1000LMF ²⁵ - High output 1000 lm/ft ²⁵ Not available with 95+ CRI.	27K - 2700K 30K - 3000K 35K - 3500K 40K - 4000K

CURRENT LIMITER

The Pivot Track system is based on a low-voltage (48 VDC) design that integrates the AC/DC conversion inside the body of the track (expect for Surface). The AC/DC 48V power supplies inside the fixture are inherently limited to specific wattages intended to provide at least 12 W/ft. Accordingly, if a track section is overloaded with modules, the system can never draw more than the rating of the power supply inside. In situations where the wattage of the modules installed exceeds the rated wattage of the integral power supply, flashing will typically occur to indicate an overload event.

Dimensions

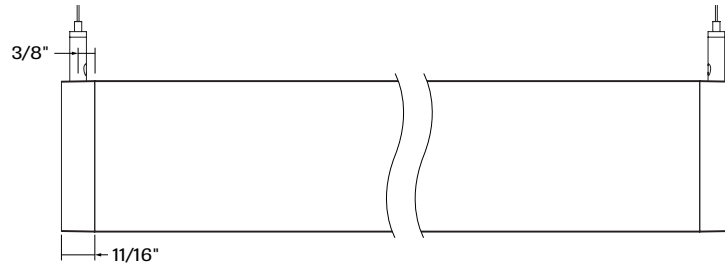
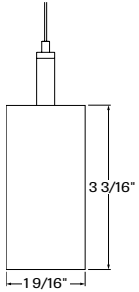

Continuous run - with two end caps

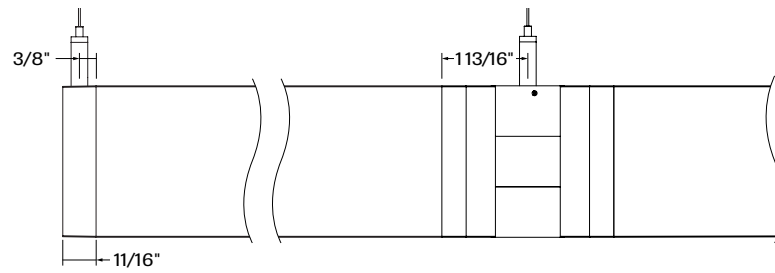

Pattern - shown with an end cap, 2-way horizontal Linx

Corner Type

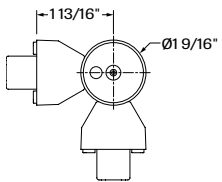

LNH2(A##) - 2-way horizontal Linx

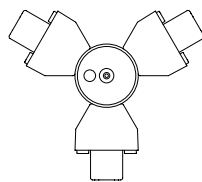

LNH3(A##) - 3-way horizontal Linx

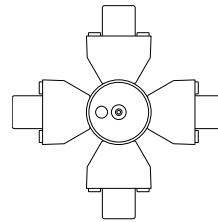

LNH4(A##) - 4-way horizontal Linx

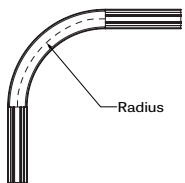

CLEV(R##A90BLA) - Curved leveled corner with blank cover *

* An option with no blank cover is also available, CLEV(R##A90).

Custom pendant mounting code

For a custom mounting, specify the options in the parentheses.

Example: ACC(3NPC-72IN-W-PCB-NA)

MOUNTING - AIRCRAFT CABLE, CUSTOM					
ACC()					
	NON-POWER CANOPY SIZE	AIRCRAFT CABLE LENGTH	CANOPY FINISH	POWER CORD COLOR	OPTION
ACC	3NPC - Ø 3" non-power canopy 5NPC - Ø 5" non-power canopy	36IN - 36" 72IN - 72" 120IN - 120" #IN ¹ - Other lengths, specify in inches <small>¹Maximum length is 288". For longer lengths, please consult factory.</small>	W - Matte white AL - Aluminum B - Matte black CF# - Custom finish, specify RAL#	PCW - White PCB - Black	SEM ² - Seismic mounting SLC ² - Sloped ceiling for aircraft cable NA - None <small>²Not available with the Ø 3" non-power canopy size.</small>

Circuit and channel specification

TRACK CHANNEL	CONTROL CHANNEL
USC - Unified single channel DUC - Dual channel	DIRECT 1C1CCUD - 1 circuit, 1 control channel (USC) 1C2CCDD - 1 circuit, 2 control channels (DUC channel 1 - DUC channel 2) 2C2CCDD - 2 circuits, 2 control channels (DUC channel 1 - DUC channel 2)
	DIRECT/INDIRECT 1C1CCUDI - 1 circuit, 1 control channel (USC with indirect light) 2C2CCUDI - 2 circuits, 2 control channels (USC - indirect light) 2C2CCDDI - 2 circuits, 2 control channels (DUC channel 1 with indirect light - DUC channel 2) 2C3CCDDI - 2 circuits (DUC - indirect light), 3 control channels (DUC channel 1 - DUC channel 2 - indirect light)

Direct

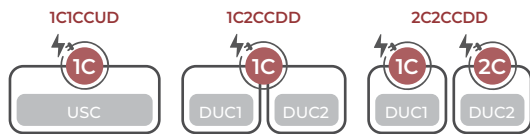

Direct/Indirect

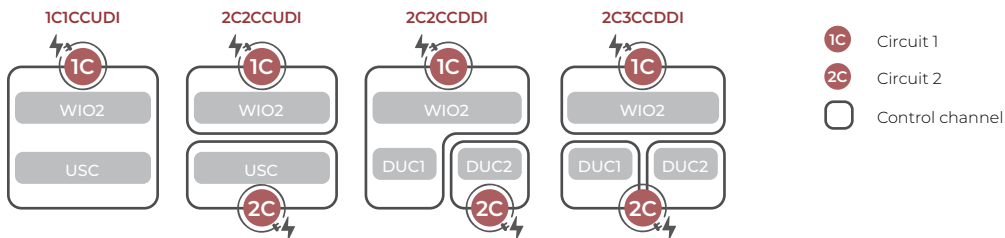

Photometrics

Values calculated based on a 4' fixture at 3500K.

INDIRECT OPTIC

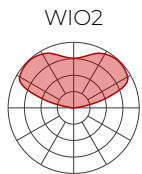

LM/FT	W/FT	LM/W
500	3.6	139
750	5.6	134
1000	7.7	130

Multiplier - CCT/CRI

CCT	WATTS	
	80+ CRI / 90+ CRI	LPW
2700K	1.05	0.95
3000K	1.02	0.98
3500K	1.00	1.00
4000K	1.00	1.00

Finishes

Standard

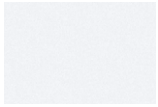

FTMW - Matte White



FTMB - Matte Black

Custom

Neutrals

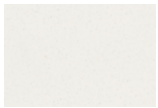

CRM - Cream



GRY - Gray



STG - Steel Gray



SAG - Sage Gray



BLB - Black Blue

Designer

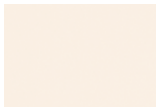

ALM - Almond



RST - Rust Fine
Texture



GRB - Green Beige



YLW - Yellow



SLM - Salmon Pink



VIO - Pastel Violet



RED - Red



PRR - Purple Red



SMB - Storm Blue



DPB - Deep Blue



OCB - Ocean Blue



BLG - Blue Green



GNS - Green Smoke



MNG - Mint Green

Metallics



CHP - Champagne



DBZ - Dark Bronze



CNY - Canyon

Premium Custom

Neutrals

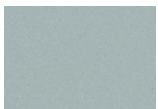

MOG - Moss Gray



QRZ - Quartzite
Texture



LMG - Lime Green



GLD - Gold



IRN - Iron Ore



SBP - Sandblast
Copper



SWD - Sandalwood

Some colors may have longer lead time.

Technical Specifications

INDIRECT OPTIC

Widespread Indirect Optics (WIO2)

A horizontal LED array with a widespread indirect micro prismatic optic that offers an impressive 160° spread. WIO2 creates an even illumination for smooth brightness on the ceiling that can achieve uniformity ratios of up to 2:1.

Uniformity [max/min]

Based on 18' continuous runs, in a 20' x 40' room, 10' wall height

Mounting height from ceiling	Spacing (Center to center)		
	8'	10'	12'
12"	5.5	10.0	9.0
18"	3.5	6.0	6.0
24"	2.5	4.0	4.5

Blank (BLA)

Blank covers can be specified to cover unlit sections of the indirect portion of the Pivot track. By default, the track comes with no cover. Blank covers are finished to match the outside color of the track.

LIGHT SOURCE

Static white

Custom array of mid-flux LEDs are mounted directly to the housing for optimal thermal performance. Available in 2700K, 3000K, 3500K, and 4000K with a minimum 80+ CRI and an option for 90+ CRI with elevated R9 value. Color consistency maintained to within 3 SDCM. LEDs operated at reduced drive current to optimize efficacy and lumen maintenance. All LEDs have been tested in accordance with IESNA LM-80-08 and the results have shown L80 lumen maintenance greater than 60,000 hours. Absolute product photometry is measured and presented in accordance with IESNA LM-79, unless otherwise indicated.

Full spectrum static white

The full spectrum LED option offers improved color particularly in the cyan region that is beneficial in both healthcare and circadian lighting strategies. The cyan region in full spectrum LED is richer at the 480 nm range.

LUMINAIRE LENGTH

Pivot Track is available as a continuous run (straight linear shape with no Linx or corner), a pattern containing at least 1 Linx, or as a curved pattern containing at least 1 curved corner or Linx. It is built using track sections of 3' to 8'. The total nominal length must be specified in the product code, as well as the quantity and nominal length of each section. Lengths can be ordered in 1' increments. The track length is not field adjustable.

All individual sections are joined together onsite using the joiner kits provided. Lumenwerx offers joiner kits that are extremely simple to work with in the field and result in a fixture that appears virtually seamless with no light leak at any connection.



ELECTRICAL

Direct

The Pivot Track is powered by an integral (except for Surface) 48 VDC, Class 2, SELV power supply with universal (120-277 VAC) input. Rated lifetime of 50,000 hours at 50°C max. ambient (and 70°C max. case) temperature. At maximum driver load: Efficiency > 90%, PF > 0.9, THD < 20%. The power supply is coupled to a proprietary dimming interface which allows one or both track channels to be controlled together or independently using a 0-10V or DALI signal. Both the power supply and the dimming interface can be serviced from below. For applications requiring Lutron Ecosystem control, a separate, remote interface can be provided to translate Ecosystem to 0-10V.

Indirect

Factory-set, adjustable output current LED driver with universal (120-277 VAC) input. Dimmable from 100% to 1% with 0-10V dimming control. Rated life (90% survivorship) of 50,000 hours at 50°C max. ambient (and 70°C max. case) temperature. At maximum driver load: Efficiency > 84%, PF > 0.9, THD < 20%. Other specifiable options include non-dimming, Lutron 5-Series EcoSystem, and DALI protocol drivers. All of our standard 0-10V drivers are NEMA 410 compliant.

DALI

A maximum of 64 DALI devices is permitted on a single DALI line. Please note that each Pivot track section consists of a minimum of 2 DALI devices with the possibility of up to 4 DALI devices depending on control channel and circuit selection. Please consult factory for additional details.

MOUNTING

Pendant fixtures can be mounted either with aircraft cable or with threaded rod. See page 5 for details.

FINISH

Outside: Standard powder-coat paint available in matte white and black. Custom colors are also available in over 30 colors.

Inside: White or black

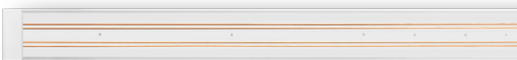

CONSTRUCTION

Track housing: Extruded aluminum, up to 90% recycled content

Joining system: Die-cast zinc

WIO2 reflector: Cold rolled steel die formed, 95% reflective matte white painted

WIO2 diffuser: Extruded acrylic

Blank cover: Extruded aluminum

End caps: Die-cast aluminum

Hanger: Chromed griplock securely attached in end caps and/or joiners with stainless steel hardware

Aircraft cable suspension: \varnothing 1/16" stainless steel aircraft cable

WEIGHT

3': 4.6 lbs - 2.1 kg

4': 5.9 lbs - 2.7 kg

6': 8.4 lbs - 3.8 kg

8': 11 lbs - 5.0 kg

CERTIFICATION

ETL: Rated for indoor dry locations. Conforms to UL Standard 1574 and certified to CAN/CSA Standard C22.2 No. 250.0.

WARRANTY

Lumenwerx provides a five-year limited warranty on electrical and mechanical performance of the luminaires, including the LED boards, drivers, and auxiliary electronics. Lumenwerx will repair or replace defective luminaires or components at our discretion, provided they have been installed and operated in accordance with our specifications. Other limitations apply, please refer to the full warranty on our website.