

# POP RECESSED

SQUARE 1x1  
STATIC WHITE, FULL SPECTRUM



Project: \_\_\_\_\_

Type: \_\_\_\_\_

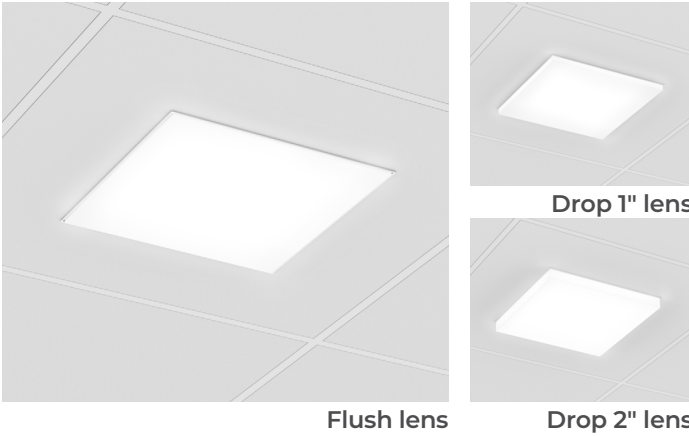

## DESCRIPTION

POP Recessed features a uniformly luminous diffuser that sits flush with the ceiling or drops up to 2" below. The diffuser and light engine form a fully enclosed unit secured by a twist-and-lock mechanism for easy maintenance with no exposed hardware. POP Recessed delivers up to 103 LPW and installs in grid or gypsum board ceilings.



IC RATED

## Order Guide

Up to 103 lm/W performance

LUMINAIRE ID	SIZE	OPTIC	LENS	LIGHT SOURCE	CRI	LUMEN PACKAGE
	<b>1FTX1FT</b>					
<b>POSQR</b> <sup>1</sup> - Pop Square Recessed <b>POSEALSQR</b> <sup>1,2</sup> - Pop Seal Square Recessed  <sup>1</sup> IK10 rated when specified with PTR optic. <sup>2</sup> IP54 rated when specified with drywall ceiling mounting option.	1FTX1FT - 1' X 1'	<b>ULO</b> <sup>3</sup> - Uniform Lambertian Optic <b>ATR</b> <sup>4</sup> - Acrylic lens with tamper-resistant screws <b>PTR</b> - Polycarbonate lens with tamper-resistant screws  <sup>3</sup> Not available with Pop Seal model (POSEALSQR). <sup>4</sup> Only available with Pop Seal model (POSEALSQR).	<b>FH</b> - Flush <b>1D</b> <sup>5</sup> - 1" Drop <b>2D</b> <sup>5</sup> - 2" Drop  <sup>5</sup> Only available with ULO.	<b>SW</b> - Static white <b>FS</b> - Full spectrum	<b>80</b> - 80CRI <b>90</b> - 90CRI	<b>750</b> - Min. low output 750lm <b>900</b> <sup>6</sup> - Medium output 900lm <b>1100</b> <sup>6</sup> - Max. high output 1100lm <b>####</b> - Other required lm  <sup>6</sup> Not available with full spectrum.

COLOR TEMP.	VOLTAGE	DRIVER <sup>7</sup>	ELECTRICAL	MOUNTING	FINISH	OPTIONS
<b>27</b> - 2700K <b>30</b> - 3000K <b>35</b> - 3500K <b>40</b> - 4000K	<b>120</b> - 120V <b>277</b> - 277V <b>UNV</b> - 120V-277V	<b>D1</b> - 1% dimming 0-10V <b>DA</b> <sup>8</sup> - DALI <b>LDE1</b> <sup>8</sup> - Lutron Hi-Lume 1% Eco <b>ELD1</b> - eldoLED 1% ECOdrive <b>ELD0</b> - eldoLED 0.1% SOLOdrive  <sup>7</sup> PoE (Power-over-Ethernet) compatible. Consult factory for details. <sup>8</sup> On-site commissioning is required.	<b>1</b> - 1 circuit <b>+GTD</b> - Generator transfer device	<b>TG9</b> - Tegular 9/16" <b>TG15</b> - Tegular 15/16" <b>TB9</b> - T-Bar 9/16" <b>TB15</b> - T-Bar 15/16" <b>ST</b> - Screw slot t-bar <b>DF</b> - Drywall kit	<b>W</b> - Matte white <b>WA</b> - White antimicrobial Silverwerx	<b>FU120</b> - Fuse 120V <b>FU277</b> - Fuse 277V <b>CP</b> - Chicago Plenum <b>NA</b> - None

## CROSS SECTION

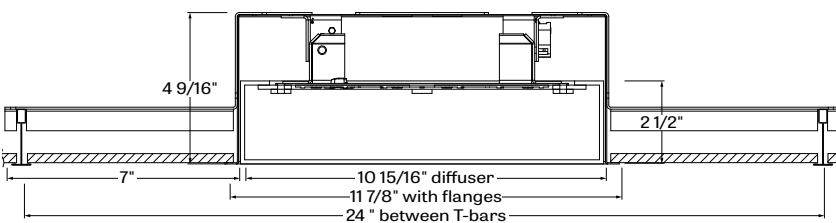

POSQR + FH - pop square recessed with flush lens

3737 Cote Vertu St-Laurent, Quebec, Canada H4R 2C9  
 T (514) 225-4304 F (514) 931-4862  
[www.lumenwerx.com](http://www.lumenwerx.com)



Lumenwerx reserves the right to modify product specifications without notification.  
 © Lumenwerx, ULC. All rights reserved.



POPRESSED11-SQUARE-RECESSED-SPEC-REV2.5- February 10, 2026

# POP RECESSED

SQUARE 1x1

STATIC WHITE, FULL SPECTRUM

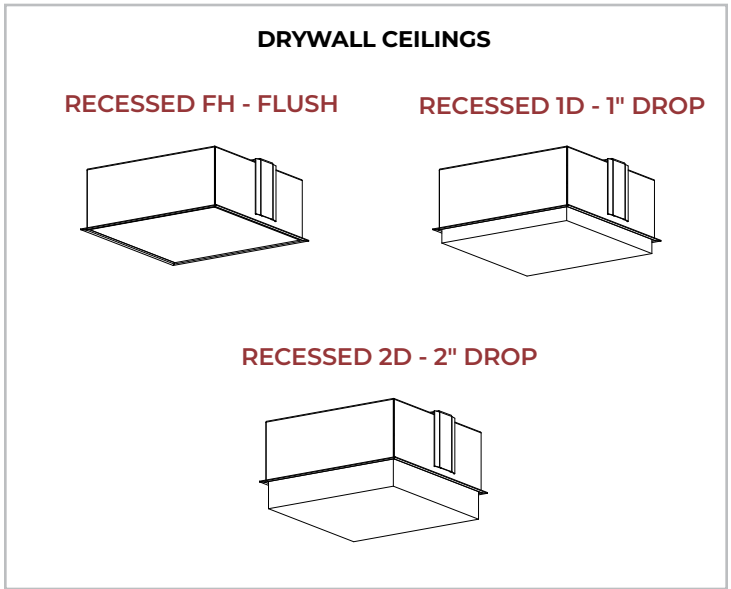
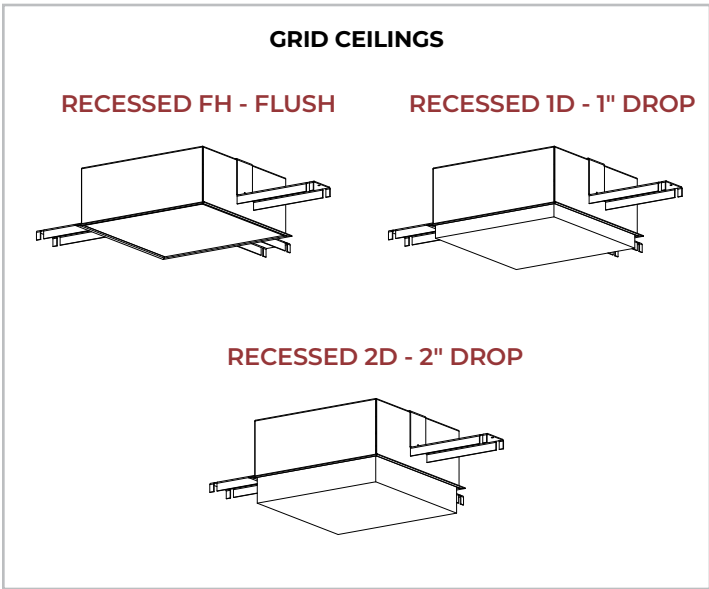

**POSQR- TC9** - tegular 9/16"

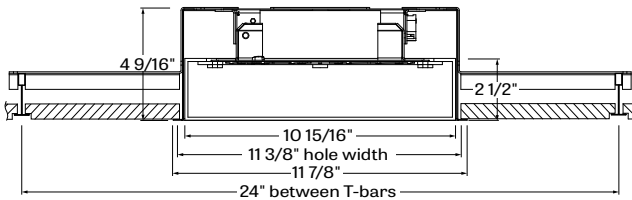

**POSQR- TB15** - t-bar 15/16"

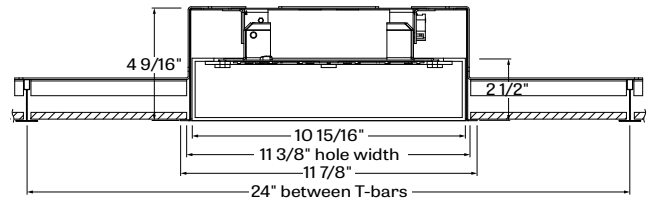

**POSQR- TG15** - tegular 15/16"

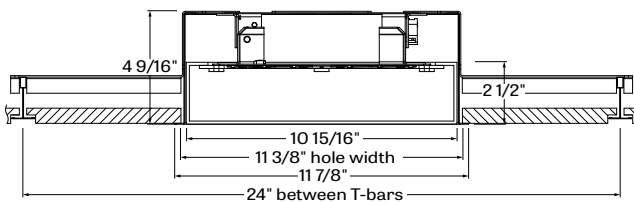

**POSQR- ST** - screw slot t-bar

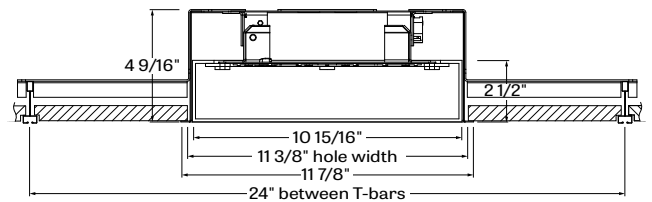

**POSQR- TB9** - t-bar 9/16"

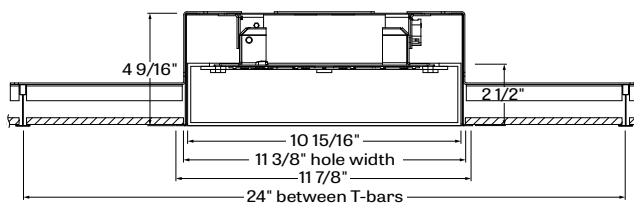

**POSQR- DF** - drywall kit

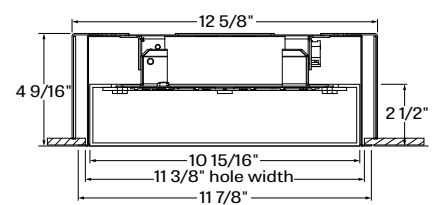

# POP RECESSED

SQUARE 1x1

STATIC WHITE, FULL SPECTRUM



## Photometrics

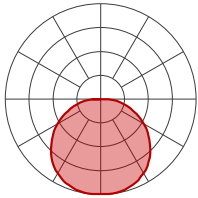

750 LUMEN AT 80 CRI - LOW OUTPUT

LED OUTPUT	COLOR TEMP	WATTS	NOMINAL DELIVERED LUMENS	EFFICACY LPW
Low output	2700K	8	750	95
Low output	3000K	8	750	97
Low output	3500K	7.5	750	100
Low output	4000K	7.5	750	103

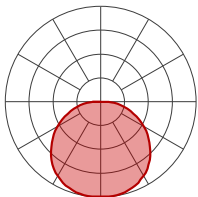

900 LUMEN AT 80 CRI - MEDIUM OUTPUT

LED OUTPUT	COLOR TEMP	WATTS	NOMINAL DELIVERED LUMENS	EFFICACY LPW
Medium output	2700K	9.5	900	95
Medium output	3000K	9.5	900	97
Medium output	3500K	9	900	100
Medium output	4000K	8.5	900	103

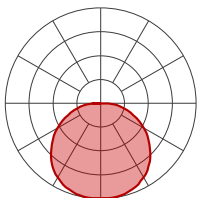

1100 LUMEN AT 80 CRI - HIGH OUTPUT

LED OUTPUT	COLOR TEMP	WATTS	NOMINAL DELIVERED LUMENS	EFFICACY LPW
High output	2700K	11.5	1100	95
High output	3000K	11.5	1100	97
High output	3500K	11	1100	100
High output	4000K	10.5	1100	103

# POP RECESSED

SQUARE 1x1

STATIC WHITE, FULL SPECTRUM



## Technical Specifications

### OPTICS

**UNIFORM EFFICIENCY LAMBERTIAN OPTIC (ULO)** - made of formed impact modified white PMMA, the optic provides an even light distribution with up to 88% transmission. Its unique enclosed shell design protects LEDs against Electrostatic Discharge and dust while its back surface project a soft glow on the mounting surface.

### DROP LENS

Pop square 11 recessed is available in 3 lens configurations.

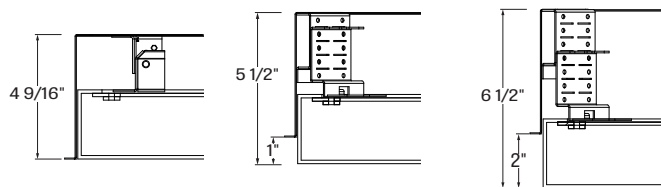

**POSQR + FH** -  
flush lens

**POSQR + 1D** -  
1" drop lens

**POSQR + 2D** -  
2" drop lens

### LIGHT SOURCE - STATIC WHITE

Custom array of mid-flux LEDs are mounted directly to the housing for optimal thermal performance. Available in 2700K, 3000K, 3500K and 4000K with a minimum 80 CRI and an option for 90 CRI with elevated R9 value. Color consistency maintained to within 3 SDCM. LEDs operated at reduced drive current to optimize efficacy and lumen maintenance.

All LEDs have been tested in accordance with IESNA LM-80-08 and the results have shown L80 lumen maintenance greater than 60,000 hours. Absolute product photometry is measured and presented in accordance with IESNA LM-79, unless otherwise indicated.

### LIGHT SOURCE - FULL SPECTRUM

The full spectrum LED option offers improved color particularly in the cyan region that is beneficial in both healthcare and circadian lighting strategies. The cyan region in full spectrum LED is richer at the 480 nm range.

### ELECTRICAL

Factory-set, adjustable output current LED driver with universal (120-277VAC) input. Dimmable from 100% to 1% with 0-10V dimming control. Rated life (90% survivorship) of 50,000 hours at 50°C max. ambient (and 70°C max. case) temperature. At maximum driver load: Efficiency > 84%, PF > 0.9, THD < 20%. Other specifiable options include Lutron Hi-Lume 1%, eldoLED 1% ECOdrive, eldoLED 0.1% SOLOdrive, and DALI protocol drivers. All of our standard 0-10V drivers are NEMA 410 compliant.

### PoE

Depending on the PoE manufacturer selected, Lumenwerx will install the node in factory as either integral to the luminaire or as a remote module. Factory programming of the PoE node may or may not enable the following functionalities: lumen package, Duo (tunable white), emergency battery backup, and sensor integration. These must be addressed and evaluated on a case-by-case basis.

### MOUNTING OPTIONS

Recess mount into exposed or concealed T-Bar or Tegular grid ceiling. A separate kit for mounting fixtures into drywall ceilings.

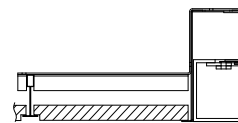

**TG9** - tegular 9/16"

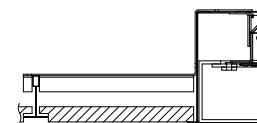

**TG15** - tegular 15/16"

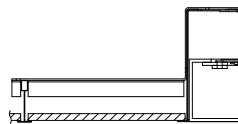

**TB9** - t-bar 9/16"

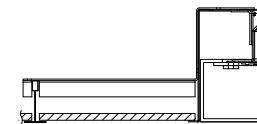

**TB15** - t-bar 15/16"

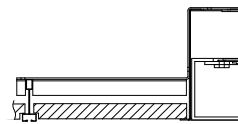

**ST** - screw slot t-bar

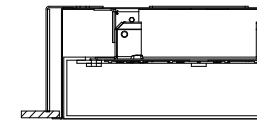

**DF** - drywall kit

### FINISH

**Interior** - 95% reflective, matte white powder coating

**Exterior** - matte white powder coating. Optional antimicrobial finish

### POP SEAL OPTION

The lens is gasketed and sealed, making the fixture suitable for healthcare applications. IP54 rated when specified with the drywall ceiling mounting option.

### CONSTRUCTION

**Housing** - 16 gauge spun aluminum, matte white powder coating

**Diffuser** - Uniform Lambertian optic, thermoformed impact modified acrylic, completely enclosed

**Gasket (Pop Seal)** - Closed-cell silicone foam gasket

### WEIGHT

**SQ 11 Flush, 1D, 2D** - 7.95lbs - 3.61kg

# POP RECESSED

SQUARE 1x1

STATIC WHITE, FULL SPECTRUM



## CERTIFICATIONS

**ETL** - Rated for Indoor Dry/Damp locations. Conforms to UL Standard 1598 and certified to CAN/CSA Standard C22.2 No. 250.0.

**Chicago plenum** - City of Chicago Approved (CCEA)

**IC rated** - suitable for direct contact with insulation.

**NSF** - NSF2 Listed for Non-Food Zones.

## WARRANTY

Lumenwerx provides a five-year limited warranty of electrical and mechanical performance of the luminaires, including the LED boards, drivers, and auxiliary electronics. Lumenwerx will repair or replace defective luminaires or components at our discretion, provided they have been installed and operated in accordance with our specifications. Other limitations apply, please refer to the full warranty on our website.