

RIM ROUND

PENDANT
STATIC WHITE

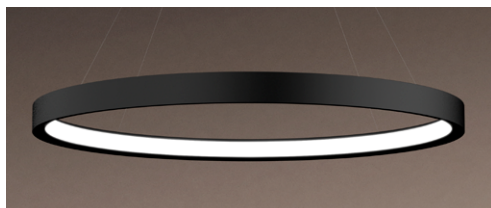

Project: _____
Type: _____



Rim Round



Rim Verso Round

DESCRIPTION

Available in eight standard sizes, from 24" to 144" diameter, Rim Round fixtures are decorative with a sleek profile suitable in any interior environment, especially when combined with general lighting, wall wash, and/or perimeter effects. Standard Rim Round is equipped with LED arrays illuminating inward from its circular housing. In contrast, Rim Verso Round fixtures are equipped with LED arrays illuminating outward from their housing. Certain smaller Rim Round sizes can be combined (two to three fixtures only) to form Rim Multiple Round luminaires. Similarly, certain smaller Rim Round sizes can be vertically mounted and as such are known as Rim Air Round fixtures. Rim Round nominal light output ranges from 2000 to 24000 lumens. It is also available with Chromawerx Sola, Duo, and Quadro (consult factory).

Up to 95 lm/W performance

Order Guide

LUMINAIRE ID	SIZE	OPTIC		LIGHT SOURCE ²	CRI	LUMEN PACKAGE				COLOR TEMP.	VOLTAGE
		ULO	SW			90CRI					
RIMRP - Rim Round Pendant	24IN - Ø 24" 36IN - Ø 36"	ULO - Uniform Lambertian Optic	SW - Static white	90CRI - 90 CRI	² Chromawerx SOLA, DUO, and QUADRO also available. Consult other spec sheet.	Low	Medium	High	27K - 2700K	120V - 120V	
RIMVRP - Rim Verso Round Pendant	48IN - Ø 48"					2000LM	3000LM	4000LM	30K - 3000K	277V - 277V	
	60IN - Ø 60"					3000LM	4500LM	6000LM	35K - 3500K	UNV -	
	72IN - Ø 72"					4000LM	6000LM	8000LM	40K - 4000K	120V-277V	
	96IN ¹ - Ø 96"					5000LM	7500LM	10000LM		347 ³ -347V	
	120IN ¹ - Ø 120"					6000LM	9000LM	12000LM			
	144IN ¹ - Ø 144"					8000LM	12000LM	16000LM			
		10000LM	15000LM	20000LM							
		12000LM	18000LM	24000LM							

¹Shipped in separate pieces.

³Available with D1 driver only.

REMOTE DRIVER ⁴	ELECTRICAL ⁶	MOUNTING				FINISH	
	1C						
DI - 1% 0-10V DA ⁵ - DALI LDEI ⁵ - Lutron Hi-Lume 1% Eco ELDI - eldoLED 1% ECOdrive 0-10V ELDO - eldoLED0.1% SOLOdrive 0-10V	1C - 1 circuit ⁶ For other circuit configurations, consult factory.	DRIVER BOX ⁷ RCD ^{8,9} - Round canopy driver box RDB ¹⁰ - Remote driver box ⁷ For more information see page 4. ⁸ With single canopy option, not available for lumen packages over 6000 lm (3500 lm for Lutron driver options). ⁹ Not available with 347V. ¹⁰ Multiple remote driver boxes may be necessary for lumen packages higher than 10000 lm.	CANOPY FINISH W - Matte white AL - Aluminum B - Matte black CF - Custom finish, specify RAL#	POWER POC - Integrated suspension power-over-aircraft cable BAC - Black power cord + aircraft cable WAC - White power cord + aircraft cable	MOUNTING POINTS SC ¹¹ - Single canopy MC ^{12,13} - Multiple canopies ¹¹ Available up to 72" only. ¹² 4 Canopies provided. ¹³ With the RCD option, the type of each canopy may differ based on the selected lumen package and driver options. Consult factory for details.	MOUNTING CABLE LENGTH ¹⁴ 18IN - 18" 24IN - 24" 36IN - 36" 48IN - 48" 60IN - 60" 72IN - 72" 96IN - 96" 120IN - 120" ##IN - Specify nominal length in inches ¹⁴ For single canopy option, the minimum required mounting heights are (distance from ceiling to top of fixture in inches):	W - Matte white AL - Aluminum B - Matte black CF - Custom finish, specify RAL#
See website for the Pendant Mounting Guide							

Fixture size	Minimum height
Ø 24"	min height 15"
Ø 36"	min height 22"
Ø 48"	min height 29"
Ø 60"	min height 36"
Ø 72"	min height 43"

RIM ROUND



PENDANT
STATIC WHITE

Dimensions

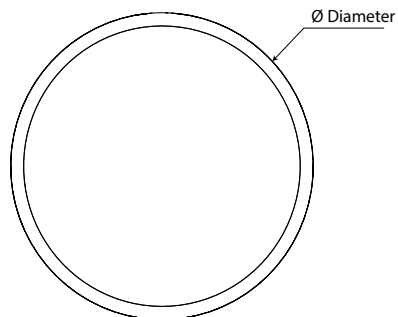

	Ø Diameter	
	ROUND	VERSO
24"	Ø 24 1/4"	Ø 24
36"	Ø 35 5/8"	Ø 36"
48"	Ø 48"	Ø 48"
60"	Ø 60 7/16"	Ø 60"
72"	Ø 72 5/8"	Ø 72"
96"	Ø 96 5/8"	Ø 96"
120"	Ø 120 5/8"	Ø 120"
144"	Ø 144 5/8"	Ø 144"

RIMRP - Rim Round Pendant

SECTION VIEW

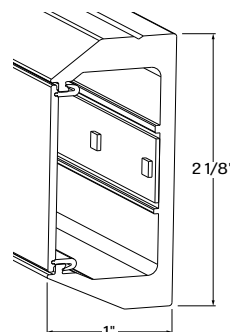

RIMRP - Rim Round Pendant

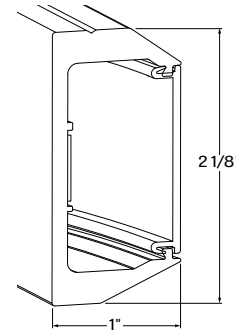

RIMVRP - Rim Verso Round Pendant

Photometrics

RIMRP - RIM ROUND PENDANT

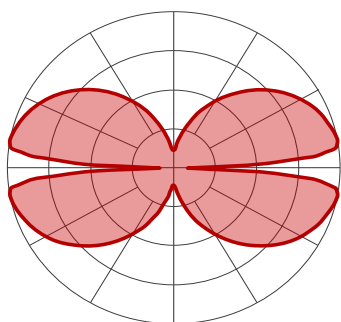

Delivered lumens at 40K at 90 CRI

Multiplier @ 90 CRI

CCT (K)	Watts	LPW
2700	1.08	0.92
3000	1.05	0.96
3500	1.02	0.98
4000	1.00	1.00

Ø 24"

LED output	WATTS	NOMINAL DELIVERED LUMENS	LPW
Low	22.2	2000	90
Medium	34.6	3000	87
High	47.7	4000	84

Ø 48"

LED output	WATTS	NOMINAL DELIVERED LUMENS	LPW
Low	44.5	4000	90
Medium	69.2	6000	87
High	95.4	8000	84

Ø 72"

LED output	WATTS	NOMINAL DELIVERED LUMENS	LPW
Low	66.7	6000	90
Medium	103.9	9000	87
High	143.2	12000	84

Ø 120"

LED output	WATTS	NOMINAL DELIVERED LUMENS	LPW
Low	111.1	10000	90
Medium	173	15000	87
High	238.6	20000	84

Ø 36"

LED output	WATTS	NOMINAL DELIVERED LUMENS	LPW
Low	33.4	3000	90
Medium	52	4500	87
High	71.7	6000	84

Ø 60"

LED output	WATTS	NOMINAL DELIVERED LUMENS	LPW
Low	55.6	5000	90
Medium	86.2	7500	87
High	119.3	10000	84

Ø 96"

LED output	WATTS	NOMINAL DELIVERED LUMENS	LPW
Low	88.9	8000	90
Medium	138.5	12000	87
High	190.9	16000	84

Ø 144"

LED output	WATTS	NOMINAL DELIVERED LUMENS	LPW
Low	13.3	12000	90
Medium	206.9	18000	87
High	285.7	24000	84

RIM ROUND



PENDANT
STATIC WHITE

RIMVRP - RIM VERSO ROUND PENDANT

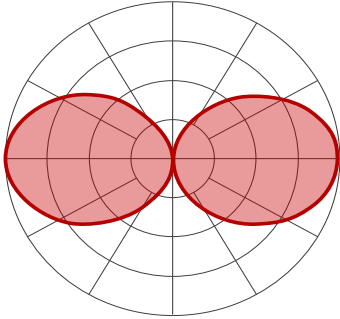

Delivered lumens at 40K at 90 CRI

Multiplier @ 90 CRI

CCT (K)	Watts	LPW
2700	1.08	0.92
3000	1.05	0.96
3500	1.02	0.98
4000	1.00	1.00

Ø 24"

LED output	WATTS	NOMINAL DELIVERED LUMENS	LPW
Low	21	2000	95
Medium	32.9	3000	91
High	45.3	4000	88

Ø 48"

LED output	WATTS	NOMINAL DELIVERED LUMENS	LPW
Low	42.1	4000	95
Medium	65.7	6000	91
High	90.6	8000	88

Ø 72"

LED output	WATTS	NOMINAL DELIVERED LUMENS	LPW
Low	63.2	6000	95
Medium	98.6	9000	91
High	135.9	12000	88

Ø 36"

LED output	WATTS	NOMINAL DELIVERED LUMENS	LPW
Low	31.6	3000	95
Medium	49.5	4500	91
High	68.2	6000	88

Ø 60"

LED output	WATTS	NOMINAL DELIVERED LUMENS	LPW
Low	52.6	5000	95
Medium	82.1	7500	91
High	113.2	10000	88

RIM ROUND

PENDANT
STATIC WHITE

Mounting Options

RCD - ROUND CANOPY DRIVER BOX

SC - SINGLE CANOPY

MC - MULTIPLE CANOPY

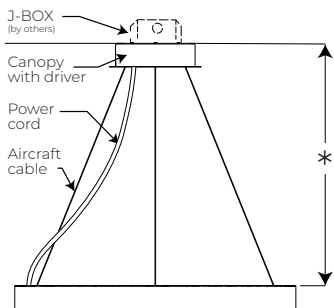

AC - Aircraft cable

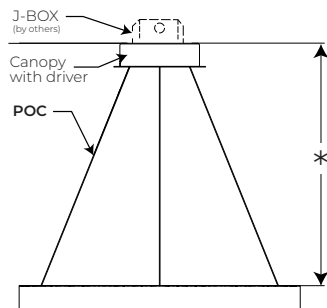

POC - Power-over-aircraft cable

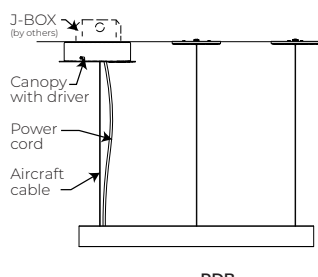

AC - Aircraft cable

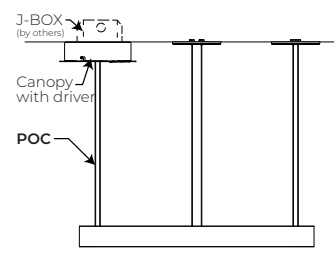

POC - Power-over-aircraft cable

RDB - REMOTE DRIVER BOX

SC - SINGLE CANOPY

MC - MULTIPLE CANOPY

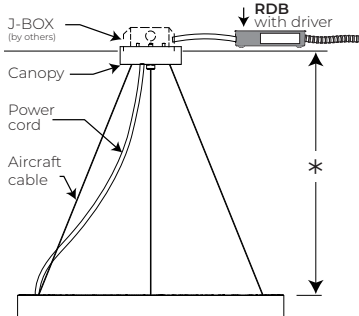

AC - Aircraft cable

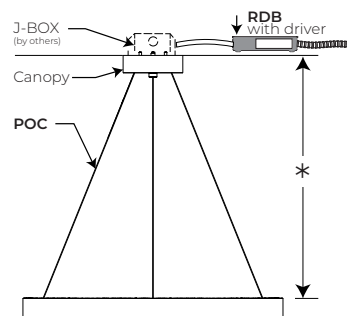

POC - Power-over-aircraft cable

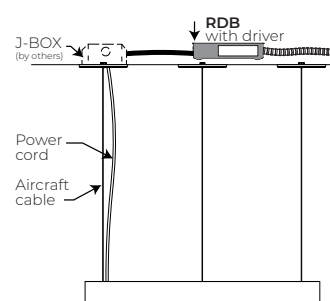

AC - Aircraft cable

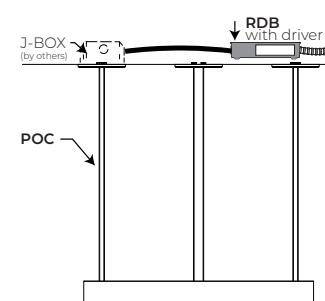

POC - Power-over-aircraft cable

*minimum height

For single canopy option, the minimum required mounting heights:

Fixture size	* Minimum height
Ø 24"	min height 15"
Ø 36"	min height 22"
Ø 48"	min height 29"
Ø 60"	min height 36"
Ø 72"	min height 43"

RIM ROUND



PENDANT
STATIC WHITE

Technical Specifications

OPTIC

Uniform Lambertian Optic (ULO) - Thermoformed from impact-modified white PMMA, the ULO provides even luminosity, with up to 88% transmission. Combined with the LED array running around the inside of the housing, the open form and ULO create a widespread 50% direct and 50% indirect light distribution with spacing criteria of 1.6.

LIGHT SOURCE

Custom array of mid-flux LEDs are mounted directly to the housing for optimal thermal performance. Available in 2700K, 3000K, 3500K and 4000K with 90 CRI and elevated R9 value. Color consistency is maintained to 3 SDCM. LEDs are operated at a reduced drive current to optimize efficacy and lumen maintenance. All LEDs have been tested in accordance with IESNA LM-80-08 and results have shown L80 lumen maintenance are greater than 60,000 hours. Absolute product photometry is measured and presented in accordance with IESNA LM-79, unless otherwise indicated.

JOINER

For sizes that are shipped in separate pieces, all sections are joined together on site using pre-installed die cast joiners.

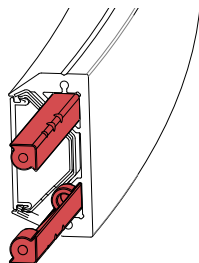

ELECTRICAL

Factory-set, adjustable output current LED driver with universal (120-277VAC) input. Dimmable from 100% to 1% with 0-10V dimming control. Rated life (90% survivorship) of 50,000 hours at 50°C max. ambient (and 70°C max. case) temperature. At maximum driver load: Efficiency > 84%, PF > 0.9, THD < 20%. Other specifiable options include Lutron Hi-Lume 1% Eco, eldoLED 1% ECOdrive 0-10V, eldoLED 0.1% SOLOdrive 0-10V, and DALI protocol drivers. All of our standard 0-10V drivers are NEMA 410 compliant.

PoE

Depending on the PoE manufacturer selected, Lumenwerx will install the node in factory as either integral to the luminaire or as a remote module. Factory programming of the PoE node may or may not enable the following functionalities: lumen package, Duo (tunable white), Quadro (RGBW), emergency battery backup, and sensor integration. These must be addressed and evaluated on a case-by-case basis.

FINISH

Interior - 95% reflective, matte white powder coating
Exterior - Matte white, matte black or aluminum powder coating. Custom finishes are also available.

CONSTRUCTION

Housing - Rolled and seamlessly welded aluminum extrusion, wide variety of colored powder coating
Diffuser - Uniform Lambertian optic, co-extruded flexible polycarbonate satine finished lens

WEIGHT

Ø 24" - 5lbs - 2.2kg
Ø 36" - 7.5lbs - 3.4kg
Ø 48" - 10lbs - 4.5kg
Ø 60" - 12.5lbs - 5.6kg
Ø 72" - 15lbs - 6.8kg
Ø 96" - 20.1lbs - 9.1kg
Ø 120" - 25.1lbs - 11.3kg
Ø 144" - 30.1lbs - 13.6kg

CERTIFICATION

ETL - Rated for Indoor Dry/Damp locations. Conforms to UL Standard 1598 and certified to CAN/CSA Standard C22.2 No. 250.0.

WARRANTY

Lumenwerx provides a five-year limited warranty of electrical and mechanical performance of the luminaires, including the LED boards, drivers, and auxiliary electronics. Lumenwerx will repair or replace defective luminaires or components at our discretion, provided they have been installed and operated in accordance with our specifications. Other limitations apply, please refer to the full warranty on our website.