

SQUERO

RECESSED

STATIC WHITE, BIOS



Declare.



DESCRIPTION

Squero brings style and flexibility to linear lighting systems. Less than 2" wide, Squero offers a variety of optics, each providing a different visual texture, as well as photometric performance. Optional modules are also available for accent lighting. Squero can be installed as individual luminaires or in continuous runs. See separate spec sheets for Combinations and Patterns, where multiple optics can be combined in a single fixture.

SENSORS
For latest information on sensors, click [here](#).



Up to 130 lm/W performance

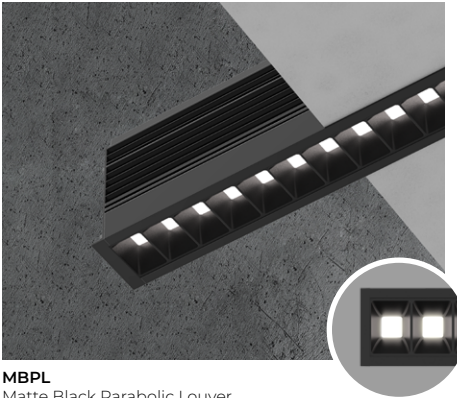

MBPL
Matte Black Parabolic Louver

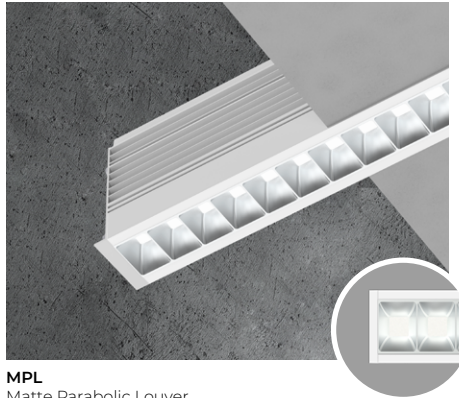

MPL
Matte Parabolic Louver

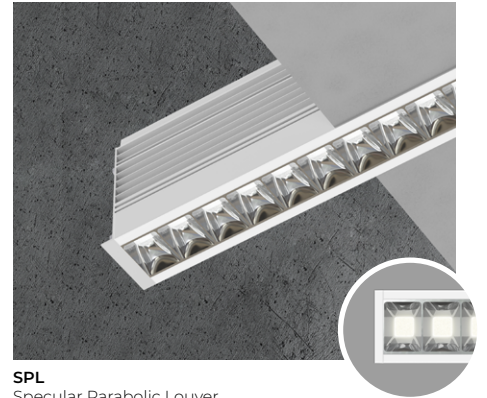

SPL
Specular Parabolic Louver

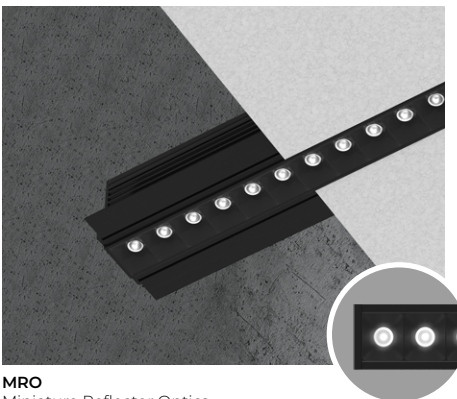

MRO
Miniature Reflector Optics

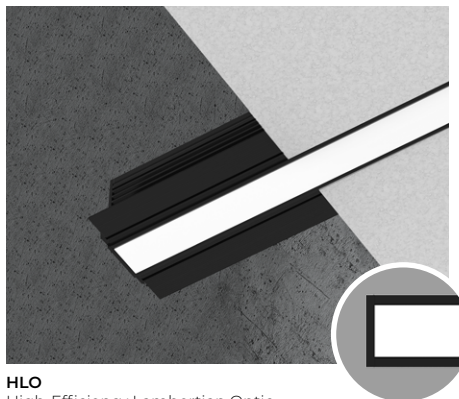

HLO
High-Efficiency Lambertian Optic

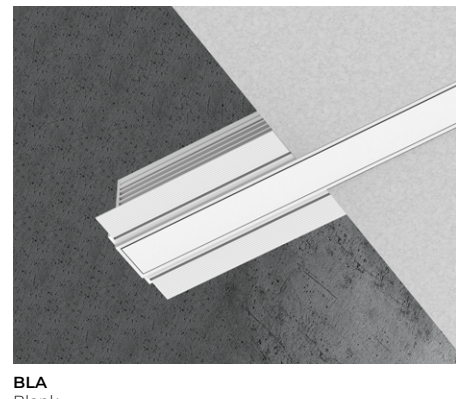

BLA
Blank

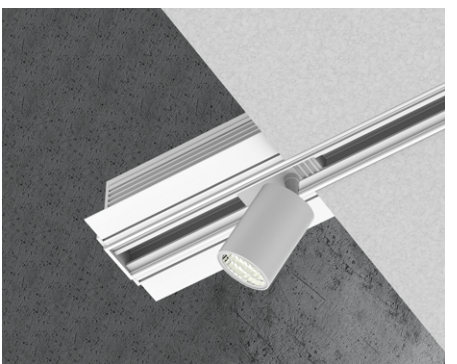

ITRLMX, ITR
Integrated Track

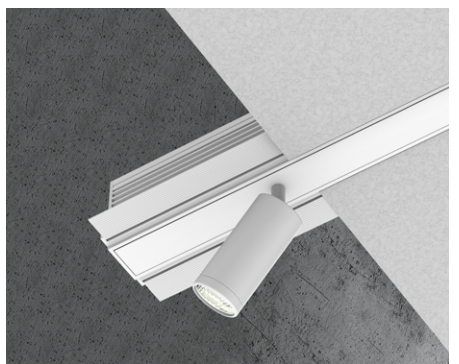

AAM
Adjustable Accent Module

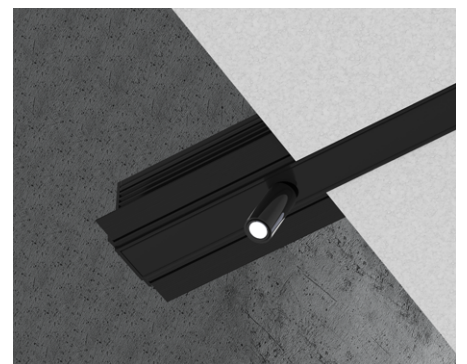

MS
Micro Spot Module

SQUERO

RECESSED
STATIC WHITE, BIOS



Project: _____

Type: _____

Order Guide

| LUMINAIRE ID | DISTRIBUTION | OPTIC | MRO COLOR | LIGHT SOURCE ⁸ | CRI | |
|---|--|--|--|---|---|--|
| SQUR | D | | | | | |
| SQUR - Squero Recessed | D - Direct | MRO18 ¹ - 18 degree Miniature Reflector Optic MRO35 ¹ - 35 degree Miniature Reflector Optic MRO55 ¹ - 55 degree Miniature Reflector Optic MBPL ² - Matte Black Parabolic Louver MPL ² - Matte Parabolic Louver SPL ² - Specular Parabolic Louver HLO - High-Efficiency Lambertian Optic BLA ³ - Blank NA ⁴ - Not applicable ¹ Not available with BIOS ² Not available with BIOSTU. ³ Specify with AAM or Micro Spot option. ⁴ Specify when only the track option is required. ⁵ Specify track length (#) in 1' and/or 1" increments. ⁶ Track by others and installed by Lumenwerx. Consult factory. | <u>Track option (optional)</u> +ITRLMX(#FT#IN) ⁵ - Integrated track by Lumenwerx +ITR(#FT#IN) ^{5,6} - Integrated track by others ⁷ Only available with MRO optics. | WH ⁷ - White BK ⁷ - Black NA - Not applicable SW - Static white BIOSSST ⁹ - BIOS Biological Static BIOSDY ⁹ - BIOS Biological Dynamic BIOSTU ⁹ - BIOS Biological Tunable ⁸ Chromawerx SOLA and DUO, and also available. Consult other spec sheet. ⁹ See page 7 for details. | 80CRI - 80+ CRI 90CRI ¹⁰ - 90+ CRI ¹⁰ Not available with BIOS. | |
| LUMEN PACKAGE Specify NA for Blank | | COLOR TEMP. | LUMINAIRE LENGTH | VOLTAGE | DRIVER ¹⁶ | |
| 350LMF - Eco low output 350 lm/ft 500LMF - Low output 500 lm/ft 750LMF - Medium output 750 lm/ft 1000LMF ^{11,12} - High output 1000 lm/ft NA - Not applicable ¹¹ Not available with MBPL optic. ¹² Not available with BIOS. | | 27K ¹³ - 2700K 30K - 3000K 35K - 3500K 40K - 4000K 50K ¹³ - 5000K ¹³ Not available with BIOS. | #FT#IN ¹⁴ - Specify nominal length (#) in 1' and/or 1" increments Standard nominal lengths: Single units: 2' to 12' Continuous runs: lengths over 12' ¹⁴ MROs are available in 6" increments, Parabolic Louvers in 1" increments, HLO and Blank in 1" increments. | 120V - 120V 277V - 277V UNV - 120V-277V 347V ¹⁵ - 347V ¹⁵ Available with D1 driver only. | D1 - 1% 0-10V ELV ¹⁷ - ELV 120V TRI ¹⁷ - TRIAC 120V DA ¹⁸ - DALI LDE1 ¹⁸ - Lutron Hi-lume 1% Eco ELD1 - eldoLED 1% ECOdrive 0-10V ELDO - eldoLED 0.1% SOLOdrive 0-10V ¹⁶ PoE (Power-over-Ethernet) compatible. Consult factory for details. ¹⁷ Available with 120V only. ¹⁸ On-site commissioning is required. | |
| ELECTRICAL | ELECTRICAL SECTIONS (optional) ^{22,23} | | MOUNTING ²⁸ | FINISH ³⁰ | | |
| 1C - 1 circuit #MC ¹⁹ - Multi circuit EC - Emergency-powered fixture NL - Night light fixture DL - Daylight fixture GTD ^{20,21} - Generator transfer device fixture ¹⁹ Specify total number of circuits (#), including any required for electrical section or module options. Provide drawing or layout specifications. Minimum 4' section per circuit. ²⁰ Minimum 4' fixture. ²¹ Not available with 347V. | #EC## ²⁴ - Emergency-powered section #NL## ²⁴ - Night light section #DL## ²⁴ - Daylight section #GTD## ^{24,25,26} - Generator transfer device section #EMB ^{26,27} - Emergency battery NA - None ²² Specify with multi circuit (#MC) electrical option only. ²³ Provide drawing or layout specifications. Consult factory for other configurations. Default section length is 4'. ²⁴ Specify quantity (#), and section length in inches (##). ²⁵ Minimum 4' section. ²⁶ Not available with 347V. ²⁷ Specify quantity (#). All batteries will be on the same circuit. Each battery powers a 4' section. | | TG9 - Tegular 9/16" TG15 - Tegular 15/16" TB9 - T-bar 9/16" TB15 - T-bar 15/16" ST - Screw slot T-bar DTR - Trim DTL - Trimless DMF - Drywall mud flange MFM ²⁹ - Multiple flange mounting ²⁸ Transition mounting options also available (e.g. Recessed to Pendant/Surface), consult factory for details. ²⁹ See page 4 for details. | W - Matte white AL - Aluminum B - Matte black CF# - Custom finish, specify RAL# ³⁰ Blank finish will match fixture finish. | | |
| CONTROL ³¹ | OPTIONS ³⁷ | | MODULE (optional) ^{39,40} | | | |
| STANDALONE CONTROLS ^{32,33} Specify the quantity (#) of sensors per fixture. #OMS ³⁴ - Onboard Occupancy #OMS## ³⁵ - Onboard Occupancy with bi-level dimming #ODS - Onboard Daylight #OCS - Onboard Occupancy & Daylight NA - None ³¹ Standalone and connected control options cannot be combined. ³² Available with D1 driver and 1 circuit options only. ³³ Minimum 4' per zone. Provide control zone length. | CONNECTED CONTROLS ³⁶ LU - Lutron AWNR - Lutron Athena Wireless Node RF Only AWNS - Lutron Athena Wireless Node Sensor ENC - Encelium WL - Cooper Wavelinx AN - Acuity nLight CA - Casambi LG - Legrand ³⁴ Fixture turns off when no occupancy. ³⁵ Fixture dims to specified light level % (##). ³⁶ Consult factory for connected controls. | | FU120 - Fuse 120V FU277 - Fuse 277V NEF ³⁸ - No end flanges FWC - Flexible whip cable (6' std) NA - None ³⁷ Separate codes with a "+" if more than one is specified. ³⁸ For wall-to-wall installations. | #AAM21() - AAM 21° #AAM30() - AAM 30° #AAM36() - AAM 36° #MS25() - Micro Spot 25° #MS35() - Micro Spot 35° #MS50() - Micro Spot 50° NA - None ³⁹ See page 3 for ordering details. ⁴⁰ Not available with ELV/TRI driver options. | | |



SQUERO



RECESSED

STATIC WHITE, BIOS

Module Code

For a module, specify the options in the parentheses.
The light source is static white.
CRI of module matches specification of main fixture.

Examples: 1AAM21(5W-35K-W-NA)

1MS25(5W-27K-W)

| MODULE (optional) | | | | |
|--|--|--|--|---|
| MODULE ^{1,2} | WATTAGE | COLOR TEMPERATURE | FINISH | OPTION |
| #AAM21() - AAM 21° #AAM30() - AAM 30° #AAM36() - AAM 36° ¹ Specify quantity (#). ² 6" blank per module. Blank finish will match fixture finish. | 5W - 5 W, up to 364 lm output 8W - 8 W, up to 624 lm output | 27K - 2700K 30K - 3000K 35K - 3500K 40K - 4000K 50K - 5000K | W - Matte white B - Matte black | HCL - Honeycomb louver NA - None |
| MODULE ^{1,2} | WATTAGE | COLOR TEMPERATURE | FINISH | |
| #MS25() - Micro Spot 25° #MS35() - Micro Spot 35° #MS50() - Micro Spot 50° ¹ Specify quantity (#). ² 6" blank per module. Blank finish will match fixture finish. | 5W - 5 W, up to 430 lm output | 27K - 2700K 30K - 3000K 35K - 3500K 40K - 4000K 50K - 5000K | W - Matte white B - Matte black | |

Dimensions

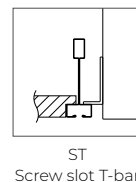
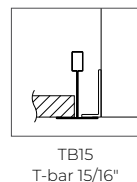
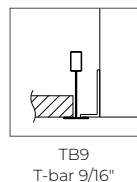
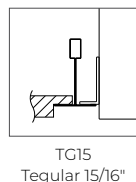
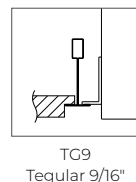
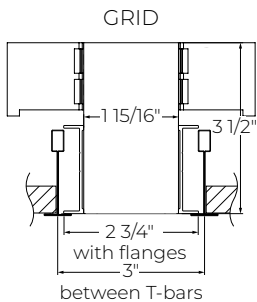
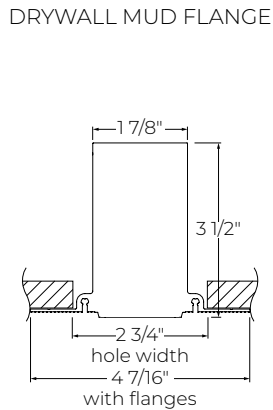
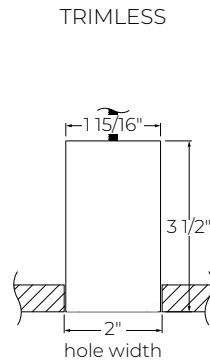
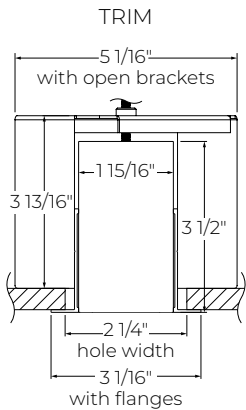

SQUERO

RECESSED

STATIC WHITE, BIOS



Multiple Flange Mounting Details

Multiple flange mounting can be specified when a fixture run needs to have a multiple flange recessed mounting detail. A drawing is required to clearly illustrate the application.

CEILING CONDITION EXAMPLES (consult factory for project specific ceiling conditions)

DRYWALL/GRID

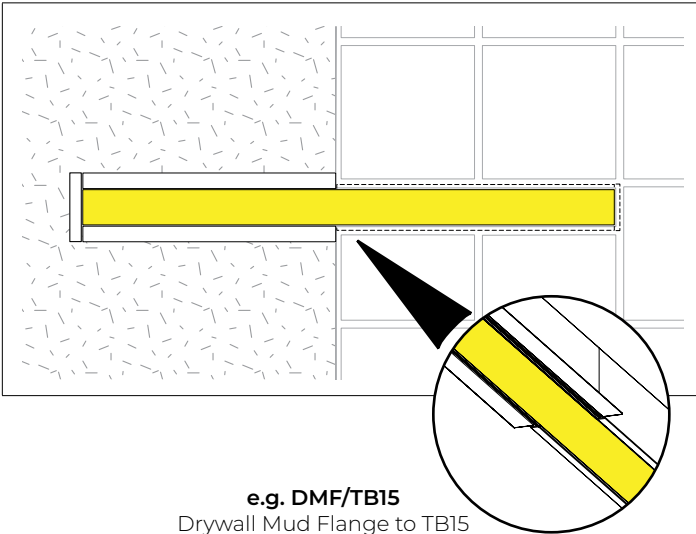

e.g. DMF/TB15
Drywall Mud Flange to TB15

DRYWALL/WOOD

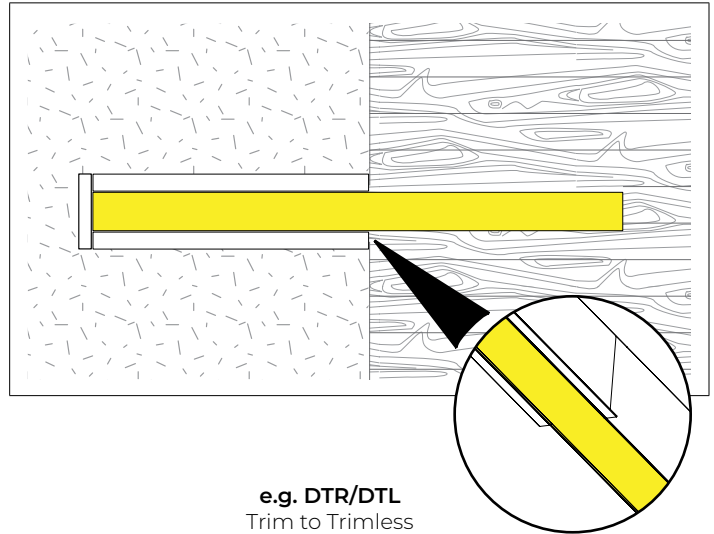

e.g. DTR/DTL
Trim to Trimless

DRYWALL/GRID

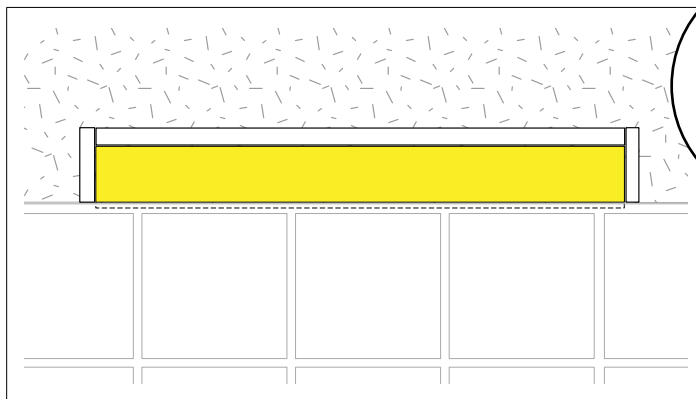

e.g. 1TC9/3DTR
1 long side TC9 and other
3 sides DTR

All drawings are for illustrative purposes only.

TRANSITION MOUNTING OPTIONS (consult factory for details)

Mounting condition alters along the run of the fixture.

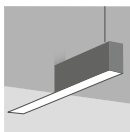

Recessed to Pendant

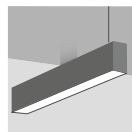

Surface to Pendant

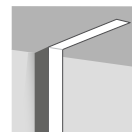

Surface to Recessed in corner

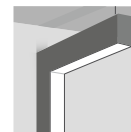

Surface to Pendant in corner

SQUERO



RECESSED
STATIC WHITE, BIOS

Photometrics

Values calculated based on a 4' fixture at 3500K and 80+ CRI for all optics.

MRO18

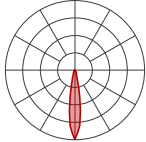

| LM/FT | W/FT | LM/W |
|-------|------|------|
| 350 | 2.7 | 130 |
| 500 | 4.0 | 125 |
| 750 | 6.4 | 118 |
| 1000 | 9.1 | 110 |

MRO35

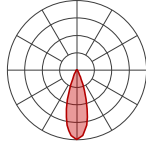

| LM/FT | W/FT | LM/W |
|-------|------|------|
| 350 | 2.9 | 121 |
| 500 | 4.3 | 116 |
| 750 | 6.9 | 108 |
| 1000 | 9.9 | 101 |

MRO55

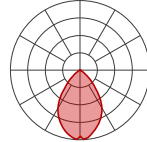

| LM/FT | W/FT | LM/W |
|-------|------|------|
| 350 | 3.2 | 109 |
| 500 | 4.8 | 104 |
| 750 | 7.7 | 97 |
| 1000 | 11.0 | 91 |

HLO

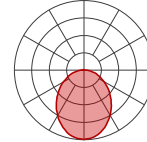

| LM/FT | W/FT | LM/W |
|-------|------|------|
| 350 | 3.1 | 112 |
| 500 | 4.6 | 108 |
| 750 | 7.3 | 103 |
| 1000 | 10.2 | 98 |

MBPL

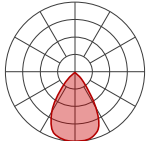

| LM/FT | W/FT | LM/W |
|-------|------|------|
| 350 | 5.2 | 67 |
| 500 | 7.5 | 66 |
| 750 | 11.7 | 64 |

MPL

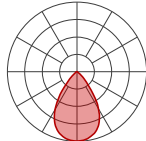

| LM/FT | W/FT | LM/W |
|-------|------|------|
| 350 | 3.5 | 99 |
| 500 | 5.1 | 98 |
| 750 | 7.7 | 98 |
| 1000 | 10.6 | 95 |

SPL

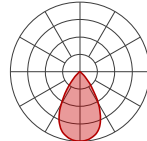

| LM/FT | W/FT | LM/W |
|-------|------|------|
| 350 | 3.1 | 113 |
| 500 | 4.4 | 113 |
| 750 | 6.7 | 112 |
| 1000 | 9.1 | 109 |

MULTIPLIER TABLES - CCT/CRI

Use these tables to get results for different color temperatures and CRI for all photometric tables.

MRO18 / MRO35 / MRO55

| CCT | WATTS | | LPW | |
|-------|---------|---------|---------|---------|
| | 80+ CRI | 90+ CRI | 80+ CRI | 90+ CRI |
| 2700K | 1.04 | 1.19 | 0.96 | 0.84 |
| 3000K | 1.00 | 1.15 | 1.00 | 0.87 |
| 3500K | 1.00 | 1.12 | 1.00 | 0.89 |
| 4000K | 0.99 | 1.10 | 1.01 | 0.91 |
| 5000K | 0.94 | 1.06 | 1.06 | 0.94 |

MBPL / MPL / SPL

| CCT | WATTS | | LPW | |
|-------|---------|---------|---------|---------|
| | 80+ CRI | 90+ CRI | 80+ CRI | 90+ CRI |
| 2700K | 1.04 | 1.19 | 0.96 | 0.84 |
| 3000K | 1.00 | 1.15 | 1.00 | 0.87 |
| 3500K | 1.00 | 1.12 | 1.00 | 0.89 |
| 4000K | 0.99 | 1.10 | 1.01 | 0.91 |
| 5000K | 0.94 | 1.06 | 1.06 | 0.94 |

HLO

| CCT | WATTS | | LPW | |
|-------|---------|---------|---------|---------|
| | 80+ CRI | 90+ CRI | 80+ CRI | 90+ CRI |
| 2700K | 1.05 | 1.27 | 0.95 | 0.79 |
| 3000K | 1.02 | 1.23 | 0.98 | 0.81 |
| 3500K | 1.00 | 1.19 | 1.00 | 0.84 |
| 4000K | 1.00 | 1.19 | 1.00 | 0.84 |
| 5000K | 0.96 | 1.12 | 1.04 | 0.89 |

SQUERO

RECESSED
STATIC WHITE, BIOS



AAM MODULE

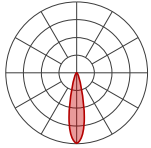

AAM 21°

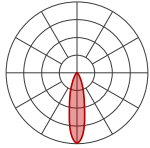

AAM 30°

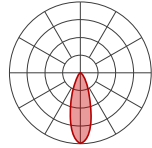

AAM 36°

DELIVERED LUMENS

| Wattage | 5.0 | | | | | | | | | |
|---------|-------|-------|-------|-------|-------|-------|-------|-------|-------|-------|
| CRI | 80+ | | | | | 90+ | | | | |
| CCT | 2700K | 3000K | 3500K | 4000K | 5000K | 2700K | 3000K | 3500K | 4000K | 5000K |
| Lumen | 323 | 340 | 350 | 357 | 364 | 265 | 279 | 289 | 299 | 312 |
| Wattage | 8.0 | | | | | | | | | |
| CRI | 80+ | | | | | 90+ | | | | |
| CCT | 2700K | 3000K | 3500K | 4000K | 5000K | 2700K | 3000K | 3500K | 4000K | 5000K |
| Lumen | 553 | 583 | 600 | 612 | 624 | 454 | 478 | 495 | 513 | 534 |

MICRO SPOT MODULE

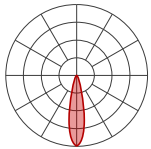

Micro Spot 25°

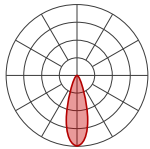

Micro Spot 35°

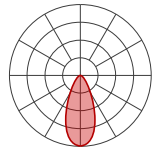

Micro Spot 50°

DELIVERED LUMENS

| Wattage | 5.0 | | | | | | | | | |
|---------|-------|-------|-------|-------|-------|-------|-------|-------|-------|-------|
| CRI | 80+ | | | | | 90+ | | | | |
| CCT | 2700K | 3000K | 3500K | 4000K | 5000K | 2700K | 3000K | 3500K | 4000K | 5000K |
| Lumen | 373 | 400 | 400 | 432 | 432 | 324 | 344 | 344 | 345 | 372 |

BIOS

Three BIOS Circadian LED solutions are offered – Biological Static, Biological Dynamic, and Biological Tunable. Use the decision tree below to identify when and where to use BIOS Wellness LED Lighting Solutions.

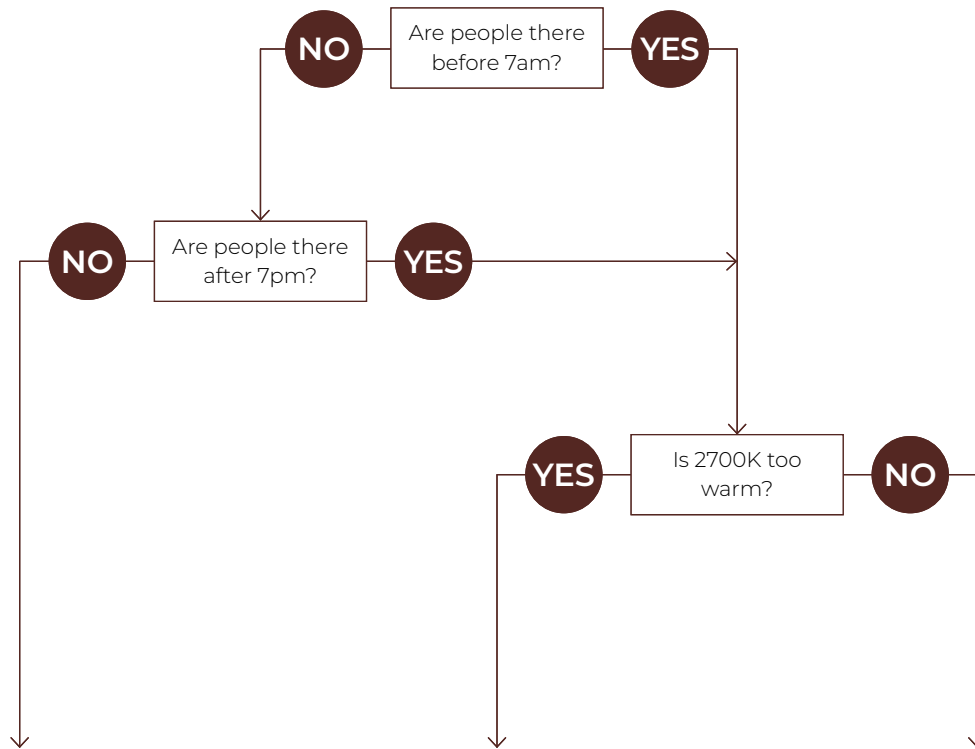

| Biological Static BIOSST | Biological Dynamic BIOSDY | Biological Tunable BIOSTU |
|---|---|---|
| No CCT change when dimmed | 500K shift when dimmed | Dims to 2700K |
| Daytime solution | Daytime + evening solution | Daytime + evening solution |
| Spaces in operation during daytime hours, between 7am and 7pm | Spaces in operation overnight, after 7pm and before 7am, and when CCT color shift in the evening is not preferred | Suitable for spaces in operation overnight, after 7pm and before 7am, and where people do not sleep (CCT color shift in the evening is preferred) |
| E.g. offices, medical/dental offices | E.g. hospitals | E.g. offices, shiftwork |
| | | |

Technical Specifications

OPTICS

Miniature Reflector Optic (MRO)

Locates individual, precisely molded TIR elements over each LED emitter, and further shield the source with precise parabolic reflectors. The controlled beam is remarkably comfortable – especially in a small LED luminaire.

MRO is available in a specular black or gloss white finish and creates a distinctive visual texture.

Different TIR elements offer a choice of beam spreads: narrow (18° with SC of 0.3), medium (35° with SC of 0.6), and wide (55° with SC of 0.9). These concentrated distributions can provide effective task illumination in a variety of applications.

Each MRO module is 6" long with five optical chambers.



Parabolic Louvers (MBPL, MPL & SPL)

Parabolic Louver Optics provide excellent shielding and a pleasing crisp visual texture. The precisely molded louvers consist of 1" deep blades and side reflectors with shielding of 50° lengthwise and 45° crosswise.

The parabolic contour of the blades and side reflectors direct light into a comfortable downlight distribution with a spacing criterion of 1.1, while minimizing shadows from the LED array above each cell.

Three finishes are available: matte black, matte, and specular. Specular (SPL) provides higher efficacy, sharper cut-off, and an ultra quiet appearance at shallow viewing angles. Matte (MPL) offers a softer appearance, a wider beam spread, and gentle brightness transition at cut-off. Matte black (MBPL) offers the lowest UGR in Squero as the black parabolic louver is very quiet and glare free. The UGR is the best in class rating of under 10.



High-Efficiency Lambertian Optic (HLO)

The High-Efficiency Lambertian Optic (HLO) shielding of diffusing 0.075" thick acrylic with up to 88% transmission and good source obscuration is combined with matte white side reflectors to create an efficient optical chamber with uniform luminosity.

Luminaire brightness is controlled by the flux-to-shielding area ratio. For visual comfort, avoid high lumen output unless Squero is installed in a high ceiling application. Spacing criteria: 1.2 (longitudinal) x 1.1 (lateral).



Blank (BLA)

Blank covers provide spacing – functional or rhythmic – in the direct component of a Squero Combination luminaire. Covers are sized according to the Combination design, finished to match the luminaire housing, and snap into the aperture.



LIGHT SOURCE

Static white

Custom linear array of high-flux LEDs mounted onto aluminum-backed circuitry with quick-connect wiring to facilitate service and optimize thermal management. Available in 2700K, 3000K, 3500K, 4000K, and 5000K with a minimum 80+ CRI and an option for 90+ CRI with elevated R9 value. Color consistency maintained to within 3 SDCM. All LEDs have been tested in accordance with IESNA LM-80-08 and the results have shown L80 lumen maintenance greater than 60,000 hours. Absolute product photometry is measured and presented in accordance with IESNA LM-79, unless otherwise indicated.

BIOS

BIOS SkyBlue™ Technology is designed to provide the specific circadian stimulus to improve overall sleep quality, recovery during the night, and overall feelings of well-being.

The non-visual light signals that stimulate our circadian system have peak intensity in the "sky blue" region. As the diagram below illustrates, BIOS SkyBlue technology shifts the peak LED spectral intensity (490 nm) to align better with the peak response of circadian stimulus. Also note the enhanced deep-red (near 660 nm) spectrum.

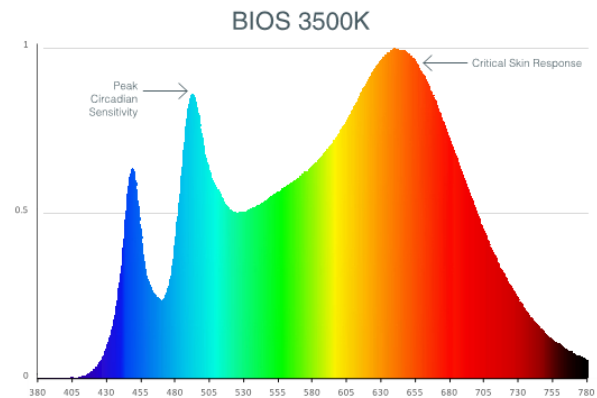

Three BIOS solutions are offered: BIOS Biological Static (BIOSST), BIOS Biological Dynamic (BIOSDY), and BIOS Biological Tunable (BIOSTU). See page 7 for details.

SQUERO



RECESSED

STATIC WHITE, BIOS

LUMINAIRE LENGTH

Squero is made up of standard 2' to 12' sections that may be joined together to create longer continuous run lengths. Exact run lengths must be noted in the product code. The minimum individual section available is 2'.

All individual sections are joined together onsite using the joiner kits provided. Lumenwerx offers joiner kits that are extremely simple to work with in the field and result in a fixture that appears virtually seamless with no light leak at any connection.

ELECTRICAL

Factory-set, adjustable output current LED driver with universal (120-277 VAC) input. Dimmable from 100% to 1% with 0-10V dimming control. Rated life (90% survivorship) of 50,000 hours at 50°C max. ambient (and 70°C max. case) temperature. At maximum driver load: Efficiency > 84%, PF > 0.9, THD < 20%. Other specifiable options include Lutron Hi-Lume 1% Eco, eldoLED 1% ECOdrive 0-10V, eldoLED 0.1% SOLOdrive 0-10V, ELV, TRIAC, and DALI protocol drivers. All of our standard 0-10V drivers are NEMA 410 compliant.

PoE

Depending on the PoE manufacturer selected, Lumenwerx will install the node in factory as either integral to the luminaire or as a remote module. Factory programming of the PoE node may or may not enable the following functionalities: lumen package, DUO (tunable white), QUADRO (RGBW), emergency battery backup, and sensor integration. These must be addressed and evaluated on a case-by-case basis.

ELECTRICAL SECTION OPTIONS

Electrical section options are available for fixtures specified as multi circuit (#MC). With MC, specify the total number of circuits (#), including any circuits required for optional electrical sections. A drawing is required to specify the layout. Please consult factory for custom configurations.

Electrical sections

Options include emergency-powered (#EC##), night light (#NL##), daylight (#DL##), and generator transfer device (#GTD##) sections. Specify the quantity (#), as well as the section length in inches (##).

Example 1: A 32' Direct fixture with two 8' emergency-powered sections on a second circuit.

Code: 2MC-2EC96

Example 2: A 24' Direct fixture with one 4' generator transfer device section.

Code: 1MC-1GTD48

Battery

Each emergency battery (#EMB) powers a 4' section. All batteries will be on the same circuit. Specify the number of batteries (#) required.

Factory installed long life, high temperature, maintenance-free Lithium-Ion battery pack with self-test functionality, test switch and charge indicator. Minimum of 90 minutes operation, up to 1000 lumens per 4' (25°C) emergency lighting output and recharge time of 24 hours.

MOUNTING

Recessed fixtures can be mounted into exposed or concealed T-bar or tegular ceiling, as well as in ceilings with trim, trimless, or mud flange options.

FINISH

Interior: 95%, reflective matte powder coated white paint

Exterior: Matte white, matte black, or aluminum powder coating. Custom finishes are also available.

CONTROLS

Lumenwerx offers several options for integrating occupancy and daylight harvesting controls in our luminaires.

For latest information on sensors, click [here](#).



Standalone controls

An integrated standalone sensor controls the luminaire in which it is installed. Depending on the length, more than one sensor may be necessary and may control the entire luminaire, or just a section of it. These controls operate independently. Unless otherwise agreed, sensor location, blank size, and functionality of the sensor within the luminaire are selected by Lumenwerx. See client drawings for details.

Three types are available:

OMS: An integral Passive InfraRed (PIR) sensor turns luminaires on and off automatically with field-adjustable time out period. No wall control is used. Coverage pattern for large motion has a 12' diameter with the sensor mounted 8' above the floor; for small motion, the pattern has an 8' diameter. Typically, one sensor is required for every 10' of a continuous luminaire run.

ODS: An integral, daylight harvesting sensor with closed-loop operation dims the luminaire in which it is installed in order to compensate for available daylight. The sensor measures the combination of daylight and luminaire light reflected from horizontal surfaces below the luminaire. Initial onsite calibration is required via the use of provided remote control.

OCS: Both an occupancy and a daylight sensor are installed in the luminaire.

SQUERO

RECESSED

STATIC WHITE, BIOS



Connected controls

With connected controls, sensors or nodes installed in the luminaire form part of a larger control system infrastructure from manufacturers such as: Lutron, Encelium, Cooper Wavelinx, Acuity nLight, Casambi, Legrand, and others. These connected controls allow for a scalable system providing features like occupancy and daylight control, manual control, scheduling and configuration of various zones and scenes. Energy reporting and system monitoring are also possible. Specific capabilities depend on the control system being used.

Lumenwerx installs the components (sensors, nodes, power packs, etc) which may be supplied to us by a third party, or procured directly by Lumenwerx, depending on the control system manufacturer.

Lumenwerx is solely responsible for the installation of specified components; the controls manufacturer is responsible for performance of the control system.

To indicate a Lumenwerx luminaire with connected controls, identify the specific onsite control system to be integrated into the luminaires using the ordering code. Due to the diversity of components, you must contact factory to assure complete compatibility with intended control system and to fully specify the luminaire.

Complete control specifications, sensor/node/power pack layout, and narrative for the control system are required for Lumenwerx to create shop drawings and submittals.

INTEGRATED TRACK

The integrated track is available with single units and continuous runs, with or without sections of integrated LED. Two options are available: one supplied and installed by Lumenwerx, and the other by others and installed by Lumenwerx.

Detailed specifications of the track system must be supplied. Consult factory for details.

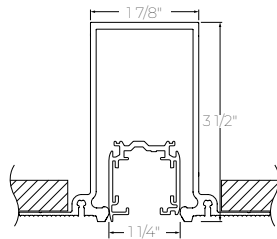
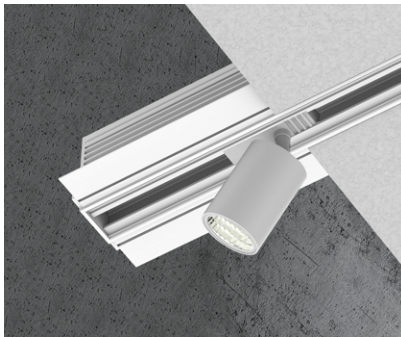

ADJUSTABLE ACCENT MODULE

The Adjustable Accent Module (AAM) features a $\varnothing 1\ 9/16$ " x $3\ 1/4$ " cylinder that rotates 360° and tilts 90° . The LED light source is coupled with TIR optics to provide beam angles of 21° , 30° , and 36° while producing up to 600 lumens. LED light source CCT options are 2700K, 3000K, 3500K, 4000K, and 5000K, available in either 80+ CRI or 90+ CRI.

The AAM module can be selected in either a white or black finish and a honeycomb louver accessory is also available. The AAM driver is mounted above the cylinder, inside the SQUERO housing and accepts universal input voltage (120-277 VAC) while providing 0-10V dimming control.

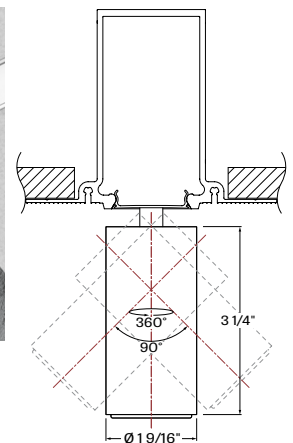
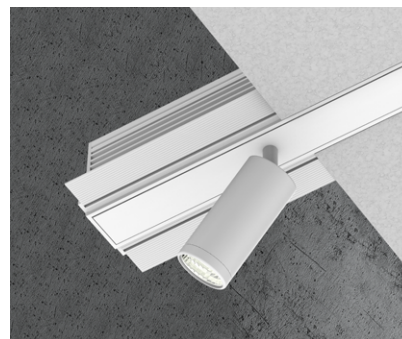

MICRO SPOT MODULE

The Micro Spot is a $\varnothing 7/8$ " x $1\ 5/16$ " adjustable spotlight that extends, retracts, rotates 360° , and tilts 90° . Its LED light source is coupled with a TIR refractor to provide beam angles of 25° , 35° , and 50° , while producing up to 400 lumens. LED light source CCT options are 2700K, 3000K, 3500K, 4000K, and 5000K, available in either 80+ CRI or 90+ CRI. The Micro Spot is offered in a white or black finish. The Micro Spot driver is mounted within the luminaire housing and accepts universal input voltage (120-277 VAC) with 0-10V dimming control.

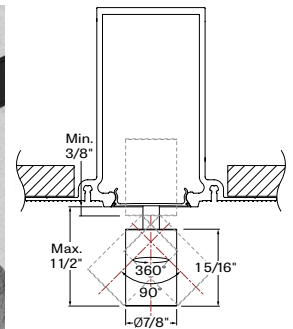
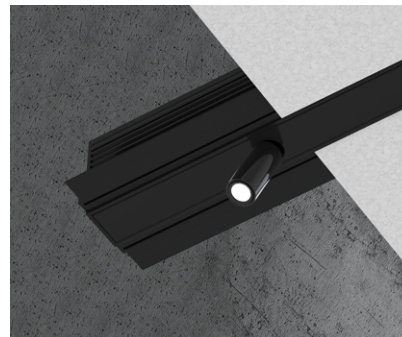

SQUERO

RECESSED

STATIC WHITE, BIOS



CONSTRUCTION

Housing: Extruded aluminum, up to 90% recycled content

Interior brackets: Die-formed cold rolled steel sheet

Joining system: Die-cast aluminum

Louvers: Injection molded optical grade polycarbonate, up to 95% reflective

Recessed flanges: Extruded aluminum, up to 90% recycled content

End plate: Die-formed cold rolled steel sheet

WEIGHT

2': 6.63 lbs - 3 kg

4': 12.35 lbs - 5.60 kg

6': 18.62 lbs - 8.45 kg

8': 24.34 lbs - 11.04 kg

CERTIFICATIONS

ETL: Rated for indoor dry/damp locations. Conforms to UL Standard 1598 and certified to CAN/CSA Standard C22.2 No. 250.0.

Declare: [LBC Red List Approved](#)

WARRANTY

Lumenwerx provides a five-year limited warranty on electrical and mechanical performance of the luminaires, including the LED boards, drivers, and auxiliary electronics. Lumenwerx will repair or replace defective luminaires or components at our discretion, provided they have been installed and operated in accordance with our specifications. Other limitations apply, please refer to the full warranty on our website.