

# UBIK COMBINATION

RECESSED / RECESSED PATTERN

STATIC WHITE, BIOS



## DESCRIPTION

Sleek square form meets superb function in Ubik, a lighting family designed to provide a multitude of creative options. With Ubik Combination Recessed luminaire, you can combine different optics and create patterns with corners to further enhance your lighting design. These compact 2" wide recessed fixtures are offered with HLO, parabolic louver and wall wash optics for direct illumination.

**SENSORS**  
For latest information on sensors, click [here](#).



Up to 145 lm/W performance



# UBIK COMBINATION

RECESSED / RECESSED PATTERN

STATIC WHITE, BIOS



## OPTICS

### Parabolic Louver

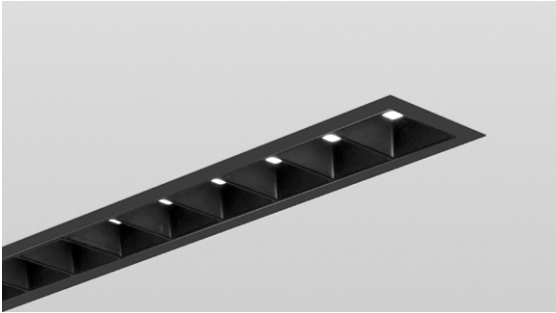

Matte White



Matte Silver



Matte Black

### High-Efficiency Lambertian Optic

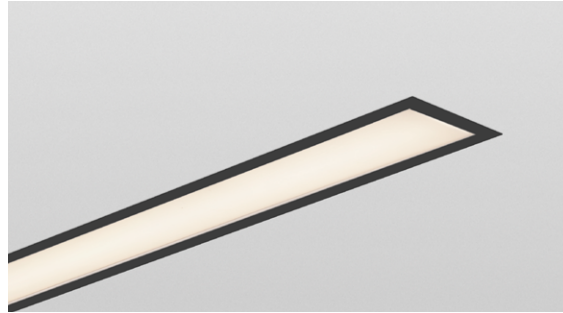

### Wall Wash Optic

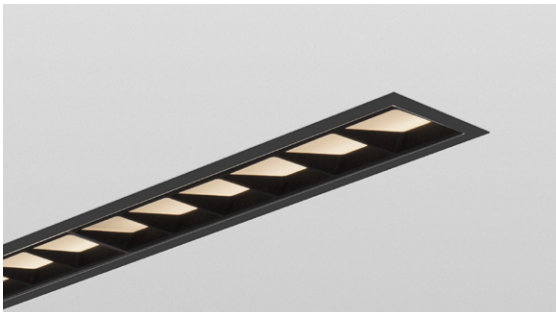

Matte White



Matte Silver



Matte Black

# UBIK COMBINATION

RECESSED / RECESSED PATTERN

STATIC WHITE, BIOS



Project: \_\_\_\_\_

Type: \_\_\_\_\_

## UBIK COMBINATION

A drawing of your combination is required - anything from a line drawing to an architectural drawing.

LUMINAIRE ID <sup>1</sup>	DISTRIBUTION	TOTAL LUMINAIRE LENGTH <sup>2</sup>	DIRECT OPTICS <sup>4,5</sup> Specify the total length for each required optic	
<b>UBICOMR</b>	<b>D</b>			
<b>UBICOMR</b> - Ubik Combination Recessed  <sup>1</sup> To specify a Ubik Combination Pattern fixture, see page 4.	<b>D</b> - Direct	<b>#FT#IN</b> <sup>3</sup> - Specify the total nominal length (#) in 1' and/or 1" increments  <b>Standard nominal lengths:</b> Single units: 3' to 12' Continuous runs: lengths over 12'  <sup>2</sup> Total luminaire length should equal the sum of all the direct optic lengths. <sup>3</sup> Minimum fixture length is 3'.	<b>MWPL</b> <sup>6</sup> - Matte White Parabolic Louver <b>MSPL</b> <sup>6</sup> - Matte Silver Parabolic Louver <b>MBPL</b> <sup>6</sup> - Matte Black Parabolic Louver <b>HLO</b> - High-Efficiency Lambertian Optic <b>WWW</b> <sup>7</sup> - Wall Wash White Optic <b>WWS</b> <sup>7</sup> - Wall Wash Silver Optic <b>WWB</b> <sup>7</sup> - Wall Wash Black Optic <b>BLAW</b> - Blank White <b>BLAS</b> - Blank Silver <b>BLAB</b> - Blank Black	<b>FT</b> <b>IN</b> <b>FT</b> <b>IN</b> <b>FT</b> <b>IN</b> <b>FT</b> <b>IN</b> <b>FT</b> <b>IN</b> <b>FT</b> <b>IN</b> <b>FT</b> <b>IN</b> <b>FT</b> <b>IN</b> <b>FT</b> <b>IN</b>
<sup>4</sup> Specify louvers/optics in 6" increments, and blanks in 1" increments. <sup>5</sup> If 3 optic types are selected, the minimum total length per louver/optic must be 2'. <sup>6</sup> Not available with BIOSTU. <sup>7</sup> Maximum length for a continuous section of wall wash is 8'.				

LIGHT SOURCE	CRI	LUMEN PACKAGE	COLOR TEMP.	VOLTAGE
<b>SW</b> - Static white  <b>BIOSST</b> <sup>8</sup> - BIOS Biological Static <b>BIOSDY</b> <sup>8</sup> - BIOS Biological Dynamic <b>BIOSTU</b> <sup>8</sup> - BIOS Biological Tunable  <sup>8</sup> See page 9 for details.	<b>80CRI</b> - 80 CRI <b>90CRI</b> <sup>9</sup> - 90 CRI  <sup>9</sup> Not available with BIOS.	<b>350LMF</b> - Eco low output 350 lm/ft <b>500LMF</b> - Low output 500 lm/ft <b>750LMF</b> <sup>10</sup> - Medium output 750 lm/ft <b>1000LMF</b> <sup>10,11</sup> - High output 1000 lm/ft <b>1200LMF</b> <sup>10,11</sup> - Ultra high output 1200 lm/ft  <sup>10</sup> Not available with BIOS. <sup>11</sup> Available for non-IC applications only.	<b>27K</b> <sup>12</sup> - 2700K <b>30K</b> - 3000K <b>35K</b> - 3500K <b>40K</b> - 4000K <b>50K</b> <sup>12</sup> - 5000K  <sup>12</sup> Not available with BIOS.	<b>120V</b> - 120V <b>277V</b> - 277V <b>UNV</b> - 120V-277V <b>347V</b> <sup>13</sup> - 347V  <sup>13</sup> Available with D1 driver only.

DRIVER <sup>14</sup>	ELECTRICAL	ELECTRICAL SECTIONS (optional) <sup>19,20</sup>
<b>D1</b> - 1% 0-10V <b>DA</b> <sup>15</sup> - DALI <b>LDE1</b> <sup>15</sup> - Lutron Hi-Lume 1% Eco <b>ELD1</b> - eldoLED 1% ECOdrive 0-10V <b>ELDO</b> - eldoLED 0.1% SOLOdrive 0-10V  <sup>14</sup> PoE (Power-over-Ethernet) compatible. Consult factory for details. <sup>15</sup> On-site commissioning is required.	<b>1C</b> - 1 circuit <b>#MC</b> <sup>16</sup> - Multi circuit <b>EC</b> - Emergency-powered fixture <b>NL</b> - Night light fixture <b>DL</b> - Daylight fixture <b>GTD</b> <sup>17,18</sup> - Generator transfer device fixture  <sup>16</sup> Specify total number of circuits (#), including any required for electrical section options. Provide drawing or layout specifications. Minimum 4' section per circuit. <sup>17</sup> Minimum 4' fixture. <sup>18</sup> Not available with 347V.	<b>#EC##</b> <sup>21</sup> - Emergency-powered section <b>#NL##</b> <sup>21</sup> - Night light section <b>#DL##</b> <sup>21</sup> - Daylight section <b>#GTD##</b> <sup>21,22,23</sup> - Generator transfer device section <b>#EMB</b> <sup>23,24</sup> - Emergency battery <b>NA</b> - None  <sup>19</sup> Specify with multi circuit (#MC) electrical option only. <sup>20</sup> Provide drawing or layout specifications. Consult factory for other configurations. Default section length is 4'. <sup>21</sup> Specify quantity (#), and section length in inches (##). <sup>22</sup> Minimum 4' section. <sup>23</sup> Not available with 347V. <sup>24</sup> Specify quantity (#). All batteries will be on the same circuit. Each battery powers a 4' section.

MOUNTING <sup>25</sup>	FINISH	CONTROL <sup>27</sup>	OPTIONS <sup>33</sup>
<b>TG9</b> - Tegular 9/16" <b>TG15</b> - Tegular 15/16" <b>TB9</b> - T-bar 9/16" <b>TB15</b> - T-bar 15/16" <b>ST</b> - Screw slot T-bar <b>DTR</b> - Drywall trim <b>DTL</b> - Drywall trimless <b>DMF</b> - Drywall mud flange  <b>MFM</b> <sup>26</sup> - Multiple flange mounting  <sup>25</sup> Transition mounting options also available (e.g. Recessed to Pendant/Surface), consult factory for details. <sup>26</sup> See page 6 for details.	<b>W</b> - Matte white <b>AL</b> - Aluminum <b>B</b> - Matte black <b>CF#</b> - Custom finish, specify RAL#	<b>STANDALONE CONTROLS</b> <sup>28,29</sup> Specify the quantity (#) of sensors per fixture. <b>#OMS</b> <sup>30</sup> - Onboard Occupancy <b>#OMS##</b> <sup>31</sup> - Onboard Occupancy with bi-level dimming <b>#ODS</b> - Onboard Daylight <b>#OCS</b> - Onboard Occupancy & Daylight  <b>CONNECTED CONTROLS</b> <sup>32</sup> <b>LU</b> - Lutron <b>AWNR</b> - Lutron Athena Wireless Node RF Only <b>AWNS</b> - Lutron Athena Wireless Node Sensor <b>EN</b> - Enlighted <b>ENC</b> - Encelium <b>WL</b> - Cooper Wavelinx <b>AN</b> - Acuity nLight <b>CA</b> - Casambi <b>LG</b> - Legrand  <b>NA</b> - None  <sup>27</sup> Standalone and connected control options cannot be combined. <sup>28</sup> Available with D1 driver and 1 circuit options only. <sup>29</sup> Minimum 4' per zone. Provide control zone length. <sup>30</sup> Fixture turns off when no occupancy. <sup>31</sup> Fixture dims to specified light level % (##). <sup>32</sup> Consult factory for connected controls.	<b>FUI20</b> - Fuse 120V <b>FU277</b> - Fuse 277V <b>FWC</b> - Flexible whip cable (6' std) <b>CP</b> - Chicago Plenum <b>NA</b> - None  <sup>33</sup> Separate codes with a "+" if more than one is specified.



# UBIK COMBINATION

RECESSED / RECESSED PATTERN

STATIC WHITE, BIOS



Project: \_\_\_\_\_

Type: \_\_\_\_\_

## UBIK COMBINATION PATTERN

A drawing of your combination pattern is required - anything from a line drawing to an architectural drawing.

LUMINAIRE ID	DISTRIBUTION	TOTAL PATTERN LENGTH <sup>1</sup>	DIRECT OPTICS <sup>3,4</sup>
			Specify the total length for each required optic, including the corner lengths
<b>UBICOMRPAT</b>	<b>D</b>		
<b>UBICOMRPAT</b> - Ubik Combination Recessed Pattern	<b>D</b> - Direct	<b>##FT##IN(##X##FT##IN-##X##FT##IN-...)</b> <sup>2</sup> - ##FT##IN: total nominal length of pattern in feet and/or inches #X: quantity of each section #FT##IN: nominal length of each section in feet and/or inches  Continuous runs: lengths over 12'  <sup>1</sup> Total pattern length should equal the sum of all the direct optic lengths. <sup>2</sup> Minimum fixture length is 3'.	<b>MWPL</b> <sup>5</sup> - Matte White Parabolic Louver <b>FT IN</b> <b>MSPL</b> <sup>5</sup> - Matte Silver Parabolic Louver <b>FT IN</b> <b>MBPL</b> <sup>5</sup> - Matte Black Parabolic Louver <b>FT IN</b> <b>HLO</b> - High-Efficiency Lambertian Optic <b>FT IN</b> <b>WWW</b> <sup>6</sup> - Wall Wash White Optic <b>FT IN</b> <b>WWS</b> <sup>6</sup> - Wall Wash Silver Optic <b>FT IN</b> <b>WWB</b> <sup>6</sup> - Wall Wash Black Optic <b>FT IN</b> <b>BLAW</b> - Blank White <b>FT IN</b> <b>BLAS</b> - Blank Silver <b>FT IN</b> <b>BLAB</b> - Blank Black <b>FT IN</b>  <sup>3</sup> Specify louvers/optics in 6" increments, and blanks in 1" increments. <sup>4</sup> If 3 optic types are selected, the minimum total length per louver/optic must be 2'. <sup>5</sup> Not available with BIOSTU. <sup>6</sup> Maximum length for a continuous section of wall wash is 8'.

LIGHT SOURCE	CRI	LUMEN PACKAGE	COLOR TEMP.	CORNER TYPE <sup>12</sup>
<b>SW</b> - Static white  <b>BIOSS7</b> <sup>7</sup> - BIOS Biological Static <b>BIOSDY</b> <sup>7</sup> - BIOS Biological Dynamic <b>BIOSTU</b> <sup>7</sup> - BIOS Biological Tunable  <sup>7</sup> See page 9 for details.	<b>80CRI</b> - 80 CRI <b>90CRI</b> <sup>8</sup> - 90 CRI  <sup>8</sup> Not available with BIOS.	<b>350LMF</b> - Eco low output 350 lm/ft <b>500LMF</b> - Low output 500 lm/ft <b>750LMF</b> <sup>9</sup> - Medium output 750 lm/ft <b>1000LMF</b> <sup>9,10</sup> - High output 1000 lm/ft <b>1200LMF</b> <sup>9,10</sup> - Ultra high output 1200 lm/ft  <sup>9</sup> Not available with BIOS. <sup>10</sup> Available for non-IC applications only.	<b>27K</b> <sup>11</sup> - 2700K <b>30K</b> - 3000K <b>35K</b> - 3500K <b>40K</b> - 4000K <b>50K</b> <sup>11</sup> - 5000K  <sup>11</sup> Not available with BIOS.	<b>#LEV2C(A##)</b> - 2-way leveled corner <b>#INN2C(A90)</b> <sup>13</sup> - 2-way inner corner <b>#OUT2C(A90)</b> <sup>13</sup> - 2-way outer corner  <sup>12</sup> Specify quantity (#) and angle (A##) for each required corner type. <sup>13</sup> Available with 90° only. Consult factory for other angles. <sup>14</sup> Minimum angle is 45°.

CORNER OPTIC	VOLTAGE	DRIVER <sup>16</sup>	ELECTRICAL	ELECTRICAL SECTIONS (optional) <sup>21,22</sup>
<b>HLO</b> - High-Efficiency Lambertian Optic leveled corner min 2'x2' <b>BLA</b> - Blank leveled corner min 6"x6"  <sup>15</sup> Available with D1 driver only.	<b>120V</b> - 120V <b>277V</b> - 277V <b>UNV</b> - 120V-277V <b>347V</b> <sup>15</sup> - 347V	<b>D1</b> - 1% 0-10V <b>DA</b> <sup>17</sup> - DALI <b>LDE1</b> <sup>17</sup> - Lutron Hi-Lume 1% Eco <b>ELD1</b> - eldoLED 1% ECOdrive 0-10V <b>ELDO</b> - eldoLED 0.1% SOLOdrive 0-10V  <sup>16</sup> PoE (Power-over-Ethernet) compatible. Consult factory for details. <sup>17</sup> On-site commissioning is required.	<b>1C</b> - 1 circuit <b>#MC</b> <sup>18</sup> - Multi circuit <b>EC</b> - Emergency-powered fixture <b>NL</b> - Night light fixture <b>DL</b> - Daylight fixture <b>GTD</b> <sup>19,20</sup> - Generator transfer device fixture  <sup>18</sup> Specify total number of circuits (#), including any required for electrical section options. Provide drawing or layout specifications. Minimum 4' section per circuit. <sup>19</sup> Minimum 4' fixture. <sup>20</sup> Not available with 347V.	<b>#EC##</b> <sup>23</sup> - Emergency-powered section <b>#NL##</b> <sup>23</sup> - Night light section <b>#DL##</b> <sup>23</sup> - Daylight section <b>#GTD##</b> <sup>23,24,25</sup> - Generator transfer device section <b>#EMB</b> <sup>25,26</sup> - Emergency battery <b>NA</b> - None  <sup>21</sup> Specify with multi circuit (#MC) electrical option only. <sup>22</sup> Provide drawing or layout specifications. Consult factory for other configurations. Default section length is 4'. <sup>23</sup> Specify quantity (#), and section length in inches (##). <sup>24</sup> Minimum 4' section. <sup>25</sup> Not available with 347V. <sup>26</sup> Specify quantity (#). All batteries will be on the same circuit. Each battery powers a 4' section.

MOUNTING <sup>27</sup>	FINISH	CONTROL <sup>29</sup>	OPTIONS <sup>35</sup>
<b>TG9</b> - Tegular 9/16" <b>TG15</b> - Tegular 15/16" <b>TB9</b> - T-bar 9/16" <b>TB15</b> - T-bar 15/16" <b>ST</b> - Screw slot T-bar <b>DTR</b> - Drywall trim <b>DTL</b> - Drywall trimless <b>DMF</b> - Drywall mud flange  <b>MFM</b> <sup>28</sup> - Multiple flange mounting  <sup>27</sup> Transition mounting options also available (e.g. Recessed to Pendant/Surface), consult factory for details. <sup>28</sup> See page 6 for details.	<b>W</b> - Matte white <b>AL</b> - Aluminum <b>B</b> - Matte black <b>CF#</b> - Custom finish, specify RAL#	<b>STANDALONE CONTROLS</b> <sup>30,31</sup> Specify the quantity (#) of sensors per fixture. <b>#OMS</b> <sup>32</sup> - Onboard Occupancy <b>#OMS##</b> <sup>33</sup> - Onboard Occupancy with bi-level dimming <b>#ODS</b> - Onboard Daylight <b>#OCS</b> - Onboard Occupancy & Daylight  <sup>30</sup> Standalone and connected control options cannot be combined. <sup>31</sup> Available with D1 driver and 1 circuit options only. <sup>32</sup> Minimum 4' per zone. Provide control zone length.	<b>CONNECTED CONTROLS</b> <sup>34</sup> <b>LU</b> - Lutron <b>AWNRR</b> - Lutron Athena Wireless Node RF Only <b>AWNS</b> - Lutron Athena Wireless Node Sensor <b>EN</b> - Enlighted <b>ENC</b> - Encelium <b>WL</b> - Cooper Wavelinx <b>AN</b> - Acuity nLight <b>CA</b> - Casambi <b>LG</b> - Legrand  <b>FUI20</b> - Fuse 120V <b>FU277</b> - Fuse 277V <b>FWC</b> - Flexible whip cable (6' std) <b>CP</b> - Chicago Plenum <b>NA</b> - None  <sup>34</sup> Fixture turns off when no occupancy. <sup>33</sup> Fixture dims to specified light level % (##). <sup>34</sup> Consult factory for connected controls.

# UBIK COMBINATION

RECESSED / RECESSED PATTERN

STATIC WHITE, BIOS



## Dimensions

DRYWALL

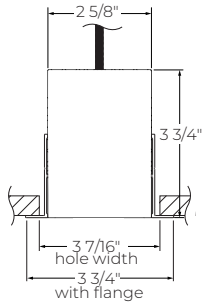

DTR - Drywall trim

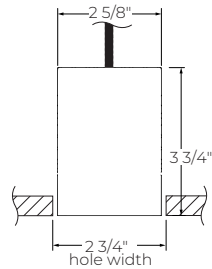

DTL - Drywall trimless

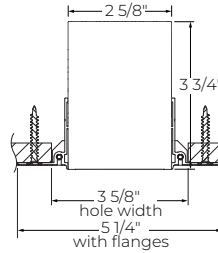

DMF - Drywall mud flange

GRID

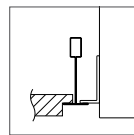
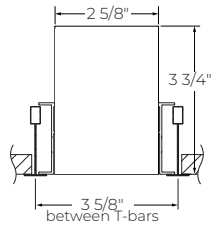

TC9  
Tegralar 9/16"

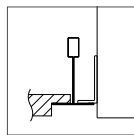

TG15  
Tegralar 15/16"

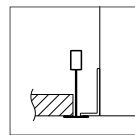

TB9  
T-bar 9/16"

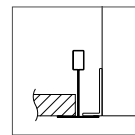

TB15  
T-bar 15/16"

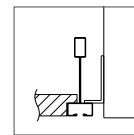

ST  
Screw slot T-bar

# UBIK COMBINATION

RECESSED / RECESSED PATTERN

STATIC WHITE, BIOS



## Multiple Flange Mounting Details

Multiple flange mounting can be specified when a fixture run needs to have a multiple flange recessed mounting detail. A drawing is required to clearly illustrate the application.

CEILING CONDITION EXAMPLES (consult factory for project specific ceiling conditions)

**DRYWALL/GRID**

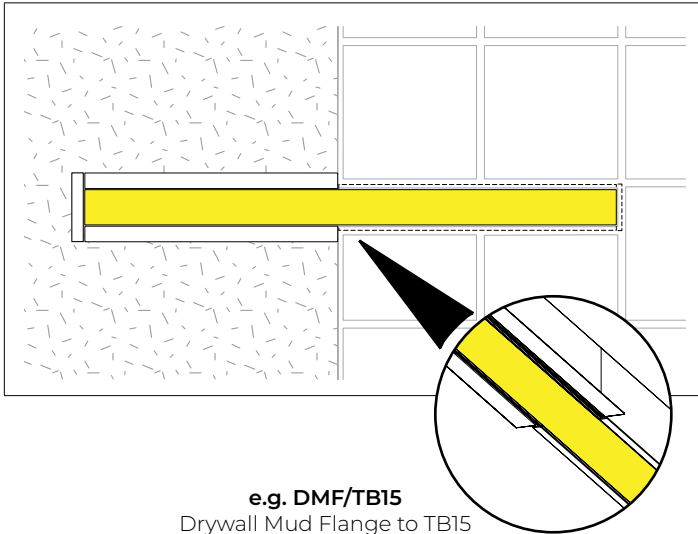

**e.g. DMF/TB15**  
Drywall Mud Flange to TB15

**DRYWALL/WOOD**

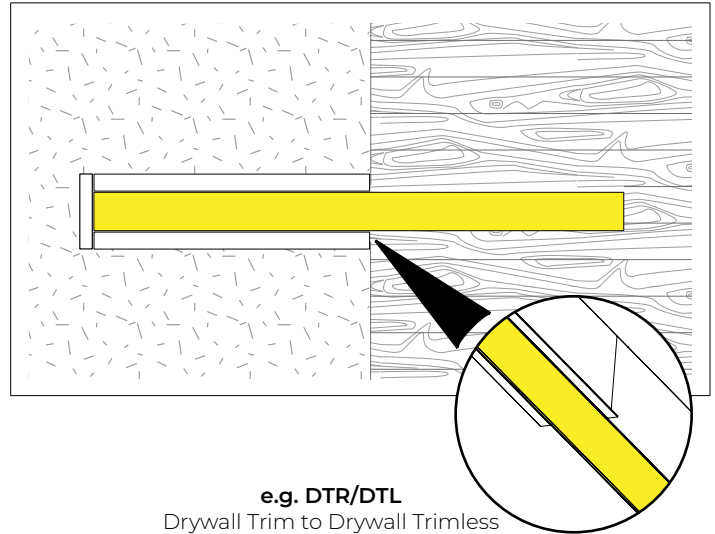

**e.g. DTR/DTL**  
Drywall Trim to Drywall Trimless

**DRYWALL/GRID**

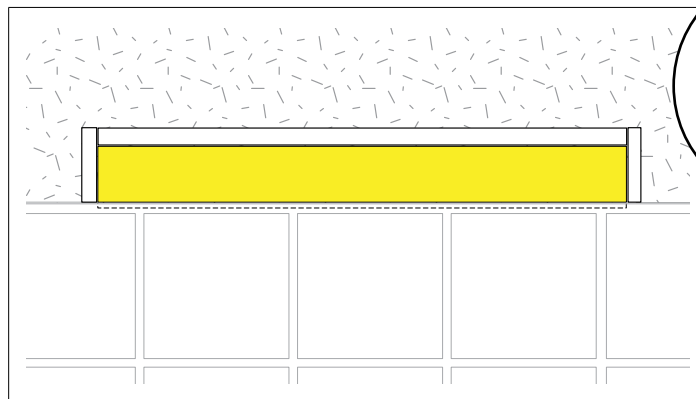

**e.g. 1TG9/3DTR**  
1 long side TG9 and other  
3 sides DTR

All drawings are for illustrative purposes only.

## TRANSITION MOUNTING OPTIONS (consult factory for details)

Mounting condition alters along the run of the fixture.

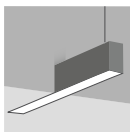

Recessed to Pendant

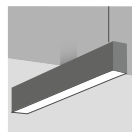

Surface to Pendant

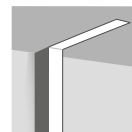

Surface to Recessed in corner

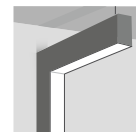

Surface to Pendant in corner

# UBIK COMBINATION

RECESSED / RECESSED PATTERN

STATIC WHITE, BIOS



## Pattern Layout

### LEVELED CORNER

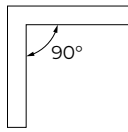

1LEV2C(A90)

### INNER CORNER

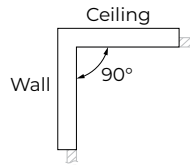

1INN2C(A90)

### OUTER CORNER

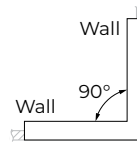

1OUT2C(A90)

2-way

## EXAMPLES

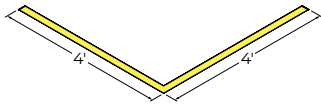

8FT(2X4FT)-1LEV2C(A90)

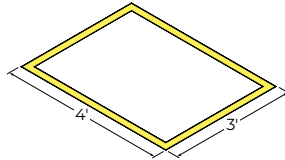

14FT(2X4FT-2X3FT)-4LEV2C(A90)

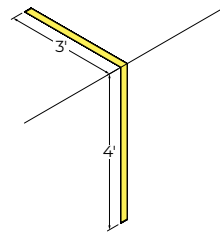

7FT(1X3FT-1X4FT)-1INN2C(A90)

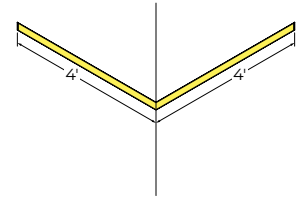

8FT(2X4FT)-1OUT2C(A90)

# UBIK COMBINATION

RECESSED / RECESSED PATTERN

STATIC WHITE, BIOS



## Photometrics

Values calculated based on a 4' fixture at 3500K and 80 CRI for all optics. Watts and lumens per watt may vary based on the type of driver selected.

MWPL

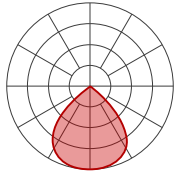

LM/FT	W/FT	LM/W
350	2.6	137
500	3.8	132
750	5.9	127
1000	8.1	123
1200	9.9	121

MSPL

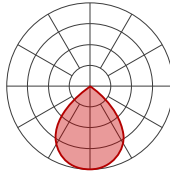

LM/FT	W/FT	LM/W
350	2.8	125
500	4.2	120
750	6.5	115
1000	8.9	112
1200	10.9	110

MBPL

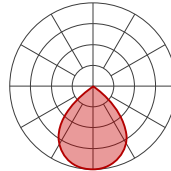

LM/FT	W/FT	LM/W
350	3.2	109
500	4.8	105
750	7.4	101
1000	10.2	98
1200	12.5	96

HLO

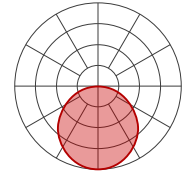

LM/FT	W/FT	LM/W
350	2.4	145
500	3.6	140
750	5.6	135
1000	7.6	131
1200	9.4	128

WWW

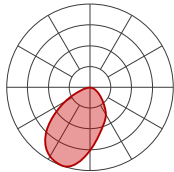

LM/FT	W/FT	LM/W
350	3.4	104
500	5	100
750	8	94
1000	11.2	89
1200	13.8	87

WWS

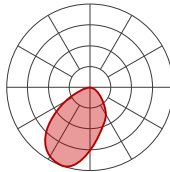

LM/FT	W/FT	LM/W
350	3.6	98
500	5.3	95
750	8.4	89
1000	11.8	85
1200	14.6	82

WWB

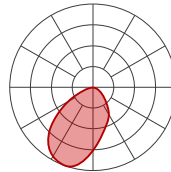

LM/FT	W/FT	LM/W
350	4	87
500	6	83
750	9.6	78
1000	13.5	74
1200	16.9	71

## MULTIPLIER TABLES

Use these tables to get results for different color temperatures and CRI for all photometric tables.

Multiplier - CCT/CRI - MWPL/MSPL/MBPL

CCT	WATTS		LPW	
	80 CRI	90 CRI	80 CRI	90 CRI
2700K	1.04	1.19	0.96	0.84
3000K	1	1.15	1	0.87
3500K	1	1.12	1	0.89
4000K	0.99	1.10	1.01	0.91
5000K	0.94	1.06	1.06	0.94

Multiplier - CCT/CRI - HLO/WWW/WWS/WWB

CCT	WATTS		LPW	
	80 CRI	90 CRI	80 CRI	90 CRI
2700K	1.05	1.27	0.95	0.79
3000K	1.02	1.23	0.98	0.81
3500K	1	1.19	1	0.84
4000K	1	1.19	1	0.84
5000K	0.96	1.12	1.04	0.89

# UBIK COMBINATION

RECESSED / RECESSED PATTERN

STATIC WHITE, BIOS



## BIOS

Three BIOS Circadian LED solutions are offered – Biological Static, Biological Dynamic, and Biological Tunable.

Use the decision tree below to identify when and where to use BIOS Wellness LED Lighting Solutions.

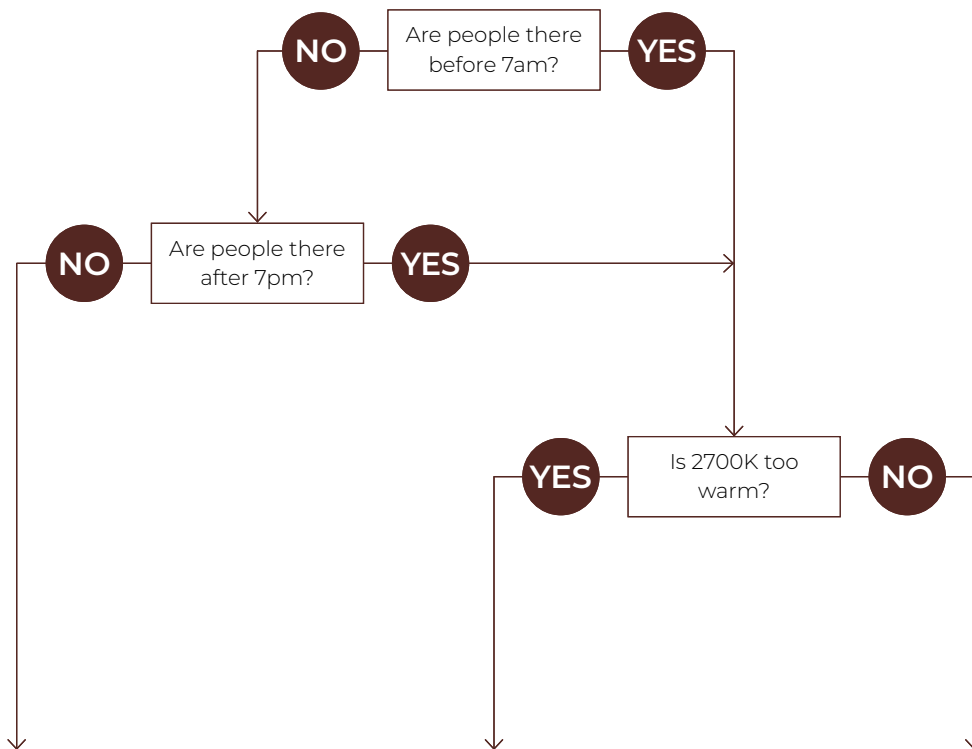

Biological Static BIOSST	Biological Dynamic BIOSDY	Biological Tunable BIOSTU
No CCT change when dimmed	500K shift when dimmed	Dims to 2700K
Daytime solution	Daytime + evening solution	Daytime + evening solution
Spaces in operation during daytime hours, between 7am and 7pm	Spaces in operation overnight, after 7pm and before 7am, and when CCT color shift in the evening is not preferred	Suitable for spaces in operation overnight, after 7pm and before 7am, and where people do not sleep (CCT color shift in the evening is preferred)
E.g. offices, medical/dental offices	E.g. hospitals	E.g. offices, shiftwork

# UBIK COMBINATION

RECESSED / RECESSED PATTERN

STATIC WHITE, BIOS



## Technical Specifications

### OPTICS

#### Parabolic Louvers

Parabolic louvers provide excellent shielding and a pleasing crisp visual texture. The precisely molded louvers consist of 1" deep blades and are 2"x2" in size. The LED array is secured in the direct position, with the light transmitting through a beam-forming lens creating a conical distribution. Three matte finishes are available in black, white and silver, offering a soft appearance, a wide beam spread of up 85-91 degrees, gentle brightness transition at cut-off, and exceptional UGR.



#### High-Efficiency Lambertian Optic (HLO)

The High-Efficiency Lambertian Optic (HLO) shielding of diffusing 0.075" thick acrylic with up to 88% transmission and good source obscuration is combined with matte white side reflectors to create an efficient optical chamber with uniform luminosity. Luminaire brightness is controlled by the flux-to-shielding area ratio. For visual comfort, avoid high lumen output unless Ubik is installed in a high ceiling application.

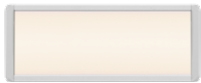

#### Wall Wash Optics

Ubik wall wash is an offset horizontal linear LED array that reflects from a matte white internal side kicking reflector. It then transmits through the beam-forming lens and then softened by a 2" asymmetric louver. The lens is fully illuminated, and the wall wash is only slightly angled to complement the direct optic.



#### Blank (BLA)

Blank sections or covers provide spacing for functions or an unlit transition or unlit corner for Ubik combination or pattern. Blank covers are perfectly sized and finished to match the Ubik housing color and shape and easily snap into the Ubik aperture.

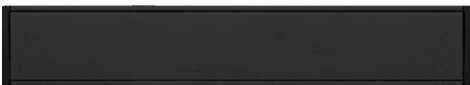

### LIGHT SOURCE

#### Static white

Custom array of mid-flux LEDs are mounted directly to the housing for optimal thermal performance. Available in 2700K, 3000K, 3500K, 4000K, and 5000K with a minimum 80 CRI and an option for 90 CRI with elevated R9 value. Color consistency maintained to within 3 SDCM.

All LEDs have been tested in accordance with IESNA LM-80-08 and the results have shown L80 lumen maintenance greater than 60,000 hours. Absolute product photometry is measured and presented in accordance with IESNA LM-79, unless otherwise indicated.

#### BIOS

BIOS SkyBlue™ Technology is designed to provide the specific circadian stimulus to improve overall sleep quality, recovery during the night, and overall feelings of well-being.

The non-visual light signals that stimulate our circadian system have peak intensity in the "sky blue" region. As the diagram below illustrates, BIOS SkyBlue technology shifts the peak LED spectral intensity (490 nm) to align better with the peak response of circadian stimulus. Also note the enhanced deep-red (near 660 nm) spectrum.

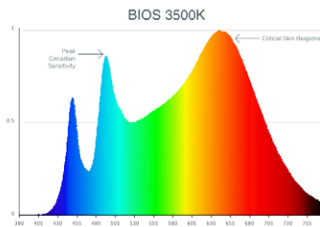

Three BIOS solutions are offered: BIOS Biological Static (BIOSST), BIOS Biological Dynamic (BIOSDY), and BIOS Biological Tunable (BIOSTU). See page 9 for details.

### LUMINAIRE LENGTH

Ubik is made up of standard 3' to 12' sections that may be joined together to create longer continuous run lengths. Exact run lengths must be noted in the product code. The minimum length is 3'. Lengths can be ordered in 6" increments for louvers and optics, and 1" increments for blanks.

All individual sections are joined together onsite using the joiner kits provided. Lumenwerx offers joiner kits that are extremely simple to work with in the field and result in a fixture that appears virtually seamless with no light leak at any connection.

# UBIK COMBINATION

RECESSED / RECESSED PATTERN

STATIC WHITE, BIOS



## WELL BUILDING STANDARD



**WELL for Light:** The WELL building standard focuses on light quality in several features. There are three categories that are fully attributed to the construction and features of a luminaire. In WELL V1, it's Feature 54 Circadian Lighting, Feature 55 Glare Control, and Feature 58 Color Quality. In WELL V2, it's Feature L03 Circadian Lighting, Feature L04 Glare Control, and Feature L07 Electric Light Quality.

This fixture meets Features:

- Feature 54 or L03 when BIOS LED is selected
- Feature 55 or L04 meets WELL glare category (b-c-d)
- Feature 58 or L07 when 90CRI is selected

All LED drivers used at Lumenwerx are deemed to have a low risk level of flicker, of 5% or less below 90Hz operational as defined by IEEE standard 1789-2015 LED.



**WELL for Mind:** This luminaire meets WELL for mind as it is a human centric luminaire offering quality light, excellent color, and smooth optics. If any of these features are incorporated in a luminaire, it can improve the ability to focus, concentrate, and persist longer on a given task. This fixture harmoniously operates in a space to assist the mind.

For more information please contact [well@lumenwerx.com](mailto:well@lumenwerx.com).

## ELECTRICAL

Factory-set, adjustable output current LED driver with universal (120-277 VAC) input. Dimmable from 100% to 1% with 0-10V dimming control. Rated life (90% survivorship) of 50,000 hours at 50°C max. ambient (and 70°C max. case) temperature. At maximum driver load: Efficiency>84%, PF>0.9, THD<20%. Other specifiable options include Lutron Hi-Lume 1% Eco, eldoLED 1% ECOdrive 0-10V, eldoLED 0.1% SOLOdrive 0-10V, and DALI protocol drivers. All of our standard 0-10V drivers are NEMA 410 compliant.

## PoE

Depending on the PoE manufacturer selected, Lumenwerx will install the node in factory as either integral to the luminaire or as a remote module. Factory programming of the PoE node may or may not enable the following functionalities: lumen package, DUO (tunable white), QUADRO (RGBW), emergency battery backup, and sensor integration. These must be addressed and evaluated on a case-by-case basis.

## ELECTRICAL SECTION OPTIONS

Electrical section options are available for fixtures specified as multi circuit (#MC). With MC, specify the total number of circuits (#), including any circuits required for optional electrical sections. A drawing is required to specify the layout. Please consult factory for custom configurations.

### Electrical sections

Options include emergency-powered (#EC##), night light (#NL##), daylight (#DL##), and generator transfer device (#GTD##) sections. Specify the quantity (#), as well as the section length in inches (##).

Example 1: A 32' Direct fixture with two 8' emergency-powered sections on a second circuit.

Code: 2MC-2EC96

Example 2: A 24' Direct fixture with one 4' generator transfer device section.

Code: 1MC-1GTD48

### Battery

Each emergency battery (#EMB) powers a 4' section. All batteries will be on the same circuit. Specify the number of batteries (#) required. Factory installed long life, high temperature, maintenance-free Lithium-Ion battery pack with self-test functionality, test switch and charge indicator. Minimum of 90 minutes operation, up to 1000 lumens per 4' (25°C) emergency lighting output and recharge time of 24 hours.

## MOUNTING

Recessed fixtures can be mounted into exposed or concealed T-bar or regular ceiling, as well as in drywall ceilings with trim, trimless, or mud flange options.

## FINISH

**Interior:** 95%, reflective matte powder coated white paint

**Exterior:** Powder-coat paint in standard white, aluminum, or black. Custom colors are also available.

## CONTROLS

Lumenwerx offers several options for integrating occupancy and daylight harvesting controls in our luminaires.

For latest information on sensors, click [here](#).



# UBIK COMBINATION

RECESSED / RECESSED PATTERN

STATIC WHITE, BIOS



## Standalone controls

An integrated standalone sensor controls the luminaire in which it is installed. Depending on the length, more than one sensor may be necessary and may control the entire luminaire, or just a section of it. These controls operate independently. Unless otherwise agreed, location and functionality of the sensor within the luminaire are selected by Lumenwerx. Three types are available:

**OMS:** An integral Passive InfraRed (PIR) sensor turns luminaires on and off automatically with field-adjustable time out period. No wall control is used. Coverage pattern for large motion has a 12' diameter with the sensor mounted 8' above the floor; for small motion, the pattern has an 8' diameter. Typically, one sensor is required for every 10' of a continuous luminaire run.

**ODS:** An integral, daylight harvesting sensor with closed-loop operation dims the luminaire in which it is installed in order to compensate for available daylight. The sensor measures the combination of daylight and luminaire light reflected from horizontal surfaces below the luminaire. Initial onsite calibration is required via the use of provided remote control.

**OCS:** Both an occupancy and a daylight sensor are installed in the luminaire.

## Connected controls

With connected controls, sensors or nodes installed in the luminaire form part of a larger control system infrastructure from manufacturers such as: Lutron, Enlighted, Encelium, Cooper Wavelinx, Acuity nLight, Casambi, Legrand, and others. These connected controls allow for a scalable system providing features like occupancy and daylight control, manual control, scheduling and configuration of various zones and scenes. Energy reporting and system monitoring are also possible. Specific capabilities depend on the control system being used.

Lumenwerx installs the components (sensors, nodes, power packs, etc) which may be supplied to us by a third party, or procured directly by Lumenwerx, depending on the control system manufacturer.

Lumenwerx is solely responsible for the installation of specified components; the controls manufacturer is responsible for performance of the control system.

To indicate a Lumenwerx luminaire with connected controls, identify the specific onsite control system to be integrated into the luminaires using the ordering code. Due to the diversity of components, you must contact factory to assure complete compatibility with intended control system and to fully specify the luminaire.

Complete control specifications, sensor/node/power pack layout, and narrative for the control system are required for Lumenwerx to create shop drawings and submittals.

## CONSTRUCTION

**Housing:** Extruded aluminum up to 90% recycled content

**Joiner bracket (DTL-DTR):** Cold drawn steel

**Joiner bracket (other):** Galvanised steel

**Louvers:** Injection molded optical grade polycarbonate up to 95% reflective

**HLO lens:** Coextruded PMMA

**Parabolic heatsink:** Extruded aluminum up to 90% recycled content

**HLO/WW heatsink:** Aluminum sheet

**End plate:** Aluminum sheet

## WEIGHT

**4':** 14.2 lbs - 6.4 kg

**6':** 21.3 lbs - 9.7 kg

**8':** 28.4 lbs - 12.9 kg

**12':** 35.5 lbs - 16.1 kg

## CERTIFICATIONS

**ETL:** Rated for indoor dry/damp locations. Conforms to UL Standard 1598 and certified to CAN/CSA Standard C22.2 No. 250.0.

**IC rated:** Suitable for direct contact with insulation

**Chicago Plenum:** City of Chicago Approved (CCEA) when specified with CP option.

## WARRANTY

Lumenwerx provides a five-year limited warranty of electrical and mechanical performance of the luminaires, including the LED boards, drivers, and auxiliary electronics. Lumenwerx will repair or replace defective luminaires or components at our discretion, provided they have been installed and operated in accordance with our specifications. Other limitations apply, please refer to the full warranty on our website.