

# UBIK SEAL

RECESSED  
STATIC WHITE, FULL SPECTRUM

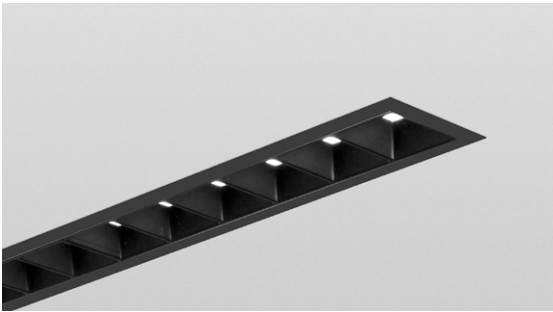

Project: \_\_\_\_\_  
Type: \_\_\_\_\_



Parabolic Louver

## DESCRIPTION

Sleek square form meets superb function in Ubik, a lighting family designed to provide a multitude of creative options. Ubik Seal Recessed is offered with a choice of three parabolic louver colors: matte white, matte black, and matte silver. An additional gasketed clear polycarbonate lens is mounted on top of the louvers for extra protection. Ubik Seal Recessed comes in static white and full spectrum. For Chromawerx SOLA and DUO, consult other spec sheet.

### SENSORS

For latest information on sensors, click [here](#).



IC RATED IP54

Up to 135 lm/W performance

## Order Guide

LUMINAIRE ID	DISTRIBUTION	OPTIC	LIGHT SOURCE <sup>2</sup>	CRI
<b>UBISEALR</b>	<b>D</b>			
<b>UBISEALR</b> <sup>1</sup> - Ubik Seal Recessed <small><sup>1</sup>IP54 rated gasketed construction with an additional clear polycarbonate lens.</small>	<b>D</b> - Direct	<b>MWPL</b> - Matte White Parabolic Louver <b>MSPL</b> - Matte Silver Parabolic Louver <b>MBPL</b> - Matte Black Parabolic Louver	<b>SW</b> - Static white <b>FS</b> - Full spectrum static white <small><sup>2</sup>Chromawerx SOLA and DUO also available. Consult other spec sheet.</small>	<b>80CRI</b> <sup>3</sup> - 80+ CRI <b>90CRI</b> <sup>3</sup> - 90+ CRI <b>95CRI</b> <sup>4</sup> - 95+ CRI <small><sup>3</sup>Not available with full spectrum. <sup>4</sup>Only available with full spectrum.</small>

LUMEN PACKAGE	COLOR TEMP.	LUMINAIRE LENGTH	VOLTAGE	DRIVER <sup>8</sup>
<b>350LMF</b> - Eco low output 350 lm/ft <b>500LMF</b> - Low output 500 lm/ft <b>750LMF</b> - Medium output 750 lm/ft <b>1000LMF</b> <sup>5,6</sup> - High output 1000 lm/ft <b>1200LMF</b> <sup>5,6</sup> - Ultra high output 1200 lm/ft <small><sup>5</sup>Not available with full spectrum. <sup>6</sup>Available for non-IC applications only.</small>	<b>27K</b> - 2700K <b>30K</b> - 3000K <b>35K</b> - 3500K <b>40K</b> - 4000K <b>50K</b> - 5000K	<b>#FT</b> - Specify nominal length (#) in <sup>1</sup> increments  <b>Standard nominal lengths:</b> Single units: 3' to 12' Continuous runs: lengths over 12'	<b>120V</b> - 120V <b>277V</b> - 277V <b>UNV</b> - 120V-277V <b>347V</b> <sup>7</sup> - 347V <small><sup>7</sup>Available with D1 driver only.</small>	<b>D1</b> - 1% 0-10V <b>DA</b> <sup>9</sup> - DALI <b>LDE1</b> <sup>9</sup> - Lutron Hi-lume 1% Eco <b>ELD1</b> - eldoLED 1% ECOdrive 0-10V <b>ELDO</b> - eldoLED 0.1% SOLOdrive 0-10V <small><sup>8</sup>PoE (Power-over-Ethernet) compatible. Consult factory for details. <sup>9</sup>On-site commissioning is required.</small>

ELECTRICAL	ELECTRICAL SECTIONS (optional) <sup>13,14</sup>	MOUNTING	FINISH	OPTIONS <sup>19</sup>
<b>TC</b> - 1 circuit <b>#MC</b> <sup>10</sup> - Multi circuit <b>EC</b> - Emergency powered fixture <b>NL</b> - Night light fixture <b>DL</b> - Daylight fixture <b>GTD</b> <sup>11,12</sup> - Generator transfer device <small><sup>10</sup>Specify total number of circuits (#), including any circuits required for electrical section options. Provide drawing or layout specifications. Minimum 4' section per circuit. <sup>11</sup>Minimum 4' fixture. <sup>12</sup>Not available with 347V.</small>	<b>#EC##</b> <sup>15</sup> - Emergency-powered section <b>#NL##</b> <sup>15</sup> - Night light section <b>#DL##</b> <sup>15</sup> - Daylight section <b>#GTD##</b> <sup>15,16,17</sup> - Generator transfer device section <b>#EMB</b> <sup>17,18</sup> - Emergency powered battery <b>NA</b> - None <small><sup>13</sup>Specify with multi circuit (#MC) electrical option only. <sup>14</sup>Provide drawing or layout specifications. Consult factory for other configurations. Default section length is 4'. <sup>15</sup>Specify quantity (#), and section length in inches (##). <sup>16</sup>Minimum 4' section. <sup>17</sup>Not available with 347V. <sup>18</sup>Specify quantity (#). All batteries will be on the same circuit. Each battery powers a 4' section.</small>	<b>TG9</b> - Tegular 9/16" <b>TG15</b> - Tegular 15/16" <b>TB9</b> - T-bar 9/16" <b>TB15</b> - T-bar 15/16" <b>ST</b> - Screw slot T-bar <b>MTR</b> - Trim <b>MTL</b> - Trimless <b>DMF</b> - Drywall mud flange	<b>W</b> - Matte white <b>AL</b> - Aluminum <b>B</b> - Matte black <b>WA</b> - White antimicrobial Silverwerx <b>CF#</b> - Custom finish, specify RAL#	<b>FUI20</b> - Fuse 120V <b>FU277</b> - Fuse 277V <b>CP</b> - Chicago Plenum <b>GCK</b> - Grid gasket <b>CRF</b> - Corrosion-resistant finish <b>NA</b> - None <small><sup>19</sup>Separate codes with a "+" if more than one is specified.</small>

# UBIK SEAL

RECESSED  
STATIC WHITE, FULL SPECTRUM



## Photometrics

Values calculated based on a 4' fixture at 3500K and 80+ CRI for all optics. Watts and lumens per watt may vary based on the type of driver selected.

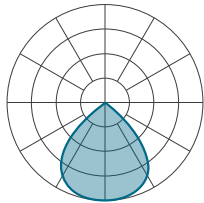

MWPL

LM/FT	W/FT	LM/W
350	2.6	135
500	3.8	132
750	5.9	127
1000	8.1	123
1200	9.9	121

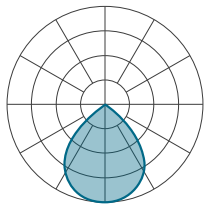

MSPL

LM/FT	W/FT	LM/W
350	2.8	125
500	4.2	120
750	6.5	115
1000	8.9	112
1200	10.9	110

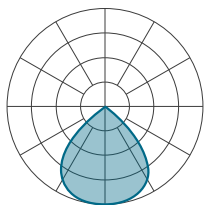

MBPL

LM/FT	W/FT	LM/W
350	3.2	109
500	4.7	105
750	7.4	101
1000	10.2	98
1200	12.5	96

### MULTIPLIER TABLE

Use the table to get results for different color temperatures and CRI for all photometric tables.

Multiplier - CCT/CRI - MWPL/MSPL/MBPL

CCT	WATTS		LPW	
	80+ CRI	90+ CRI	80+ CRI	90+ CRI
2700K	1.04	1.19	0.96	0.84
3000K	1.00	1.15	1.00	0.87
3500K	1.00	1.12	1.00	0.89
4000K	0.99	1.10	1.01	0.91
5000K	0.94	1.06	1.06	0.94

## Dimensions

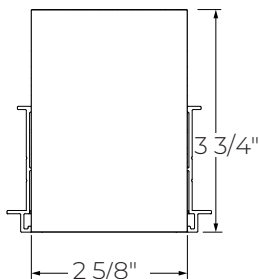

# UBIK SEAL

RECESSED

STATIC WHITE, FULL SPECTRUM



## Technical Specifications

### OPTICS

#### Parabolic Louvers

Parabolic louvers provide excellent shielding and a pleasing crisp visual texture. The precisely molded louvers consist of 1" deep blades and is 2"x2" in size. The LED array is secured in the direct position, with the light transmitting through a beam-forming lens creating a conical distribution. Three matte finishes are available in black, white and silver, offering a soft appearance, a wide beam spread of up 85-91 degrees, gentle brightness transition at cut-off, and exceptional UGR.



### LIGHT SOURCE

#### Static white

Custom array of mid-flux LEDs are mounted directly to the housing for optimal thermal performance. Available in 2700K, 3000K, 3500K, 4000K and 5000K with a minimum 80+ CRI and an option for 90+ CRI with elevated R9 value. Color consistency maintained to within 3 SDCM. LEDs operated at reduced drive current to optimize efficacy and lumen maintenance. All LEDs have been tested in accordance with IESNA LM-80-08 and the results have shown L80 lumen maintenance greater than 60,000 hours. Absolute product photometry is measured and presented in accordance with IESNA LM-79, unless otherwise indicated.

#### Full spectrum static white

The full spectrum LED option offers improved color particularly in the cyan region that is beneficial in both healthcare and circadian lighting strategies. The cyan region in full spectrum LED is richer at the 480 nm range.

### WELL BUILDING STANDARD



**WELL for Light:** The WELL building standard focuses on light quality in several features. There are three categories that are fully attributed to the construction and features of a luminaire. In WELL V1, it's Feature 54 Circadian Lighting, Feature 55 Glare Control, and Feature 58 Color Quality. In WELL V2, it's Feature L03 Circadian Lighting, Feature L04 Glare Control, and Feature L07 Electric Light Quality.

This fixture meets Features:

- Feature 54 or L03 when full spectrum is selected
- Feature 55 or L04 meets WELL glare category (b-c-d)
- Feature 58 or L07 when 90+ CRI is selected

All LED drivers used at Lumenwerx are deemed to have a low risk level of flicker, of 5% or less below 90Hz operational as defined by IEEE standard 1789-2015 LED.



**WELL for Mind:** This luminaire meets WELL for mind as it is a human centric luminaire offering quality light, excellent color, and smooth optics. If any of these features are incorporated in a luminaire, it can improve the ability to focus, concentrate, and persist longer on a given task. This fixture harmoniously operates in a space to assist the mind.

For more information please contact [well@lumenwerx.com](mailto:well@lumenwerx.com).

### LUMINAIRE LENGTH

Ubik is made up of standard 3' to 12' sections that may be joined together to create longer continuous run lengths. Exact run lengths must be noted in the product code. The minimum length is 3'. Lengths can be ordered in 1' increments.

All individual sections are joined together onsite using the joiner kits provided. Lumenwerx offers joiner kits that are extremely simple to work with in the field and result in a fixture that appears virtually seamless with no light leak at any connection.

# UBIK SEAL

RECESSED

STATIC WHITE, FULL SPECTRUM



## ELECTRICAL

Factory-set, adjustable output current LED driver with universal (120-277 VAC) input. Dimmable from 100% to 1% with 0-10V dimming control. Rated life (90% survivorship) of 50,000 hours at 50°C max. ambient (and 70°C max. case) temperature. At maximum driver load: Efficiency > 84%, PF > 0.9, THD < 20%. Other specifiable options include Lutron Hi-Lume 1% Eco, eldoLED 1% Ecodrive 0-10V, eldoLED 0.1% SOLOdrive 0-10V, DALI protocol drivers. All of our standard 0-10V drivers are NEMA 410 compliant.

## PoE

Depending on the PoE manufacturer selected, Lumenwerx will install the node in factory as either integral to the luminaire or as a remote module. Factory programming of the PoE node may or may not enable the following functionalities: lumen package, DUO (tunable white), QUADRO (RGBW), emergency battery backup, and sensor integration. These must be addressed and evaluated on a case-by-case basis.

## ELECTRICAL SECTION OPTIONS

Electrical section options are available for fixtures specified as multi circuit (#MC). With MC, specify the total number of circuits (#), including any circuits required for optional electrical sections. A drawing is required to specify the layout. Please consult factory for custom configurations.

## Electrical sections

Options include emergency-powered (#EC##), night light (#NL##), daylight (#DL##), and generator transfer device (#GTD##) sections. Specify the quantity (#), as well as the section length in inches (##).

Example 1: A 32' Direct fixture with two 8' emergency-powered sections on a second circuit.

Code: 2MC-2EC96

Example 2: A 24' Direct fixture with one 4' generator transfer device section.

Code: 1MC-1GTD48

## Battery

Each emergency battery (#EMB) powers a 4' section. All batteries will be on the same circuit. Specify the number of batteries (#) required.

Factory installed long life, high temperature, maintenance-free Lithium-Ion battery pack with self-test functionality, test switch and charge indicator. Minimum of 90 minutes operation, up to 1000 lumens per 4' (25°C) emergency lighting output and recharge time of 24 hours.

## MOUNTING

Recessed fixtures can be mounted into exposed or concealed T-bar or tegular ceiling, as well as in ceilings with trim, trimless, or mud flange options.

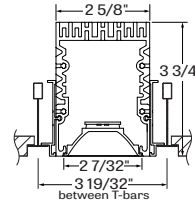

TG9 - Tegular 9/16"

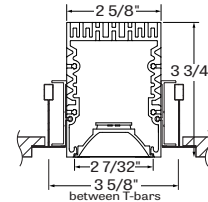

TG15 - Tegular 15/16"

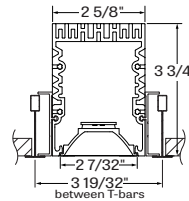

TB9 - T-bar 9/16"

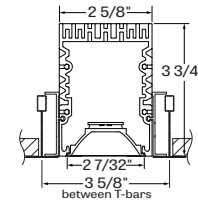

TB15 - T-bar 15/16"

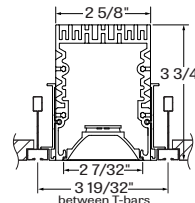

ST - Screw slot T-bar

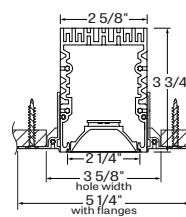

DMF - Drywall mud flange

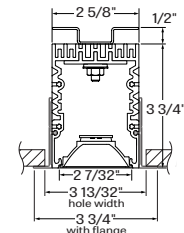

MTR - Trim

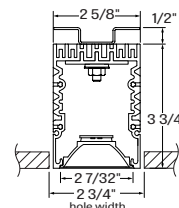

MTL - Trimless

# UBIK SEAL

RECESSED  
STATIC WHITE, FULL SPECTRUM



## CONSTRUCTION

**Housing:** Extruded aluminum, up to 90% recycled content  
**Joiner bracket (MTL-MTR):** Cold drawn steel  
**Joiner bracket (other):** Galvanised steel  
**Louvers:** Injection molded optical grade polycarbonate, up to 95% reflective  
**Parabolic heatsink:** Extruded aluminum, up to 90% recycled content  
**End plate:** Aluminum sheet  
**Gasket:** Closed-cell silicone foam gasket  
**Grid gasket (GGK option):** 1/16" closed-cell silicone foam, assures a better seal between the fixture and the grid

## FINISH

**Interior:** 95%, reflective matte powder coated white paint  
**Exterior:** Powder-coat paint in matte white, matte black or aluminum. Optional antimicrobial finish, as well as custom finishes, also available.

## WEIGHT

**4':** 14.2 lbs - 6.4 kg  
**6':** 21.3 lbs - 9.7 kg  
**8':** 28.4 lbs - 12.9 kg  
**12':** 35.5 lbs - 16.1 kg

## CERTIFICATIONS

**ETL:** IP54-Rated environment options are ETL Wet Listed. Conforms to UL Standard 1598 and certified to CAN/CSA Standard C22.2 No. 250.0. During the installation of Wet Listed fixtures, the contractor is responsible for properly sealing all mounting and electrical connection points.

**IC rated:** Suitable for direct contact with insulation

**Chicago Plenum:** City of Chicago approved (CCEA) when specified with CP option.

## WARRANTY

Lumenwerx provides a five-year limited warranty on electrical and mechanical performance of the luminaires, including the LED boards, drivers, and auxiliary electronics. Lumenwerx will repair or replace defective luminaires or components at our discretion, provided they have been installed and operated in accordance with our specifications. Other limitations apply, please refer to the full warranty on our website.